

## Pressure Switch with Piping Adapter (P)

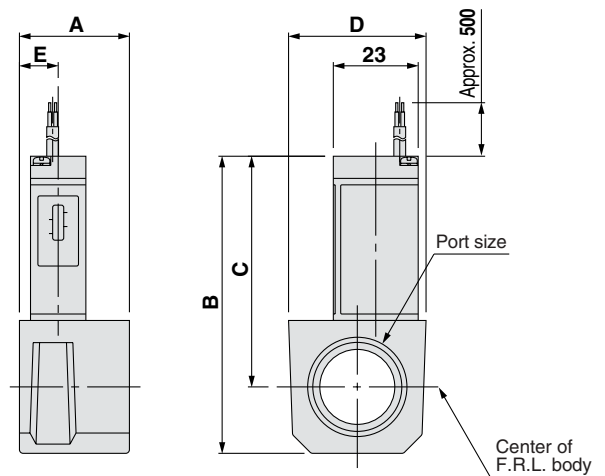
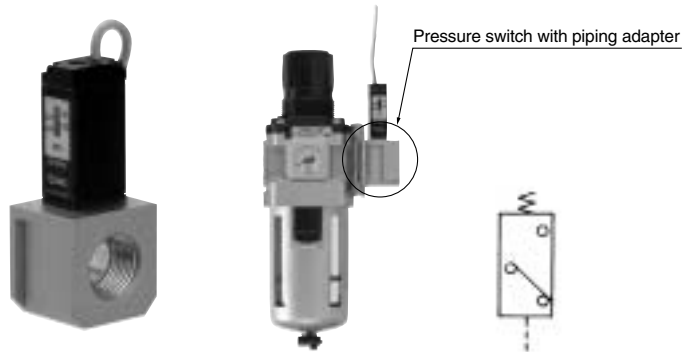

### Specifications

Fluid	Air
Proof pressure	1.0MPa
Maximum operating pressure	0.7MPa
Set pressure range (when OFF)	0.1 to 0.4MPa
Differential	0.08MPa
Ambient and fluid temperature	-5 to 60°C (with no freezing)

### Switch characteristics

Contact point configuration	1a
Maximum contact point capacity	2VA(AC), 2W(DC)
Operating voltage: AC, DC	100V or less
Max. operating current	12V to 24V AC, DC: 50mA
	48V AC, DC: 40mA
	100V AC, DC: 20mA

Model <small>Note 1)</small>	Port size	A	B	C	D	E	Applicable model
IS1000E-20□01	1/8	30	68	57	28	16	AC20□
IS1000E-20□02	1/4						AR20□, AW20□
IS1000E-20□03	3/8						AWM20, AWD20
IS1000E-30□02	1/4	32	74.5	60.5	30	13	AC25□, AC30□
IS1000E-30□03	3/8						AR25□, AR30□, AW30□
IS1000E-30□04	1/2						AWM30, AWD30
IS1000E-40□02	1/4	32	80.5	62.5	37	12.5	AC40□ <small>Note 2)</small>
IS1000E-40□03	3/8						AR40□, AW40□
IS1000E-40□04	1/2						AWM40, AWD40
IS1000E-40□06	3/4						

Note 1) □ in the model numbers indicates a thread type. No indication is necessary for Rc; however, indicate N for NPT, and F for G.

Note 2) A pressure switch cannot be mounted on AC40□-06 and AW40□-06.

\* Separate interfaces are required for modular unit.

\*\* The pressure switch on AC40□-06 and above and AW40□-06 can be mounted by screwing IS1000-01 into the piping adapter E500-□06-X501 or E600-□06-X501 to E600-□06 to 10-X501 (with top-face thread Rc 1/8). Products with a premounted switch are available as a special order. Please contact SMC regarding their availability.

## How to Order

IS1000E-30□03□

Pressure switch with piping adapter

Body size

20	For AC20
30	For AC25, AC30
40	For AC40-02 to 04

Thread type

Nil	Rc
N	NPT
F	G

### Option

X201	Lead wire length: 3m
X202	Regulating pressure range: 0.1 to 0.6MPa
X207	MPa/PSI Dual scale
X215	Lead wire length: 3m; Regulating pressure range: 0.1 to 0.6MPa
X250	Opposite-side mounting (Left-side mounting type)
X251	Lead wire length: 3m; Opposite-side mounting (Left-side mounting type)
X252	Set pressure range: 0.1 to 0.6MPa; Opposite-side mounting (Left-side mounting type)
X253	Lead wire length: 3m; Regulating pressure range: 0.1 to 0.6MPa; Opposite-side mounting (Left-side mounting type)

This product is for overseas use only according to the new Measurement Law. (The SI unit type is provided for use in Japan.)

### Piping adapter port size

Symbol	Port size	Body size		
		20	30	40
01	1/8	●	—	—
02	1/4	●	●	●
03	3/8	●	●	●
04	1/2	—	●	●
06	3/4	—	—	●