

Male Connector: KFH

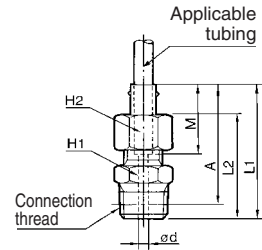

Applicable tubing (mm)		Connection thread R	Model	H1 (width across flats)	H2 (width across flats)	L1	L2	M	ød	A*	Effective area (mm ²)	Weight (g)
O.D.	I.D.											
4	2.5	1/8	KFH04-01	10	10	30.5	23.8	15.5	1.5	26.5	1.6	13
		1/4	KFH04-02	14		34.5	27.8			28.5		23
6	4	1/8	KFH06-01	10	12	30.2	23.5	15.2	3	26.2	6	14
		1/4	KFH06-02	14		34.2	27.5			28.2		25
		3/8	KFH06-03	17		35.2	28.5			28.9		36
		1/8	KFH08U-01	12		30.2	23.5			26.2		16
8	5	1/4	KFH08U-02	14	14	34.2	27.5	16.2	4	28.2	11	25
		3/8	KFH08U-03	17		39.8	28.5			28.9		37
		1/8	KFH08N-01	12		30.2	23.5			26.2		16
	6	1/4	KFH08N-02	14		34.2	27.5		28.2	17	24	
		3/8	KFH08N-03	17		35.2	28.5		28.9	36		
		1/4	KFH10U-02	17		35.8	28.5		29.8	32		
10	6.5	3/8	KFH10U-03	17	17	36.8	29.5	5.5	5.5	30.5	21	40
		1/2	KFH10U-04	22		39.8	32.5			31.6		65
		1/4	KFH10N-02	17		35.8	28.5			29.8		31
	7.5	3/8	KFH10N-03	17		36.8	29.5	30.5	30	39		
		1/2	KFH10N-04	22		39.8	32.5	31.6	64			
		1/4	KFH12U-02	17		36.3	29.5	30.3	33			
12	8	3/8	KFH12U-03	17	19	37.3	30.5	7	7	31	35	41
		1/2	KFH12U-04	22		40.3	33.5			32.1		65
		1/4	KFH12N-02	17		36.3	29.5			30.3		31
	9	3/8	KFH12N-03	17		37.3	30.5	31	45	39		
		1/2	KFH12N-04	22		40.3	33.5	32.1	64			



* Reference dimensions after R thread installation.

Straight Union: KFH



Applicable tubing (mm)		Model	H1 (width across flats)	H2 (width across flats)	L1	L2	M	ød	Effective area (mm ²)	Weight (g)
O.D.	I.D.									
4	2.5	KFH04-00	8	10	40.9	27.6	15.5	1.5	1.6	13
6	4	KFH06-00	10	12	40.3	27	15.2	3	6	17
8	5	KFH08U-00	12	14	41.3	28	16.2	4	11	23
	6	KFH08N-00						5	17	22
10	6.5	KFH10U-00	17	17	44.6	30	18.8	5.5	21	36
	7.5	KFH10N-00						6.5	30	
12	8	KFH12U-00	17	19	45.5	32	19.3	7	35	42
	9	KFH12N-00						8	45	41

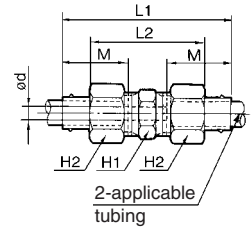

Male Elbow: KFL

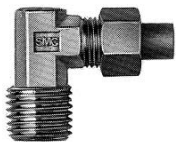

Applicable tubing (mm)		Connection thread R	Model	H1 (width across flats)	H2 (width across flats)	L1	L2	L3	L4*	M	ød	A	Effective area (mm ²)	Weight (g)						
O.D.	I.D.																			
4	2.5	1/8	KFL04-01	10	10	27.5	20.8	17	13	15.5	1.5	19.3	1.6	21						
		1/4	KFL04-02											19	25					
6	4	1/8	KFL06-01	10	12	27.2	20.5	17	13	15.2	3	19.3	6	22						
		1/4	KFL06-02											19	27					
		3/8	KFL06-03											12	30.2	23.5	20	13.7	21	38
		1/8	KFL08U-01											12	28.2	21.5	18	14	21.3	9.5
8	5	1/4	KFL08U-02	12	14	28.2	21.5	21	15	16.2	4	22.3	11	32						
		3/8	KFL08U-03											12	30.2	23.5	20	13.7	21	39
		1/8	KFL08N-01											12	28.2	21.5	18	14	21.3	12
	6	1/4	KFL08N-02								14	21	15	22.3	32					
		3/8	KFL08N-03								17	30.2	23.5	20	13.7	21	37			
		1/4	KFL10U-02								12	31.8	24.5	22	16	23.3	18	38		
10	6.5	3/8	KFL10U-03	17	17	33.8	26.5	25	16.8	18.8	5.5	22	20	44						
		1/2	KFL10U-04											14	25.3	20	66			
		1/4	KFL10N-02											12	31.8	24.5	22	16	23.3	23
	7.5	3/8	KFL10N-03								14	21	14.7	22	26	43				
		1/2	KFL10N-04								14	33.8	26.5	25	16.8	25.3	65			
		1/4	KFL12U-02								14	19	34.3	27.5	23	17	25.5	24	53	
12	8	3/8	KFL12U-03	14	19	34.3	27.5	22	15.7	19.3	7	24.2	30	53						
		1/2	KFL12U-04											14	25	16.8	25.3	68		
		1/4	KFL12N-02											14	23	17	25.5	27	51	
	9	3/8	KFL12N-03								14	22	15.7	24.2	35	57				
		1/2	KFL12N-04								14	25	16.8	25.3	62					

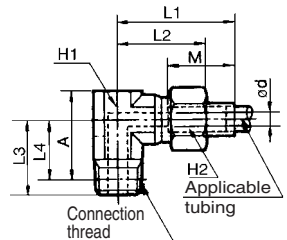

* Reference dimensions after R thread installation.

- K
- M
- H
- D
- MS
- T
- VMG

Series KF

Union Tee: KFT

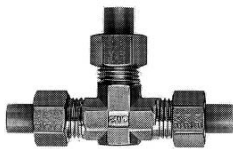

Applicable tubing (mm)		Model	H1 (width across flats)	H2 (width across flats)	L1	L2	M	ød	Effective area (mm ²)	Weight (g)
O.D.	I.D.									
4	2.5	KFT04-00	10	10	27.5	20.8	15.5	1.5	1.6	33
6	4	KFT06-00		12	27.2	20.5	15.2	3	6	37
8	5	KFT08U-00	12	14	30.2	23.5	16.2	4	11	54
	6	KFT08N-00						5	17	53
10	6.5	KFT10U-00	12	17	31.8	24.5	18.8	5.5	21	65
	7.5	KFT10N-00						6.5	30	63
12	8	KFT12U-00	14	19	34.3	27.5	19.3	7	35	89
	9	KFT12N-00						8	45	85

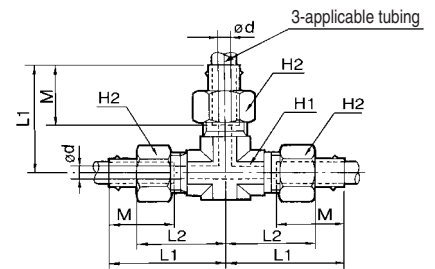

Male Branch Tee: KFT



Applicable tubing (mm)		Connection thread R	Model	H1 (width across flats)	H2 (width across flats)	L1	L2	L3	L4*	M	ød	A*	Effective area (mm ²)	Weight (g)											
O.D.	I.D.																								
4	2.5	1/8	KFT04-01	10	10	27.5	20.8	17	13	15.5	1.5	19.3	3	29											
		1/4	KFT04-02											19	34										
6	4	1/8	KFT06-01	10	12	27.2	20.5	17	13	15.2	3	19.3	10	32											
		1/4	KFT06-02											19	37										
		3/8	KFT06-03											12	30.2	23.5	22	15.7	23	12	53				
8	5	1/8	KFT08U-01	12	14	30.2	23.5	20	16	16.2	4	23.3	14	49											
		1/4	KFT08U-02											17	50										
		3/8	KFT08U-03											23	56										
	6	1/8	KFT08N-01											12	14	30.2	23.5	20	16	16.2	5	23.3	16	46	
		1/4	KFT08N-02																					17	49
		3/8	KFT08N-03																					23	54
10	6.5	1/4	KFT10U-02	12	17	31.8	24.5	23	17	18.8	5.5	24.3	27	46											
		3/8	KFT10U-03											22	63										
		1/2	KFT10U-04											27	90										
	7.5	1/4	KFT10N-02											12	17	31.8	24.5	23	17	18.8	6.5	24.3	30	57	
		3/8	KFT10N-03																					22	62
		1/2	KFT10N-04																					27	88
12	8	1/4	KFT12U-02	14	19	34.3	27.5	25	19	19.3	7	27.5	31	79											
		3/8	KFT12U-03											24	81										
		1/2	KFT12U-04											27	94										
	9	1/4	KFT12N-02											14	19	34.3	27.5	25	19	19.3	8	27.5	32	75	
		3/8	KFT12N-03																					24	78
		1/2	KFT12N-04																					27	93

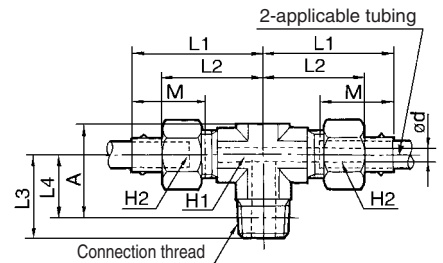

* Reference dimensions after R thread installation.

Female Connector: KFF



Applicable tubing (mm)		Connection thread Rc	Model	H1 (width across flats)	H2 (width across flats)	L1	L2	L3	M	ød	Effective area (mm ²)	Weight (g)
O.D.	I.D.											
4	2.5	1/4	KFF04-02	17	10	33.5	26.8	15	15.5	1.5	1.6	25
6	4	1/4	KFF06-02	17	12	33.2	26.5	15	15.2	3	6	27
		3/8	KFF06-03									19
8	6	1/4	KFF08U-02	17	14	33.2	26.5	15	16.2	4	11	28
			KFF08N-02									
10	6.5	1/4	KFF10U-02	17	17	34.8	27.5	15	18.8	5.5	21	32
			KFF10N-02									
12	8	1/4	KFF12U-02	17	19	35.3	28.5	15	19.3	7	35	35
			KFF12N-02									

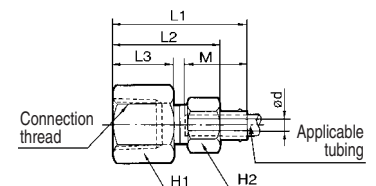

Bulkhead Connector: KFE

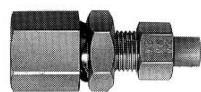

Applicable tubing (mm)		Connection thread Rc	Model	H1 (width across flats)	H2 (width across flats)	H3 (width across flats)	L1	L2	L3	M	ød	T2	Mounting hole	Effective area (mm ²)	Weight (g)
O.D.	I.D.														
6	4	1/4	KFE06-02	17	12	17	44.2	37.5	16	15.2	3	M10 x 1	11	6	41
8	5		KFE08U-03	19	14	19	46.2	39.5	17	16.2	4	M12 x 1	13	11	49
8	6	3/8	KFE08N-03								5			17	50
10	6.5		KFE10U-03	19	17	22	48.8	41.5	17	18.8	5.5	M15 x 1	16	21	63
	7.5	KFE10N-03								6.5				30	62
12	8	3/8	KFE12U-03	22	19	24	51.3	44.5	17	19.3	7	M17 x 1	18	35	93
	9		KFE12N-03								8				45

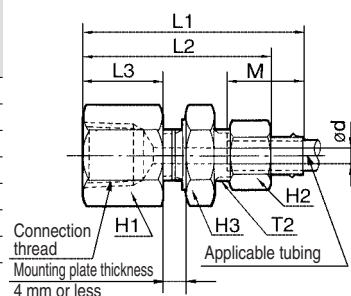

Bulkhead Union: KFE



Applicable tubing (mm)		Model	H1 (width across flats)	H2 (width across flats)	H3 (width across flats)	L1	L2	M	ød	Mounting hole	Effective area (mm ²)	Weight (g)
O.D.	I.D.											
4	2.5	KFE04-00	12	10	13	50.9	37.6	15.5	1.5	9	1.6	23
6	4	KFE06-00	14	12	17	51.3	38	15.2	3	11	6	34
8	5	KFE08U-00	17	14	19	52.3	39	16.2	4	13	11	47
	6											
10	6.5	KFE10U-00	19	17	22	56.6	42	18.8	5.5	16	21	67
	7.5											
12	8	KFE12U-00	22	19	24	59.5	46	19.3	7	18	35	87
	9											
									8		45	85

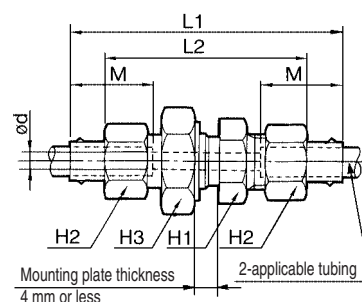

Male Run Tee: KFY

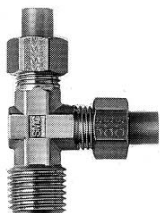

Applicable tubing (mm)		Connection thread R	Model	H1 (width across flats)	H2 (width across flats)	L1	L2	L3	L4*	M	ød	A*	Effective area (mm ²)	Weight (g)						
O.D.	I.D.																			
4	2.5	1/8	KFY04-01	10	10	27.5	20.8	17	13	15.5	1.5	40.5	3.5	28						
		1/4	KFY04-02											19	32					
6	4	1/8	KFY06-01	10	12	27.2	20.5	17	13	15.2	3	40.2	11	31						
		1/4												KFY06-02	19	37				
		3/8	KFY06-03					30.2	23.5					22	15.7	45.8	13	51		
8	5	1/8	KFY08U-01	12	14	30.2	23.5	20	16	16.2	4	46.2	15	48						
		1/4	KFY08U-02					23	17					47.2	21	50				
		3/8	KFY08U-03					22	15.7					45.8	15	55				
	6	1/8	KFY08N-01					20	16					16.2	5	46.2	18	47		
		1/4	KFY08N-02					23	17									47.2	21	48
		3/8	KFY08N-03					22	15.7									45.8	15	53
10	6.5	1/4	KFY10U-02	12	17	31.8	24.5	23	17	18.8	5.5	48.8	30	58						
		3/8	KFY10U-03					22	15.7					47.4	21	63				
		1/2	KFY10U-04					33.8	26.5					27	18.8	52.6	38	89		
	7.5	1/4	KFY10N-02					23	17					16.2	6.5	48.8	33	57		
		3/8	KFY10N-03					22	15.7									47.4	21	62
		1/2	KFY10N-04					33.8	26.5									27	18.8	52.6
12	8	1/4	KFY12U-02	14	19	34.3	27.5	25	19	19.3	7	53.3	34	79						
		3/8	KFY12U-03					24	17.7					51.9	49	79				
		1/2	KFY12U-04					27	18.8					53.1	49	93				
	9	1/4	KFY12N-02					25	19					16.2	8	53.3	36	76		
		3/8	KFY12N-03					24	17.7									51.9	49	78
		1/2	KFY12N-04					27	18.8									53.1	54	92

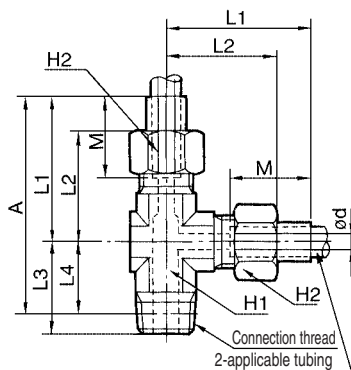

* Reference dimensions after R thread installation.

Plug: KFP



Applicable fitting (mm)	Model	L	øD	Weight (g)
4	KFP-04	12	6.5	0.3
6	KFP-06	12	8.5	0.5
8	KFP-08	12	10.4	0.7
10	KFP-10	13.5	13	1.0
12	KFP-12	14	15	1.4

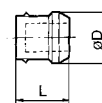

- K
- M
- H
- D
- MS
- T
- VMG

Series KF

Swivel Elbow: KFW



Applicable tubing (mm)		Connection thread R	Model	H1 (width across flats)	H2 (width across flats)	H3 (width across flats)	H4 (width across flats)	L1	L2	L3	L4*	M	ød	A*	Effective area (mm ²)	Weight (g)					
O.D.	I.D.																				
4	2.5	1/8	KFV04-01	10	10	14	10	26	19.3	33.7	29.7	15.5	1.5	35.5	1.4	40					
		1/4	KFV04-02														14	37.5	31.7		
6	4	1/8	KFV06-01	10	12	14	10	25.7	19	33.7	29.7	15.2	3	35.5	5	42					
			1/4														KFV06-02	14	37.5	31.7	
			3/8														KFV06-03	17	38.7	32.4	
8	5	1/8	KFV08U-01	12	14	17	12	27.2	20.5	34.7	30.7	16.2	4	37.6	9.4	52					
			1/4														KFV08U-02	14	38.7	32.7	
			3/8														KFV08U-03	17	39.7	33.4	
	6	1/8	KFV08N-01				12			34.7	30.7		5	37.6		14	57				
			1/4				KFV08N-02			14	38.7							32.7			
			3/8				KFV08N-03			17	39.7							33.4			
10	6.5	1/4	KFV10U-02	14	17	19	17	28.8	21.5	40.7	34.7	18.8	5.5	42.8	18		73				
			3/8															KFV10U-03	22	41.7	35.4
			1/2															KFV10U-04	22	44.7	36.5
	7.5	1/4	KFV10N-02				17			40.7	34.7		6.5	42.8		25	80				
			3/8				KFV10N-03			22	41.7							35.4			
			1/2				KFV10N-04			22	44.7							36.5			
12	8	1/4	KFV12U-02	17	19	22	17	30.3	23.5	41.7	35.7	19.3	7	45.7	30		100				
			3/8															KFV12U-03	22	42.7	36.4
			1/2															KFV12U-04	22	45.7	37.5
	9	1/4	KFV12N-02				17			41.7	35.7		8	45.7		38	90				
			3/8				KFV12N-03			22	42.7							36.4			
			1/2				KFV12N-04			22	45.7							37.5			

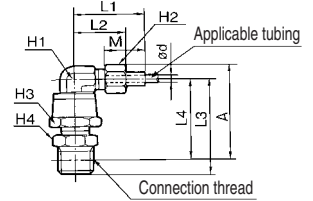

* Reference dimensions after R thread installation.

Swivel Extended Elbow: KFW



Applicable tubing (mm)		Connection thread R	Model	H1 (width across flats)	H2 (width across flats)	H3 (width across flats)	H4 (width across flats)	L1	L2	L3	L4*	M	ød	A*	Effective area (mm ²)	Weight (g)					
O.D.	I.D.																				
4	2.5	1/8	KFW04-01	10	10	14	10	26	19.3	53.7	49.7	15.5	1.5	55.5	1.4	58					
		1/4	KFW04-02														14	57.7	51.7		
6	4	1/8	KFW06-01	10	12	14	10	25.7	19	54.7	50.7	15.2	3	56.5	5	61					
			1/4														KFW06-02	14	58.7	52.7	
			3/8														KFW06-03	17	59.7	53.4	
8	5	1/8	KFW08U-01	12	14	17	12	27.2	20.5	55.7	51.7	16.2	4	58.6	9.4	81					
			1/4														KFW08U-02	14	59.7	53.7	
			3/8														KFW08U-03	17	60.7	54.4	
	6	1/8	KFW08N-01				12			55.7	51.7		5	58.6		14	81				
			1/4				KFW08N-02			14	59.7							53.7			
			3/8				KFW08N-03			17	60.7							54.4			
10	6.5	1/4	KFW10U-02	14	17	19	17	28.8	21.5	61.7	55.7	18.8	5.5	63.8	18		100				
			3/8															KFW10U-03	22	62.7	56.4
			1/2															KFW10U-04	22	65.7	57.5
	7.5	1/4	KFW10N-02				17			61.7	55.7		6.5	63.8		25	99				
			3/8				KFW10N-03			22	62.7							56.4			
			1/2				KFW10N-04			22	65.7							57.5			
12	8	1/4	KFW12U-02	17	19	22	17	30.3	23.5	64.7	58.7	19.3	7	68.7	30		146				
			3/8															KFW12U-03	22	65.7	59.4
			1/2															KFW12U-04	22	68.7	60.5
	9	1/4	KFW12N-02				17			64.7	58.7		8	68.7		38	144				
			3/8				KFW12N-03			22	65.7							59.4			
			1/2				KFW12N-04			22	68.7							60.5			

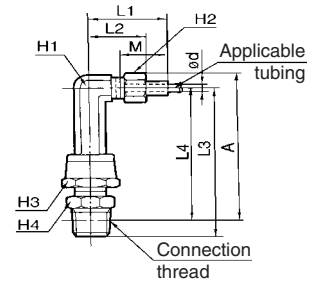

* Reference dimensions after R thread installation.