

Dimensions for Accessories

Rod end nut
(Standard)

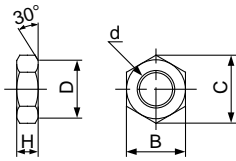

Part No.	Bore size (mm)	d	H	B	C	D
NT-03	32	M10 X 1.25	6	17	19.6	16.5
NT-04	40	M14 X 1.5	8	22	25.4	21
NT-05	50/63	M18 X 1.5	11	27	31.2	26
NT-08	80	M22 X 1.5	13	32	37.0	31
NT-10	100	M26 X 1.5	16	41	47.3	39

Knuckle joint pin
Clevis pin

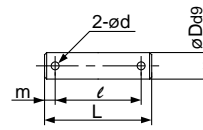

Part No.	Bore size (mm)		Dd9	L	l	m	d (Through hole diameter)	Applicable cotter pin (1)
	Clevis	Knuckle						
CD-M03	32/40	10	$10_{-0.040}^{-0.076}$	44	36	4	3	ø3 X 18 ℓ
CD-M05	50/63	14	$14_{-0.050}^{-0.093}$	60	51	4.5	4	ø4 X 25 ℓ
CD-M08	80/100	22	$22_{-0.065}^{-0.117}$	82	72	5	4	ø4 X 35 ℓ

Note 1) When using cotter pin, flat washer is used together.

Single knuckle joint

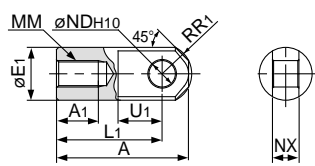

Part No.	Bore size (mm)	A	A1	E1	L1	MM	R1	U1	NDH10	NX
I-03M	32	40	14	20	30	M10 X 1.25	12	16	$10_{0}^{+0.058}$	$14_{-0.10}^{-0.30}$
I-04M	40	50	19	22	40	M14 X 1.5	12.5	19	$10_{0}^{+0.058}$	$14_{-0.10}^{-0.30}$
I-05M	50/63	64	24	28	50	M18 X 1.5	16.5	24	$14_{0}^{+0.070}$	$20_{-0.10}^{-0.30}$
I-08M	80	80	26	40	60	M22 X 1.5	23.5	34	$22_{0}^{+0.084}$	$30_{-0.10}^{-0.30}$
I-10M	100	80	26	40	60	M26 X 1.5	23.5	34	$22_{0}^{+0.084}$	$30_{-0.10}^{-0.30}$

Double knuckle joint

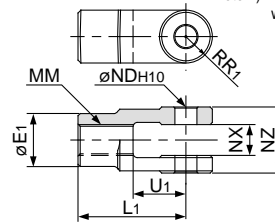

Part No.	Bore size (mm)	E1	L1	MM	R1	U1	NDH10	NX	NZ
Y-03M	32	20	30	M10 X 1.25	10	16	$10_{0}^{+0.058}$	$14_{+0.10}^{+0.30}$	$28_{-0.10}^{-0.30}$
Y-04M	40	22	40	M14 X 1.5	11	19	$10_{0}^{+0.058}$	$14_{+0.10}^{+0.30}$	$28_{-0.10}^{-0.30}$
Y-05M	50/63	28	50	M18 X 1.5	14	24	$14_{0}^{+0.070}$	$20_{+0.10}^{+0.30}$	$40_{-0.10}^{-0.30}$
Y-08M	80	40	65	M22 X 1.5	20	34	$22_{0}^{+0.084}$	$30_{+0.10}^{+0.30}$	$60_{-0.10}^{-0.30}$
Y-10M	100	40	65	M26 X 1.5	20	34	$22_{0}^{+0.084}$	$30_{+0.10}^{+0.30}$	$60_{-0.10}^{-0.30}$

Note) For a double clevis, a clevis pin (with a retaining ring) is equipped as standard.

CJ1

CJP

CJ2

CM2

C85

CG1

MB

C95

CA1

CS1

Combinations of Support Brackets

Available combinations Refer to below picture together.

Bracket for work for cylinder	Single clevis	Double clevis	Single knuckle joint	Double knuckle joint	Pivot bracket
Single clevis	-	①	-	②	-
Double clevis	③	-	④	-	⑨
Single knuckle joint	-	⑤	-	⑥	-
Double knuckle joint	⑦	-	⑧	-	⑩

No.	Appearance	No.	Appearance
①	Single clevis + Double clevis 	⑥	Single knuckle joint + Double knuckle joint
②	Single clevis + Double knuckle joint 	⑦	Double knuckle joint + Single clevis
③	Double clevis + Single clevis 	⑧	Double knuckle joint + Single knuckle joint
④	Double clevis + Single knuckle joint 	⑨	Double clevis + Pivot bracket
⑤	Single knuckle joint + Double clevis 	⑩	Double knuckle joint + Pivot bracket