

## AUTO DRAIN SERIES (N)AD

- ✓ Port Sizes 1/4~1
- ✓ Float Type Automatic Drain Valve

### TECHNICAL SPECIFICATIONS

| Type                        | (N)AD402                 | (N)AD600               |
|-----------------------------|--------------------------|------------------------|
| Operating Pressure          | 1.5~9.9 Bar<br>22~145PSI | 3~9.9 Bar<br>45~145PSI |
| Max Supply Pressure         | 15 Bar / 220PSI          |                        |
| Max Operating Pressure      | 9.9 Bar / 145PSI         |                        |
| Ambient & Fluid Temperature | 5 ~ 60°C / 40~140°F      |                        |
| Port Size                   | 1/2                      | 3/4, 1                 |
| Drain Port                  | 3/4                      | 3/4, 1                 |



### DIMENSIONS

#### AD SERIES AUTO DRAINS

AD402

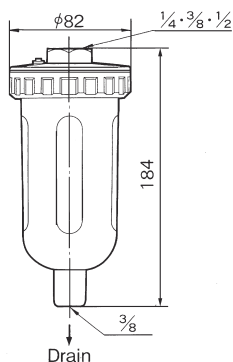

AD600

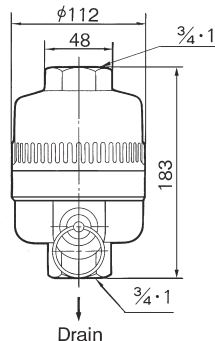

### SYMBOLS



### HOW TO ORDER

#### AUTODRAIN SERIES AD

AD402-02 (1/4) PT  
AD402-03 (3/8) PT  
AD402-04 (1/2) PT  
AD600-06 (3/4) PT  
AD600-10 (1) PT

FOR FURTHER TECHNICAL DETAILS ON THIS  
PRODUCT CONSULT SMC CUSTOMER SERVICE

### HOW TO ORDER

#### AUTODRAIN SERIES NAD

NAD402-N02 (1/4) NPT  
NAD402-N03 (3/8) NPT  
NAD402-N04 (1/2) NPT  
NAD600-N06 (3/4) NPT  
NAD600-N10 (1) NPT



FOR FURTHER TECHNICAL  
DETAILS ON THIS  
PRODUCT CONSULT  
SMC CUSTOMER SERVICE

## DIMENSIONS

