

# Pressure Sensor for General Fluids

## Series PSE570

Proof pressure

**3.0 MPa\***

\* For PSE570

<Twice as compared with the PSE560>

Withstand voltage

**500 VAC**

<Twice as compared with the PSE560>

Enclosure: IP65



RoHS



M12 connector



Port size (with M5 female thread): R1/8, 1/4

### Materials of parts in contact with fluid

Piping port *	C3604 + Nickel plating
Pressure sensor *	Al <sub>2</sub> O <sub>3</sub> (Alumina 96%)
O-ring	FKM + Grease

\* Stainless steel 316L is used for the PSE560.  
For details, refer to the **WEB catalog** or the Best Pneumatics No. 6.

### Application examples

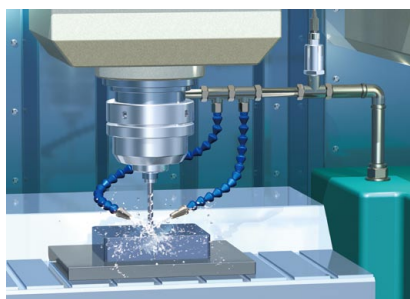

Liquid coolant pressure control



Discharge pressure control for compressor

### Variations

Model	Rated pressure range	Proof pressure
PSE570	0 ~ 1 MPa	3.0 MPa
PSE574	0 ~ 500 kPa	1.5 MPa



## How to Order



**PSE57** 0 - 01 -    

### Sensor range

Symbol	Description
<b>0</b>	Positive pressure (0 to 1 MPa)
<b>4</b>	Positive pressure (0 to 500 kPa)

### Lead wire/Option

Symbol	Description
<b>Nil</b>	With lead wire and M12 connector (3 m), Straight
<b>N</b>	None

### Port size

Symbol	Description
<b>01</b>	R1/8 (with M5 female thread)
<b>02</b>	R1/4 (with M5 female thread)

### Output specifications

Symbol	Description
<b>Nil</b>	Voltage output type (1 to 5 V)
<b>28</b>	Current output type (4 to 20 mA)

### Pressure Sensor Controller Series PSE200/300

For details, refer to the **WEB catalog** or the Best Pneumatics No. 6.

## Dimensions

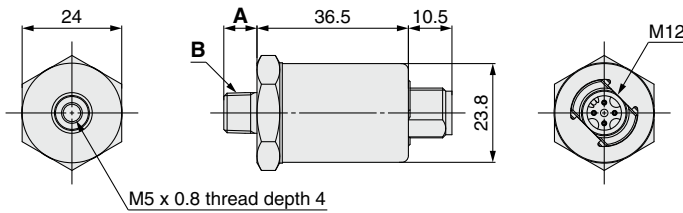

[mm]

Model	A	B
<b>PSE57□-01</b>	8	R1/8
<b>PSE57□-02</b>	12	R1/4

## Lead wire and M12 connector ZS-37-A

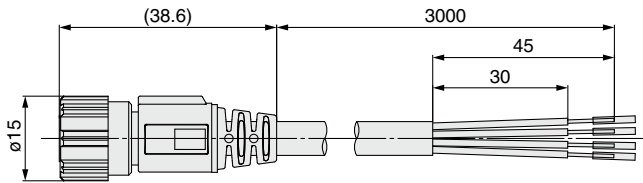
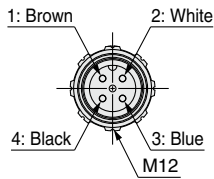

Part no.	Description
<b>ZS-37-A</b>	Straight type 3 m

## Specifications

### Specifications

Model		<b>PSE570</b>	<b>PSE574</b>
Pressure specifications	Rated pressure range	0 to 1 MPa	0 to 500 kPa
	Proof pressure	3.0 MPa	1.5 MPa
Temperature characteristics		±2% F. S. (0 to 50°C) ±3% F. S. (-10 to 60°C)	±3% F. S. (0 to 50°C) ±4% F. S. (-10 to 60°C)

Model		<b>PSE57□-□</b>	<b>PSE57□-□-28</b>
Fluid	Applicable fluid	Gas or liquid that will not attack or corrode materials of parts in contact with fluid	
Electrical specifications	Power supply voltage	12 to 24 VDC ±10% with 10% voltage ripple or less	
	Current consumption	10 mA or less	
	Protection	Reverse connection protection	
Analog output	Output	Analog output: 1 to 5 V Output impedance: Approx. 1 kΩ	Analog output: 4 to 20 mA Maximum load impedance: 500 Ω or less (at 24 VDC) 100 Ω or less (at 12 VDC)
		Analog output accuracy (Ambient temperature at 25°C)	±1.0% F. S.
Linearity		±0.5% F. S.	
Repeatability		±0.2% F. S. (Ambient temperature at 25°C)	
Environment	Enclosure	IP65	
	Withstand voltage	500 VAC for 1 minute between terminals and housing	
	Insulation resistance	100 MΩ or more (500 VDC measured via megohmmeter) between terminals and housing	
	Operating temperature range	Operating: -10 to 60°C, Stored: -20 to 70°C (No freezing or condensation)	
Operating humidity range		Operating/Stored: 35 to 85% RH (No condensation)	
Standards		CE, RoHS	

### Piping Specifications

Model		<b>01</b>	<b>02</b>
Port size		R1/8 M5 x 0.8	R1/4 M5 x 0.8
Materials of parts in contact with fluid		Piping port: C3604 + Nickel plating Pressure sensor: Al <sub>2</sub> O <sub>3</sub> (Alumina 96%) O-ring: FKM + Grease	
Weight	Without cable	88 g	95 g
	With cable	175 g	182 g