

Compact Cylinder with Air Cushion

Series RQ

ø20, ø25, ø32, ø40, ø50, ø63, ø80, ø100

How to Order

Without auto switch

RQ B 32 50

With auto switch

RDQ B 32 50 F9BW

With auto switch
(built-in magnet)

Mounting

B	Through hole (standard)	F	Front flange
A	Double end tapped	G	Rear flange
L	Foot	D	Double clevis

Note 1) Mounting brackets are packed together when shipped (unassembled).

Note 2) Since sizes ø20 and ø25 have a body with B type (through hole) and A type (double end tapped) in common, there is no A type part number.

Example) RQA 20-30 does not exist.

Bore size

20	20mm
25	25mm
32	32mm
40	40mm
50	50mm
63	63mm
80	80mm
100	100mm

Number of auto switches

Nil	2 pcs.
S	1 pc
n	"n" pcs.

Auto switch

Nil Without auto switch (built-in magnet)

*Select auto switch models from the table below.
*The auto switch is packed together when shipped (unmounted).

Body option

Nil	Rod end female threads (standard)
M	Rod end male threads

Cylinder stroke (mm)

Refer to page 2 for standard strokes.

Port thread type

Nil	M thread	ø20, 25
	Rc	
TN	NPT	ø32 to ø100
TF	G	

Applicable auto switches/For detailed specifications of applicable auto switches, refer to pages 5.3-2 through 5.3-75 of "Best Pneumatics vol.2".

Type	Special function	Electrical entry	Indicator light	Wiring (Output)	Load voltage		Rail mount		Direct mount		Lead wire length (m)*				Pre-wired connector	Applicable load		
					DC	AC	ø32 to ø100		ø20 to ø100		0.5 (Nil)	3 (L)	5 (Z)	None (N)		IC circuit	Relay, PLC	
							Perpendicular	In-line	Perpendicular	In-line								
Reed switch	—	Grommet	Yes	3-wire (NPN equiv.)	—	5V	—	A76H	A96V	A96	●	●	—	—	—	IC circuit	—	
											—	—	—	—				—
	Diagnostic indication (2-color display)	Connector		2-wire	24V	12V	100V	A72	A72H	—	—	●	●	—	—	—	Relay, PLC	
								A73	A73H	—	—	●	●	●	—			—
Solid state switch	—	Grommet	Yes	3-wire (NPN)	5V, 12V	—	F7NV	F79	F9NV	F9N	●	●	○	—	○	IC circuit	—	
											3-wire (PNP)	F7PV	F7P	F9PV				F9P
	Diagnostic indication (2-color display)	Connector		2-wire	24V	12V	—	F7BV	J79	F9BV	F9B	●	●	○	—	○	—	Relay, PLC
								J79C	—	—	—	●	●	●	●			
	Water resistance (2-color display)	Grommet		3-wire (NPN)	5V, 12V	—	—	F7NVV	F79W	F9NVV	F9NW	●	●	○	—	○	IC circuit	—
								—	F7PW	F9PWW	F9PW	●	●	○	—			
	With diagnostic output (2-color display)	Grommet		2-wire	24V	12V	—	F7BWW	J79W	F9BWW	F9BW	●	●	○	—	○	—	Relay, PLC
								—	F7BA	—	F9BA	—	●	○	—			
	Latch type with diagnostic output (2-color display)	Grommet		4-wire (NPN)	5V, 12V	—	—	F7BAV	—	—	—	—	●	○	—	○	—	IC circuit
								—	F79F	—	—	—	●	●	○			
—	Grommet	4-wire (NPN)	5V, 12V	—	—	—	F7LF	—	—	—	●	●	○	—	○	—		

*Lead wire length symbols 0.5m ····· Nil (Example) A73C
3 m ····· Z (Example) A73CL
5 m ····· L (Example) A73CZ
None ····· N (Example) A73CN

*Solid state auto switches marked with a "○" are produced upon receipt of order.

• Besides the models in the above catalog, there are some other auto switches that are applicable. For more information, refer to page 15.

Specifications



Type	Pneumatic (non-lube) type
Fluid	Air
Proof pressure	1.5MPa
Maximum operating pressure	1.0MPa
Minimum operating pressure	0.05MPa
Ambient and fluid temperature	Without auto switch: -10°C to 70°C (with no freezing) With auto switch : -10°C to 60°C (with no freezing)
Rod end threads	Female threads
Rod end thread tolerance	JIS class 2
Stroke length tolerance	$\begin{matrix} +1.0 \\ 0 \end{matrix}$
Mounting	Through hole
Piston speed	50 to 500mm/s

Standard Strokes

Bore size (mm)	Standard stroke (mm)
20, 25	15, 20, 25, 30, 40, 50
32, 40	20, 25, 30, 40, 50, 75, 100
50, 63	30, 40, 50, 75, 100
80, 100	40, 50, 75, 100

Manufacture of Intermediate Strokes

Method	Special body type	
Ordering	Refer to "How to Order" for standard part numbers.	
Method	Available in stroke increments of 1mm, using a special body for the specified stroke.	
Stroke range	Bore size	Stroke range
	20, 25	16 to 49
	32, 40	21 to 99
	50, 63	31 to 99
	80, 100	41 to 99
Example	Part number: RQB32-47 A special tube is manufactured for a 47mm stroke.	

Allowable kinetic energy

Refer to "Selection" on page 24 regarding the allowable kinetic energy.

Effective Cushion Length

Bore size (mm)	20	25	32	40	50	63	80	100
Effective cushion length (mm)	5.8	6.1	6.6	6.6	7.1	7	7.5	8

Mounting Bracket Part No.

Bore size (mm)	Note 1)		Note 3)
	Foot	Flange	Double clevis
20	CQS-L020	CQS-F020	CQS-D020
25	CQS-L025	CQS-F025	CQS-D025
32	CQ-L032	CQ-F032	CQ-D032
40	CQ-L040	CQ-F040	CQ-D040
50	CQ-L050	CQ-F050	CQ-D050
63	CQ-L060	CQ-F060	CQ-D060
80	CQ-L080	CQ-F080	CQ-D080
100	CQ-L100	CQ-F100	CQ-D100

Note 1) When ordering foot brackets, order 2 pieces per cylinder.

Note 2) The following parts are included with each bracket.

Foot/Flange : Body mounting bolts.

Double clevis: Clevis pins, C set ring for axis, and Body mounting bolts.

Note 3) Clevis pins and snap rings are included with the double clevis type.

Theoretical Output

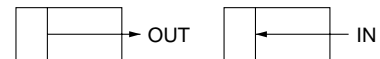

Unit: N

Bore size (mm)	Operating direction	Operating pressure (MPa)		
		0.3	0.5	0.7
20	IN	71	118	165
	OUT	94	157	220
25	IN	113	189	264
	OUT	147	245	344
32	IN	181	302	422
	OUT	241	402	563
40	IN	317	528	739
	OUT	377	628	880
50	IN	495	825	1150
	OUT	589	982	1370
63	IN	841	1400	1960
	OUT	935	1560	2180
80	IN	1360	2270	3170
	OUT	1510	2510	3520
100	IN	2140	3570	5000
	OUT	2360	3930	5500

Series RQ

Weights

Basic weights

Unit: g

Bore size (mm)	Standard stroke (mm)							
	15	20	25	30	40	50	75	100
20	141	156	171	186	216	245	—	—
25	203	221	239	258	294	331	—	—
32	—	271	291	312	353	394	496	598
40	—	390	413	436	482	528	643	758
50	—	—	—	731	803	875	1055	1235
63	—	—	—	940	1019	1099	1297	1495
80	—	—	—	—	1819	1950	2278	2606
100	—	—	—	—	2859	3038	3483	3928

Additional weights

Unit: g

Bore size (mm)	20	25	32	40	50	63	80	100
Magnet	5	6	11	13	14	22	24	35
Double end tapped	—	—	6	6	6	19	45	45
Rod end male threads	Male threads	6	12	26	27	53	53	120
	Nut	4	8	17	17	32	32	49
Foot (including bolt)	159	181	143	155	243	324	696	1062
Front flange (including bolt)	143	180	180	214	373	559	1056	1365
Rear flange (including bolt)	137	171	165	198	348	534	1017	1309
Double clevis (including pin, snap ring and bolt)	92	127	151	196	393	554	1109	1887

Calculation example) RQD32-20M

•Basic weight	: RQB32-20	271g
•Additional weight:	Double end tapped	6g
	Rod end male threads	43g
	Double clevis	151g
		471g

Mounting

Through hole type mounting bolts for RQB are available.

How to order: Add "Bolt" in front of the bolts to be used.

Example) Bolt M5 x 50/ 4 pcs.

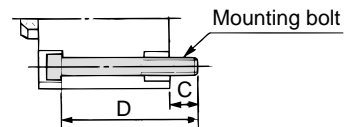

Model	C	D	Mounting bolt
R(D)QB20-15	9	50	M5 x 50/
-20		55	x 55/
-25		60	x 60/
-30		65	x 65/
-40		75	x 75/
-50		85	x 85/
R(D)QB25-15	9.5	55	M5 x 55/
-20		60	x 60/
-25		65	x 65/
-30		70	x 70/
-40		80	x 80/
R(D)QB32-20	10	60	M5 x 60/
-25		65	x 65/
-30		70	x 70/
-40		80	x 80/
-50		90	x 90/
-75		115	x 115/
-100		140	x 140/

Model	C	D	Mounting bolt
R(D)QB40-20	8	65	M5 x 65/
-25		70	x 70/
-30		75	x 75/
-40		85	x 85/
-50		95	x 95/
-75		120	x 120/
-100		145	x 145/
R(D)QB50-30	13.5	85	M6 x 85/
-40		95	x 95/
-50		105	x 105/
-75		130	x 130/
R(D)QB63-30	15.5	90	M8 x 90/
-40		100	x 100/
-50		110	x 110/
-75		135	x 135/
-100		160	x 160/
R(D)QB80-40	15	105	M10 x 105/
-50		115	x 115/
-75		140	x 140/
-100		165	x 165/
R(D)QB100-40	17.5	120	M10 x 120/
-50		130	x 130/
-75		155	x 155/
-100		180	x 180/

Replacement Parts/Seal Kits

Series	Bore size	Order number	Contents
RQ	20	RQB20-PS	Kits consist of piston seal, rod seal and gasket
	25	RQB25-PS	
	32	RQB32-PS	
	40	RQB40-PS	
	50	RQB50-PS	
	63	RQB63-PS	
	80	RQB80-PS	
	100	RQB100-PS	

Auto Switch Mounting Bracket Part Nos.

Bore size (mm)	Bracket no.	Note	Applicable switch	
			Reed switch	Solid state switch
32, 40, 50, 63, 80, 100	BQ-2	<ul style="list-style-type: none"> •Switch mounting screw (M3 x 0.5 x 10) •Switch spacer •Switch mounting nut 	D-A7□, A80	D-F7□, J79
			D-A73C, A80C	D-F7□V
			D-A7□H, A80H	D-J79C
			D-A79W	D-F7□W, J79W
			D-F7□WV	D-F7BAL
				D-F7BAVL
				D-F7□F
				D-F7NTL

[Stainless steel mounting screw kit]
 Use the following stainless steel mounting screw kit (includes nut) depending on the operating environment.
 (Auto switch spacer must be ordered separately.)
BBA2: For D-A7/A8/F7/J7

The above stainless steel screw kit is used for water resistant auto switch types D-F7BAL and D-F7BAVL when they are shipped mounted on a cylinder.
 Also, BBA2 is included when an auto switch alone is shipped.

Series RQ

Dimensions/ $\phi 20$, $\phi 25$

*Refer to page13 for proper auto switch mounting positions and height.

Standard type (through hole, double end tapped common)/RQB, RDQB

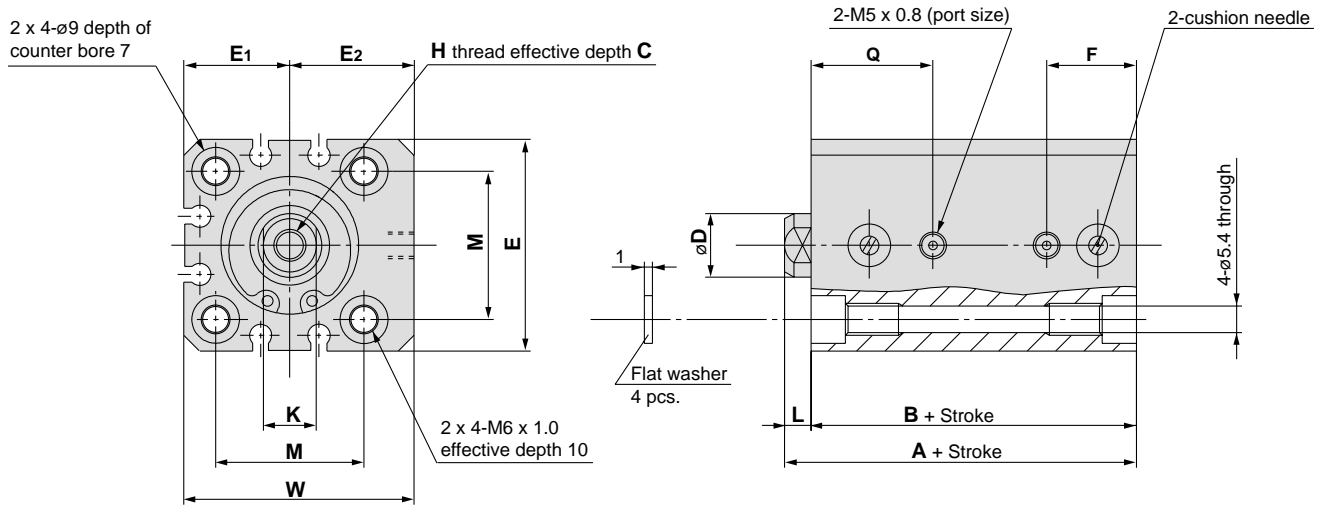

Rod end male threads

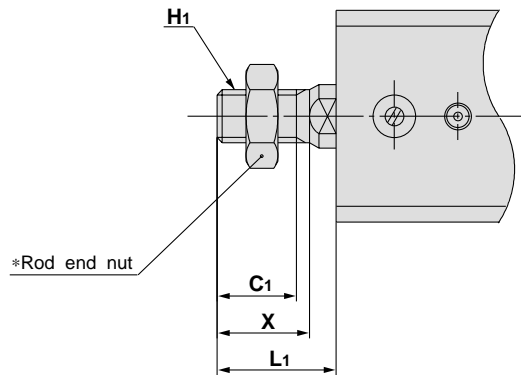

Rod end male threads

Bore size (mm)	C1	X	H1	L1
20	12	14	M8 x 1.25	18.5
25	15	17.5	M10 x 1.25	22.5

Standard type

Bore size (mm)	Stroke range (mm)	A	B	C	D	E	E1	E2	F	H	K	L	M	Q	W
20	15 to 50	36.5	32	7	10	36	18	21	15.5	M5 x 0.8	8	4.5	25.5	21	39
25	15 to 50	41.5	36.5	12	12	40	20	23.5	17	M6 x 1.0	10	5	28	23	43.5

*Refer to page 11 for details on rod end nut and accessories.



• Add the stroke to calculate the length of intermediate strokes.

Mounting Bracket Dimensions

Foot type/RQL, RDQL

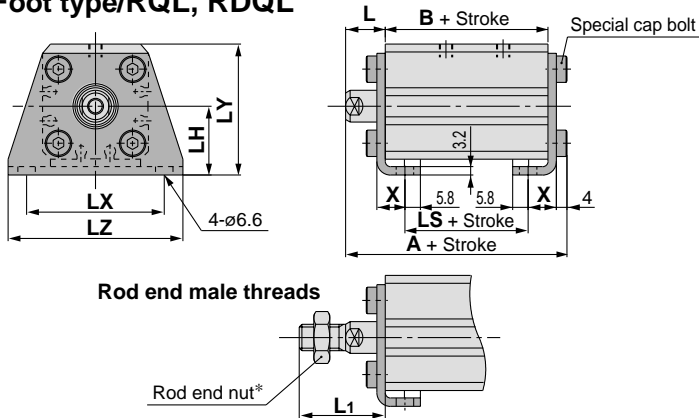

Foot type

Bore size (mm)	Stroke range (mm)	A	LS	L	L ₁
20	15 to 50	53.7	20	14.5	28.5
25	15 to 50	58.7	21.5	15	32.5

Bore size (mm)	B	LH	LX	LY	LZ	X
20	32	24	48	45	62	9.2
25	36.5	26	52	49.5	66	10.7

(All dimensions but A, LS, L and L₁ are identical to those of the standard type.)

Foot bracket material: Carbon steel

Front flange type/ RQF, RDQF

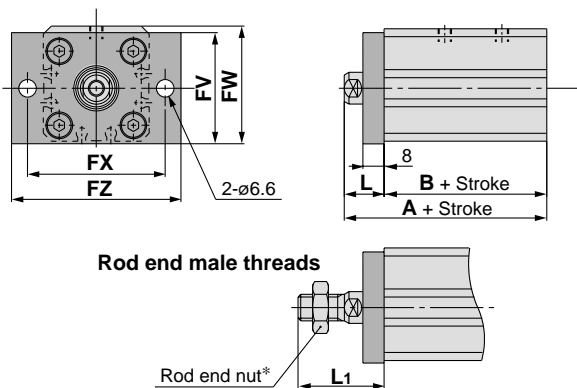

Front flange type

Bore size (mm)	Stroke range (mm)	A	L	L ₁
20	15 to 50	46.5	14.5	28.5
25	15 to 50	51.5	15	32.5

Bore size (mm)	B	FV	FW	FX	FZ
20	32	39	40.5	48	60
25	36.5	42	44.5	52	64

(All dimensions but A, L and L₁ are identical to those of the standard type.)

Flange material: Carbon steel

Rear flange type/RQG, RDQG

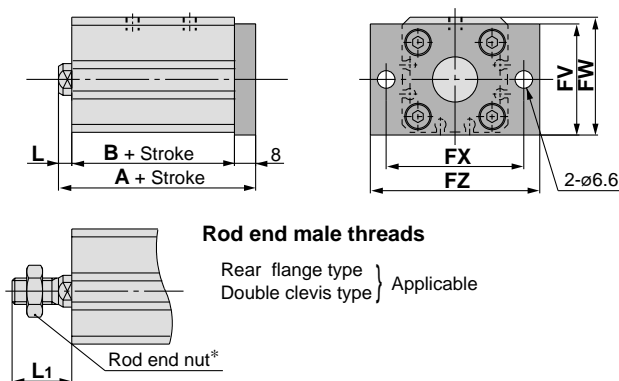

Rear flange type

Bore size (mm)	Stroke range (mm)	A
20	15 to 50	44.5
25	15 to 50	49.5

Bore size (mm)	B	L	FV	FW	FX	FZ
20	32	4.5	39	40.5	48	60
25	36.5	5	42	44.5	52	64

(All dimensions but A is identical to those of the standard type.)

Flange material: Carbon steel

Double clevis/RQD, DQD

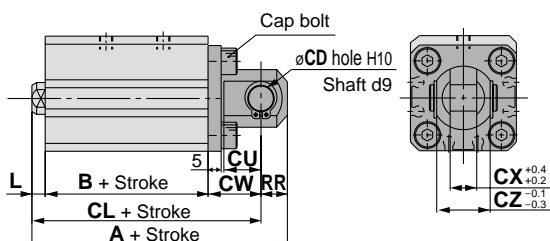

Double clevis type

Bore size (mm)	Stroke range (mm)	A	CL
20	15 to 50	63.5	54.5
25	15 to 50	71.5	61.5

Bore size (mm)	B	L	L ₁	CD	CU	CW	CX	CZ	RR
20	32	4.5	18.5	8	12	18	8	16	9
25	36.5	5	22.5	10	14	20	10	20	10

(All dimensions but A and CL are identical to those of the standard type.)

*Refer to page 11 for details on rod end nut and accessories.

Double clevis bracket material: Carbon steel

Series RQ

Dimensions/ $\phi 32$, $\phi 40$, $\phi 50$

*Refer to pages 13 and 14 for proper auto switch mounting positions and height.

Standard type (through hole type)/RQB, RDQB

Double end tapped

Bore size (mm)	OA	RA
32	M6 x 1.0	10
40	M6 x 1.0	10
50	M8 x 1.25	14

Double end tapped type: RQA, RDQA

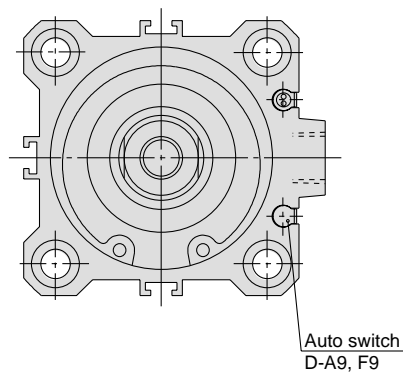
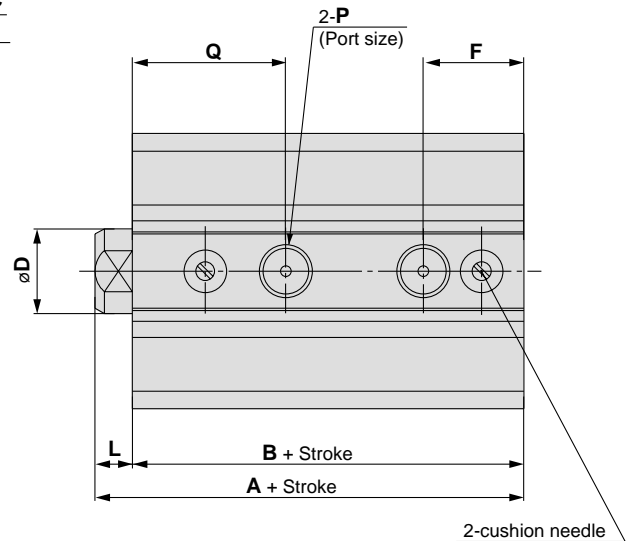
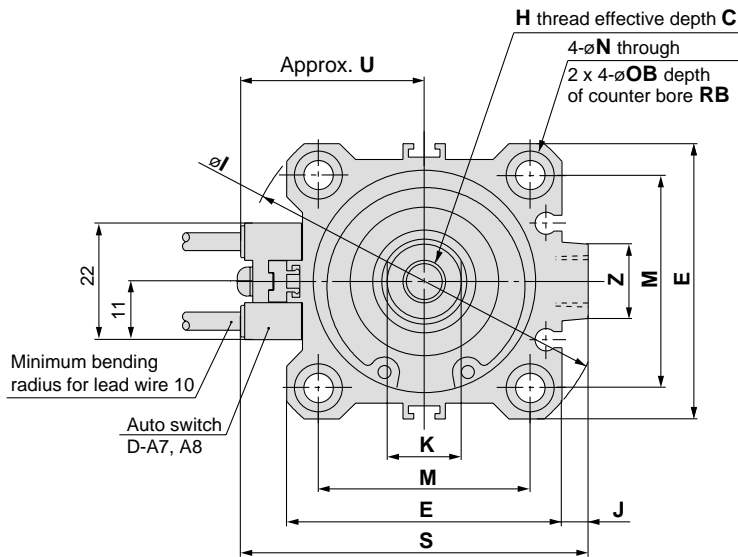
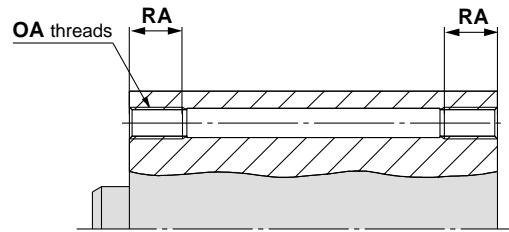

Rod end male threads

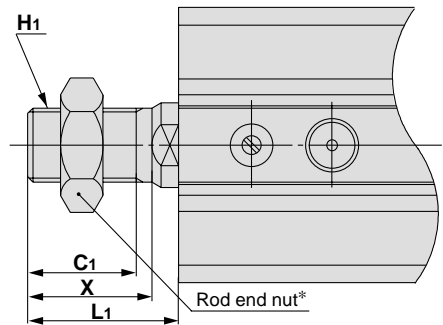

Rod end male threads

Bore size (mm)	C1	X	H1	L1
32	20.5	23.5	M14 x 1.5	28.5
40	20.5	23.5	M14 x 1.5	28.5
50	26	28.5	M18 x 1.5	33.5

Standard type

Bore size (mm)	Stroke range (mm)	A	B	C	D	E	F	H	I	J	K	L	M	N
32	20 to 100	44	37	13	16	45	18.5	M8 x 1.25	60	4.5	14	7	34	5.5
40	20 to 100	51	44	13	16	52	20	M8 x 1.25	69	5	14	7	40	5.5
50	30 to 100	57.5	49.5	15	20	64	28.5	M10 x 1.5	86	7	17	8	50	6.6

Bore size (mm)	OB	P	Q	RB	S	U	Z
32	9	Rc 1/8	23	7	58.5	31.5	14
40	9	Rc 1/8	28	7	66	35	14
50	11	Rc 1/4	31.5	8	80	41	19

*Refer to page 11 for details on rod end nut and accessories.



• Add the stroke to calculate the length of intermediate strokes.

Mounting Bracket Dimensions

Foot type/RQL, RDQL

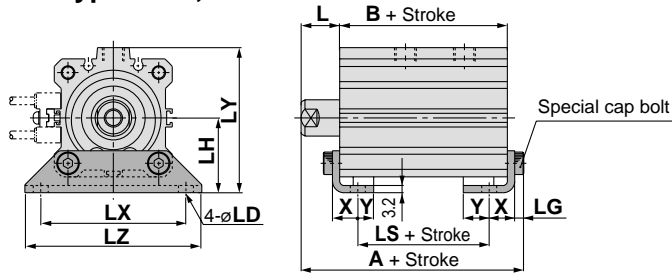

Rod end male threads

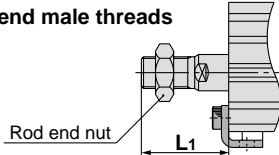

Foot type

Bore size (mm)	Stroke range (mm)	A	B	LS	L	L1	LD
32	20 to 100	61.2	37	21	17	38.5	6.6
40	20 to 100	68.2	44	28	17	38.5	6.6
50	30 to 100	75.7	49.5	26.5	18	43.5	9

Bore size (mm)	LG	LH	LX	LY	LZ	X	Y
32	4	30	57	57	71	11.2	5.8
40	4	33	64	64	78	11.2	7
50	5	39	79	78	95	14.7	8

Foot bracket material: Carbon steel

Front flange type/RQF, RDQF

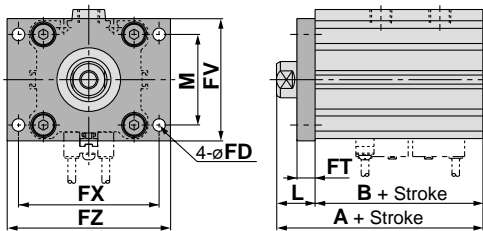

Rod end male threads

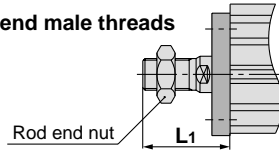

Front flange type

Bore size (mm)	Stroke range (mm)	A	B	FD	FT	FV
32	20 to 100	54	37	5.5	8	48
40	20 to 100	61	44	5.5	8	54
50	30 to 100	67.5	49.5	6.6	9	67

Bore size (mm)	FX	FZ	L	L1	M
32	56	65	17	38.5	34
40	62	72	17	38.5	40
50	76	89	18	43.5	50

Flange material: Carbon steel

Rear flange type/RQG, RDQG

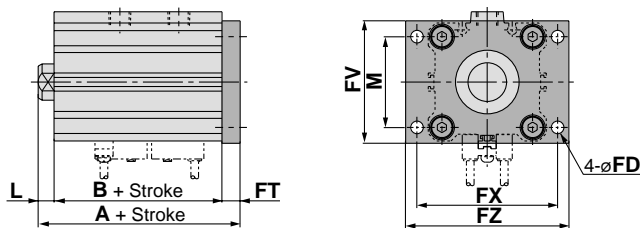

Rod end male threads

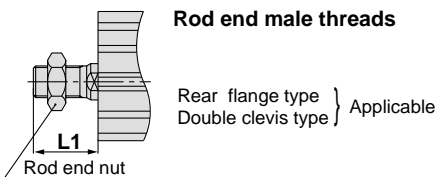

Rear flange type

Bore size (mm)	Stroke range (mm)	A	L	L1
32	20 to 100	52	7	28.5
40	20 to 100	59	7	28.5
50	30 to 100	66.5	8	33.5

(*All dimensions but A, L and L1 are identical to those of the front flange type.)

Flange material: Carbon steel

Double clevis type/RQD, RDQD

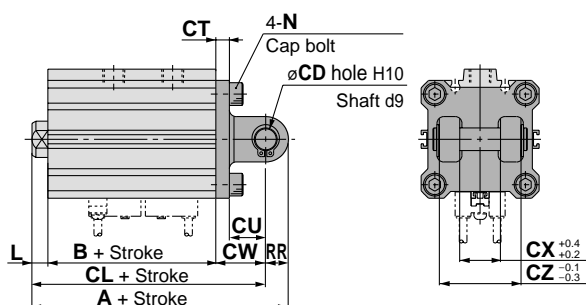

Double clevis type

Bore size (mm)	Stroke range (mm)	A	B	CL	CD	CT	CU
32	20 to 100	74	37	64	10	5	14
40	20 to 100	83	44	73	10	6	14
50	30 to 100	99.5	49.5	85.5	14	7	20

Bore size (mm)	CW	CX	CZ	L	L1	N	RR
32	20	18	36	7	28.5	M6 x 1.0	10
40	22	18	36	7	28.5	M6 x 1.0	10
50	28	22	44	8	33.5	M8 x 1.25	14

*Refer to page 11 for details on rod end nut and accessories.

*Clevis pins and snap rings are included in the package.

Double clevis bracket material: carbon steel

Series RQ

Dimensions/ø63 to ø100

*Refer to pages 13 and 14 for proper auto switch mounting positions and height.

Standard type (through hole type)

Double end tapped

Bore size (mm)	OA	RA
63	M10 x 1.5	18
80	M12 x 1.75	22
100	M12 x 1.75	22

Double end tapped type: RQA, RDQA

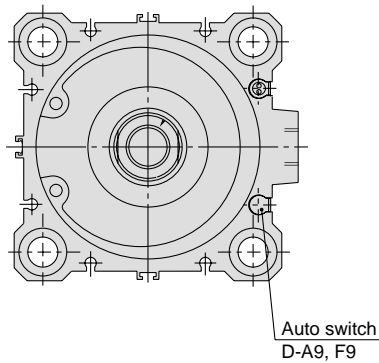
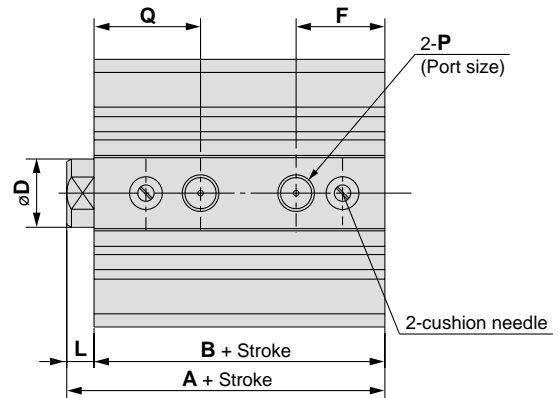
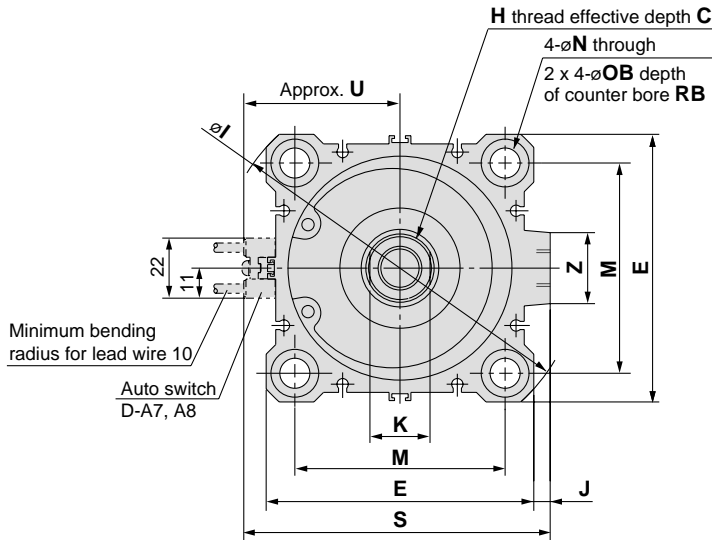
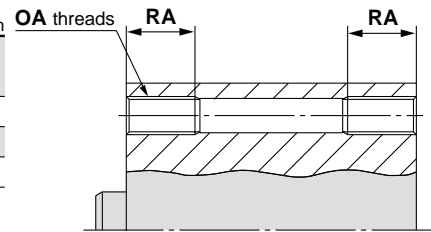

Rod end male thread

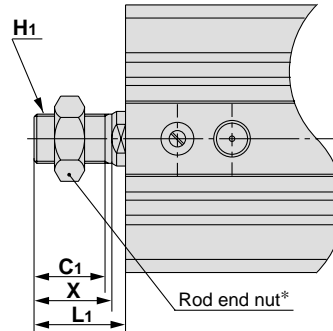

Rod end male threads

Bore size (mm)	C1	X	H1	L1
63	26	28.5	M18 x 1.5	33.5
80	32.5	35.5	M22 x 1.5	43.5
100	32.5	35.5	M26 x 1.5	43.5

Standard type

Bore size (mm)	Stroke range (mm)	A	B	C	D	E	F	H	I	J	K	L	M	N	OB	P
63	30 to 100	63	55	15	20	77	31	M10 x 1.5	103	7	17	8	60	9	14	Rc 1/4
80	40 to 100	73.5	63.5	21	25	98	35.5	M16 x 2.0	132	6	22	10	77	11	17.5	Rc 3/8
100	40 to 100	88	76	27	30	117	40	M20 x 2.5	156	6.5	27	12	94	11	17.5	Rc 3/8

Bore size (mm)	Q	RB	S	U	Z
63	34	10.5	93	47.5	19
80	39	13.5	112.5	57.5	26
100	43	13.5	132.5	67.5	26

*Refer to page 11 for details on rod end nut and accessories.

• Add the stroke to calculate the length of intermediate strokes.

Mounting Bracket Dimensions

Foot type/RQL, RDQL

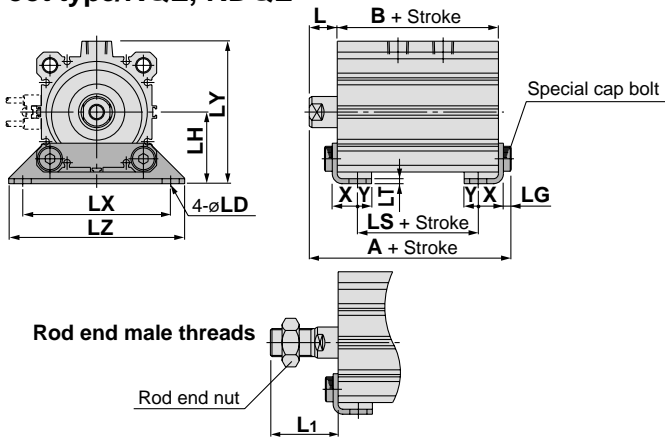

Foot type

Bore size (mm)	Stroke range (mm)	A	B	LS	L	L1	LD	LG	LH	LT
63	30 to 100	81.2	55	29	18	43.5	11	5	46	3.2
80	40 to 100	95	63.5	33.5	20	53.5	13	7	59	4.5
100	40 to 100	111	76	42	22	53.5	13	7	71	6

Bore size (mm)	Stroke range (mm)	LX	LY	LZ	X	Y
63	10 to 50	95	91.5	113	16.2	9
	75, 100					
80	10 to 50	118	114	140	19.5	11
	75, 100					
100	10 to 50	137	136	162	23	12.5
	75, 100					

Front flange type/RQF, RDQF

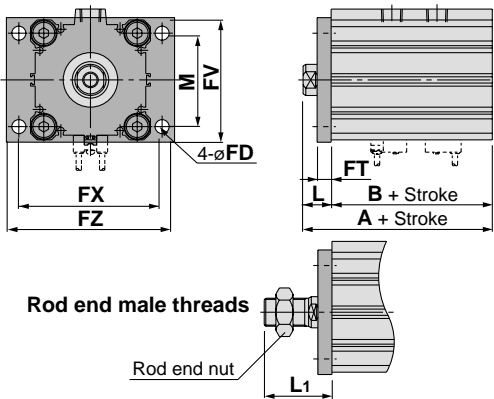

Front flange type

Bore size (mm)	Stroke range (mm)	A	B	FD	FT	FV	FX	FZ	L	L1	M
63	30 to 100	73	55	9	9	80	92	108	18	43.5	60
80	40 to 100	83.5	63.5	11	11	99	116	134	20	53.5	77
100	40 to 100	98	76	11	11	117	136	154	22	53.5	94

Rear flange type/RQG, RDQG

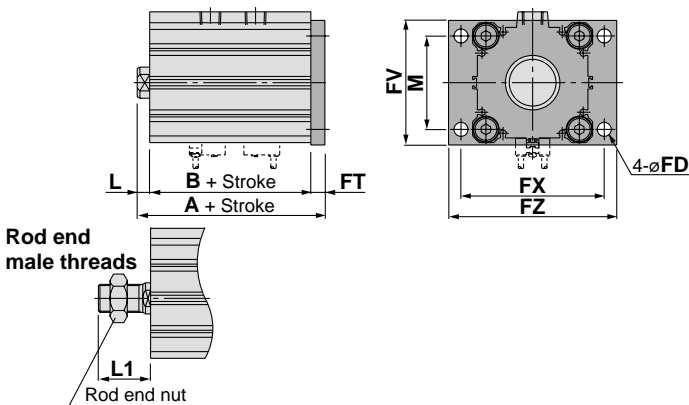

Rear flange type

Bore size (mm)	Stroke range (mm)	A	L	L1
63	30 to 100	72	8	33.5
80	40 to 100	84.5	10	43.5
100	40 to 100	99	12	43.5

Double clevis type/RQD, RDQD

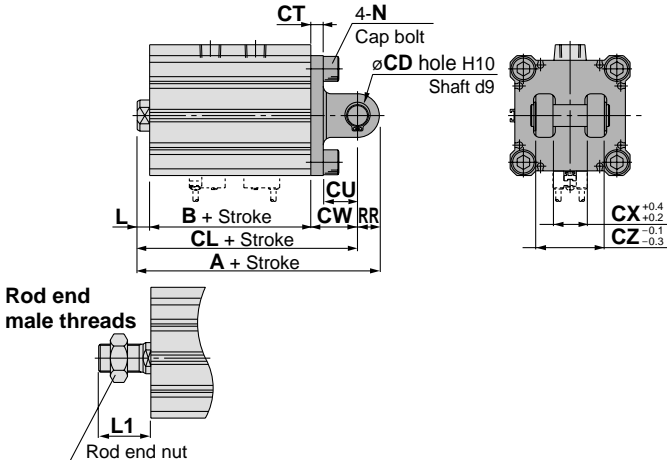

Double clevis type

Bore size (mm)	Stroke range (mm)	A	B	CL	CD	CT	CU	CW	CX	CZ	L
63	30 to 100	107	55	93	14	8	20	30	22	44	8
80	40 to 100	129.5	63.5	111.5	18	10	27	38	28	56	10
100	40 to 100	155	76	133	22	13	31	45	32	64	12

Bore size (mm)	Stroke range (mm)	L1	N	RR
63	10 to 50	33.5	M10 x 1.5	14
	75, 100			
80	10 to 50	43.5	M12 x 1.75	18
	75, 100			
100	10 to 50	43.5	M12 x 1.75	22
	75, 100			

*Refer to page 11 for details on rod end nut and accessories.
*Clevis pins and snap rings are included in the package.

Series RQ

Accessories

Single Knuckle Joint

For I-G02, I-G03

For I-G04, I-G05

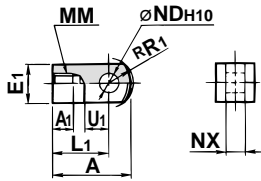

Material: Carbon steel

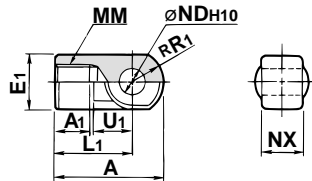

Material: Cast iron

Double Knuckle Joint

For Y-G02, Y-G03

For Y-G04, Y-G05

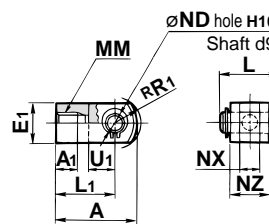

Material: Carbon steel

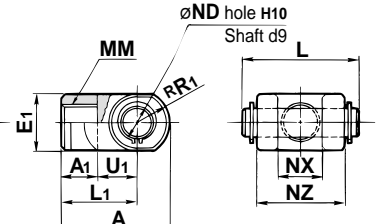

Material: Cast iron

Part no.	Applicable bore size (mm)	A	A ₁	E ₁	L ₁	MM	R _{R1}	U ₁	ND	NX
I-G02	20	34	8.5	□16	25	M8 x 1.25	10.3	11.5	8 ^{+0.058} ₀	8 ^{-0.2} _{-0.4}
I-G03	25	41	10.5	□20	30	M10 x 1.25	12.8	14	10 ^{+0.058} ₀	10 ^{-0.2} _{-0.4}
I-G04	32, 40	42	14	∅22	30	M14 x 1.5	12	14	10 ^{+0.058} ₀	18 ^{-0.3} _{-0.5}
I-G05	50, 63	56	18	∅28	40	M18 x 1.5	16	20	14 ^{+0.070} ₀	22 ^{-0.3} _{-0.5}
I-G08	80	71	21	∅38	50	M22 x 1.5	21	27	18 ^{+0.070} ₀	28 ^{-0.3} _{-0.5}
I-G10	100	79	21	∅44	55	M26 x 1.5	24	31	22 ^{+0.084} ₀	32 ^{-0.3} _{-0.5}

mm

Part no.	Applicable bore size (mm)	A	A ₁	E ₁	L ₁	MM	R _{R1}	U ₁	ND	NX	NZ	L	Applicable pin no.
Y-G02	20	34	8.5	□16	25	M8 x 1.25	10.3	11.5	8 ^{+0.058} ₀	8 ^{+0.4} _{+0.2}	16	21	IY-G02
Y-G03	25	41	10.5	□20	30	M10 x 1.25	12.8	14	10 ^{+0.058} ₀	10 ^{+0.4} _{+0.2}	20	25.6	IY-G03
Y-G04	32, 40	42	16	∅22	30	M14 x 1.5	12	14	10 ^{+0.058} ₀	18 ^{+0.5} _{+0.3}	36	41.6	IY-G04
Y-G05	50, 63	56	20	∅28	40	M18 x 1.5	16	20	14 ^{+0.070} ₀	22 ^{+0.5} _{+0.3}	44	50.6	IY-G05
Y-G08	80	71	23	∅38	50	M22 x 1.5	21	27	18 ^{+0.070} ₀	28 ^{+0.5} _{+0.3}	56	64	IY-G08
Y-G10	100	79	24	∅44	55	M26 x 1.5	24	31	22 ^{+0.084} ₀	32 ^{+0.5} _{+0.3}	64	72	IY-G10

mm

*Knuckle pin and snap ring are included.

Knuckle Pin (common with double clevis pin)

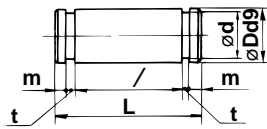

Material: Carbon steel

Part no.	Applicable bore size (mm)	D	L	d	/	m	t	Snap ring
IY-G02	20	8 ^{-0.040} _{-0.076}	21	7.6	16.2	1.5	0.9	C8 type for pivot
IY-G03	25	10 ^{-0.040} _{-0.076}	25.6	9.6	20.2	1.55	1.15	C10 type for pivot
IY-G04	32,40	10 ^{-0.040} _{-0.076}	41.6	9.6	36.2	1.55	1.15	C10 type for pivot
IY-G05	50,63	14 ^{-0.050} _{-0.093}	50.6	13.4	44.2	2.05	1.15	C14 type for pivot
IY-G08	80	18 ^{-0.050} _{-0.093}	64	17	56.2	2.55	1.35	C18 type for pivot
IY-G10	100	22 ^{-0.065} _{-0.117}	72	21	64.2	2.55	1.35	C22 type for pivot

mm

Rod End Nut

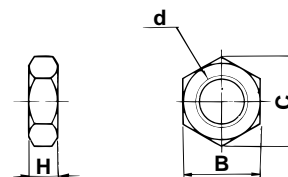

Material: Carbon steel

Part no.	Applicable bore size (mm)	d	H	B	C
NT-02	20	M8 x 1.25	5	13	15.0
NT-03	25	M10 x 1.25	6	17	19.6
NT-04	32, 40	M14 x 1.5	8	22	25.4
NT-05	50, 63	M18 x 1.5	11	27	31.2
NT-08	80	M22 x 1.5	13	32	37.0
NT-10	100	M26 x 1.5	16	41	47.3

mm

Simple Joint/ø32 to ø100

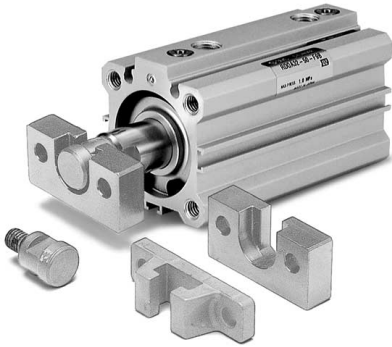

A type mounting bracket

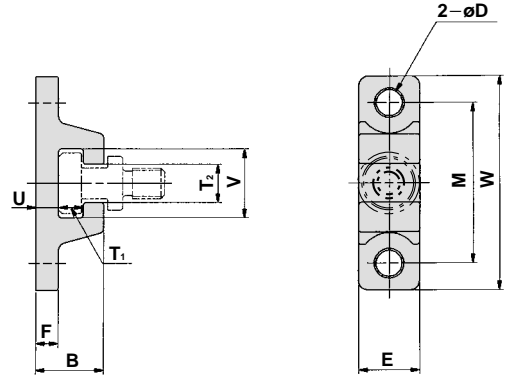

Material: Chrome molybdenum steel (nickel plated)
mm

Joint and mounting bracket (A type, B type) part no.

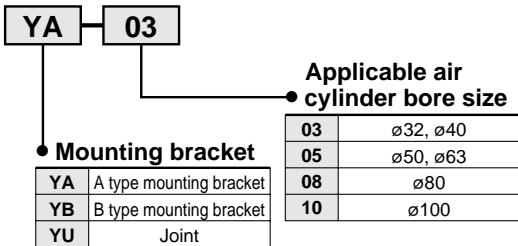

Part no.	Bore size (mm)	B	D	E	F	M	T ₁	T ₂
YA-03	32, 40	18	6.8	16	6	42	6.5	10
YA-05	50, 63	20	9	20	8	50	6.5	12
YA-08	80	26	11	25	10	62	8.5	16
YA-10	100	31	14	30	12	76	10.5	18

Part no.	Bore size (mm)	U	V	W	Weight (g)
YA-03	32, 40	6	18	56	55
YA-05	50, 63	8	22	67	100
YA-08	80	10	28	83	195
YA-10	100	12	36	100	340

Allowable eccentricity

Bore size	32	40	50	63	80	100
Eccentricity tolerance	±1			±1.5		±2
Backlash	0.5					

<Ordering method>

- Joints are not included with A type and B type mounting brackets. Order them separately.

(Example)

Bore size ø40 Part number

- A type mounting bracket YA-03
- Joint YU-03

Joint part no.

Bore size (mm)	Joint	Applicable mounting bracket		Weight (g)
		A type mounting bracket	B type mounting bracket	
32, 40	YU-03	YA-03	YB-03	25
50, 63	YU-05	YA-05	YB-05	40
80	YU-08	YA-08	YB-08	90
100	YU-10	YA-10	YB-10	160

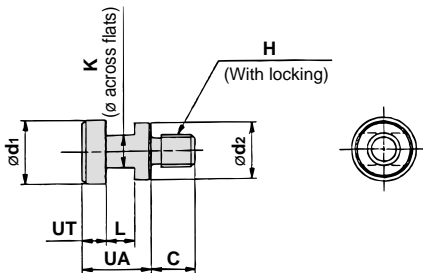

Material: Chrome molybdenum steel (nickel plated)

Part no.	Applicable bore size (mm)	UA	C	d ₁	d ₂	H	K	L	UT	Weight (g)
YU-03	32, 40	17	11	15.8	14	M8 x 1.25	8	7	6	25
YU-05	50, 63	17	13	19.8	18	M10 x 1.5	10	7	6	40
YU-08	80	22	20	24.8	23	M16 x 2	13	9	8	90
YU-10	100	26	26	29.8	28	M20 x 2.5	14	11	10	160

B type mounting bracket

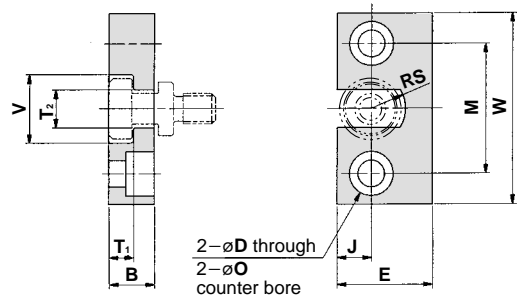

Material: Carbon steel (nickel plated)
mm

Part no.	Bore size (mm)	B	D	E	J	M	O
YB-03	32, 40	12	7	25	9	34	11.5 depth 7.5
YB-05	50, 63	12	9	32	11	42	14.5 depth 8.5
YB-08	80	16	11	38	13	52	18 depth 12
YB-10	100	19	14	50	17	62	21 depth 14

Part no.	Bore size (mm)	T ₁	T ₂	V	W	RS	Weight (g)
YB-03	32, 40	6.5	10	18	50	9	80
YB-05	50, 63	6.5	12	22	60	11	120
YB-08	80	8.5	16	28	75	14	230
YB-10	100	10.5	18	36	90	18	455