

# 3 Port Pilot Operated Solenoid Valve Rubber Seal Series SYJ300

## Base Mounted (With sub-plate)

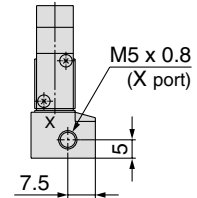

Grommet (G), (H): SYJ3□4-□□□□-M5

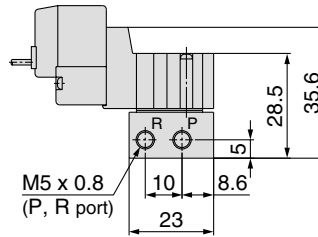
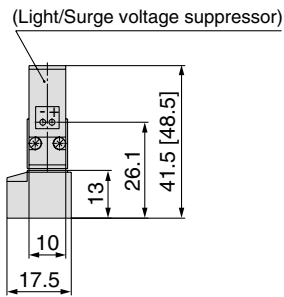
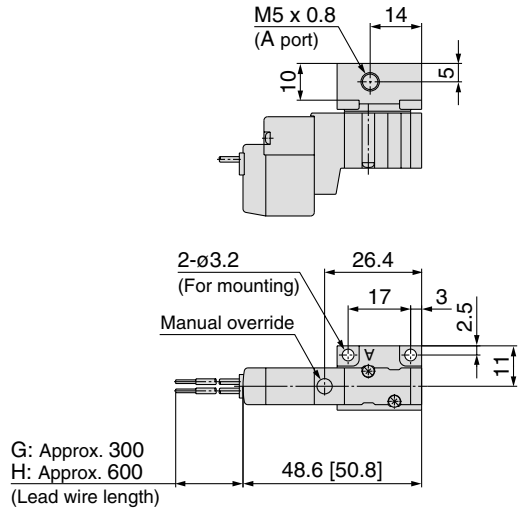

L plug connector (L):  
SYJ3□4-□L□□-M5

M plug connector (M):  
SYJ3□4-□M□□-M5

M8 connector (WO):  
SYJ3□4-□WO□□-M5

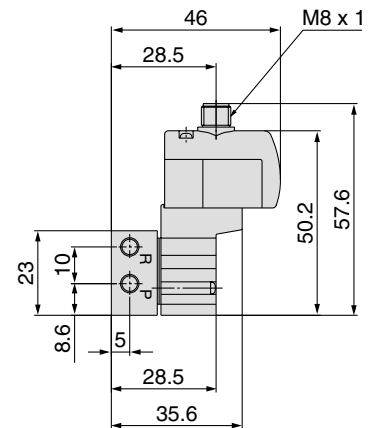
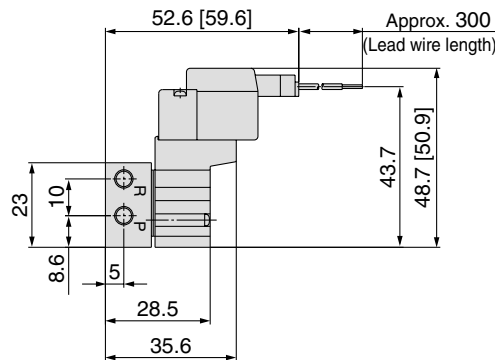
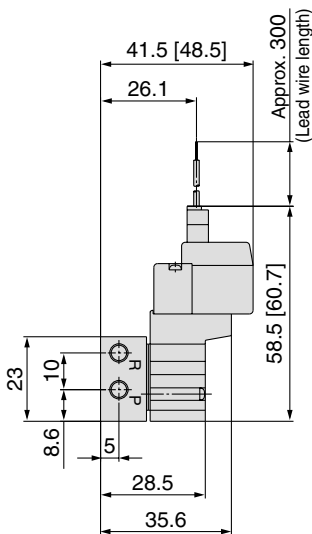

\* Refer to page 4-4-61 for dimensions with connector cable.

V100

SY

**SYJ**

VK

VZ

VT

VP

VG

VP

S070

VQ

VKF

VQZ

VZ

VS

VFN

# Series SYJ300 Manifold Specifications

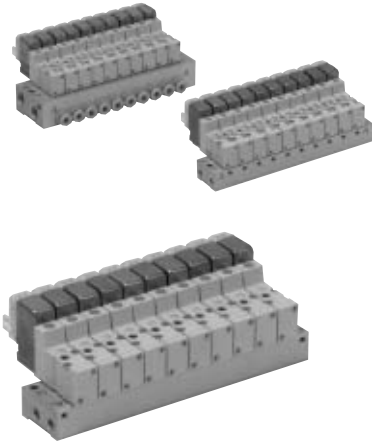

## Manifold Specifications

Model	For internal pilot	Type 20	Type 41, S41	Type 42, S42
	For external pilot	Type 20R	—	Type 42R, S42R
Manifold type	Single base/B mount			
P (SUP), R (EXH)	Common SUP/Common EXH			
Valve stations	2 to 20 stations			
A port Porting specifications	Location	Valve	Base	
	Direction	Top	Side	
Port size	P, R port	M5 x 0.8 1/8	M5 x 0.8	1/8
		A port	M3 x 0.5	M3 x 0.5
	X port <sup>Note)</sup>	M5 x 0.8	—	M5 x 0.8

Note) Only for external pilot

## Flow Characteristics

Manifold			Port size		Flow characteristics						Effective area (mm <sup>2</sup> )
					1 → 2 (P → A)			2 → 3 (A → R)			
					C [dm <sup>3</sup> /(s bar)]	b	Cv	C [dm <sup>3</sup> /(s bar)]	b	Cv	
Body ported for internal pilot	Type SS3YJ3-20	SYJ3□2	M5 x 0.8	M3 x 0.5	—	—	—	—	—	—	0.9
	Type SS3YJ3-41 S41	SYJ3□4	M5 x 0.8	M3 x 0.5	—	—	—	—	—	—	1.5
Base mounted for internal pilot	Type SS3YJ3-42-M5	SYJ3□4	1/8	M5 x 0.8	0.31	0.17	0.075	0.32	0.11	0.072	—
	Type SS3YJ3-42-C4			C4	0.33	0.36	0.086	0.33	0.2	0.082	—
	Type SS3YJ3-S42-M5	SYJ3□4	1/8	M5 x 0.8	0.32	0.3	0.079	0.33	0.35	0.086	—
	Type SS3YJ3-S42-C4			C4	0.35	0.17	0.082	0.35	0.26	0.086	—
Body ported for external pilot	Type SS3YJ3-20R	SYJ3□2R	1/8	M3 x 0.5	—	—	—	—	—	—	0.9
Base mounted for external pilot	Type SS3YJ3-42R-M5	SYJ3□4R	1/8	M5 x 0.8	0.31	0.17	0.075	0.32	0.11	0.072	—
	Type SS3YJ3-42R-C4			C4	0.33	0.36	0.086	0.33	0.20	0.082	—
	Type SS3YJ3-S42R-M5	SYJ3□4R	1/8	M5 x 0.8	0.32	0.30	0.079	0.33	0.35	0.086	—
	Type SS3YJ3-S42R-C4			C4	0.35	0.17	0.082	0.35	0.26	0.086	—

Note) Value at manifold base mounted, 2 position single acting

## How to Order Manifold (Example)

Instruct by specifying the valves and blanking plate assembly to be mounted on the manifold along with the manifold base model no.

Example:

- SS3YJ3-20-03.....1 set (Manifold base)
- SS3YJ3-42R-03-C4 .....1 set (Manifold base)
- \* SYJ312-5LZ-M3.....2 sets (Valve)
- \* SYJ314R-5G.....2 sets (Valve)
- \* SYJ300-10-1A.....1 set (Blanking plate assembly)
- \* SYJ300-10-2A.....1 set (Blanking plate assembly)

↳ The asterisk denotes the symbol for assembly. Prefix it to the part nos. of the solenoid valve, etc.

# 3 Port Pilot Operated Solenoid Valve Rubber Seal Series SYJ300

## Combinations of Solenoid Valve, Manifold Gasket and Manifold Base

**Body ported  
(Type SYJ3□2(R))**

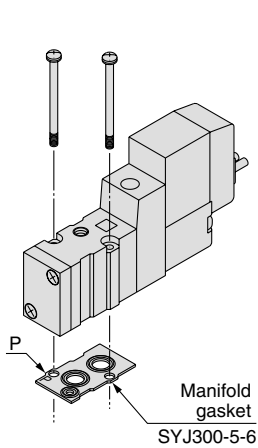

**Applicable base**  
SS3YJ3-20 | Manifold  
SS3YJ3-20R | base

**Base mounted  
(Type SYJ3□4(R))**

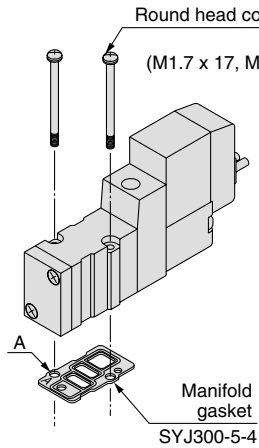

**Applicable base**  
**Sub-plate**  
SS3YJ3-41  
SS3YJ3-S41  
SS3YJ3-42  
SS3YJ3-S42  
SS3YJ3-42R  
SS3YJ3-S42R } Manifold  
base

## Blanking Plate Assembly

**Part no.: SYJ300-10-1A**

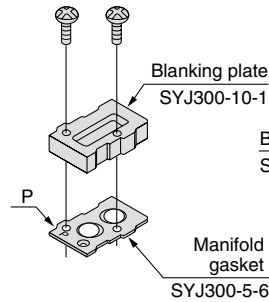

**Applicable base**  
SS3YJ3-20 | Manifold  
SS3YJ3-20R | base

**Part no.: SYJ300-10-2A**

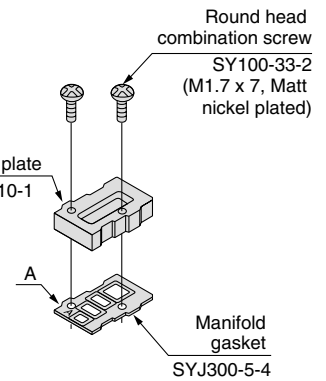

**Applicable base**  
**Sub-plate**  
SS3YJ3-41  
SS3YJ3-S41  
SS3YJ3-42  
SS3YJ3-S42  
SS3YJ3-42R  
SS3YJ3-S42R } Manifold  
base

### ⚠ Caution

**Mounting Screw Tightening Torques**

**M1.7: 0.12 N·m**

**Use caution to the assembly orientation for solenoid valves, gasket, and optional parts.**

V100

SY

**SYJ**

VK

VZ

VT

VP

VG

VP

S070

VQ

VKF

VQZ

VZ

VS

VFN

# Series SYJ300

## Manifold for Internal Pilot Type

### Type 20

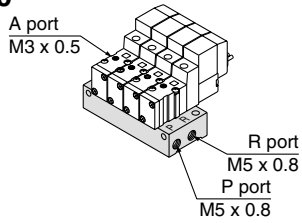

#### How to Order

SS3YJ3-20-05-□

Stations	
02	2 stations
:	:
20	20 stations

Bracket	
Nil	Without bracket
F	With bracket

**Applicable solenoid valve**  
 SYJ312-□□□□-M3  
 SYJ312M-□□□□-M3  
 SYJ322-□□□□-M3  
 SYJ322M-□□□□-M3

**Applicable blanking plate assembly**  
 SYJ300-10-1A

Note) For more than 10 stations, supply air to both sides of P port and exhaust air from both sides of R port.

### Type 41

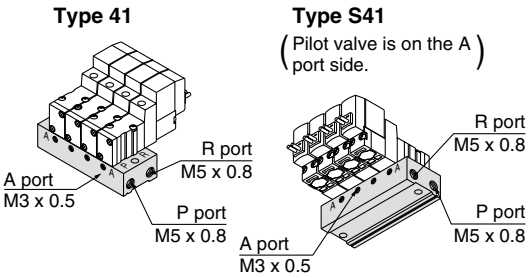

#### How to Order

SS3YJ3-□41-05-M3

Valve mounting direction	
Nil	Pilot valve is opposite the A port side.
S	Pilot valve is on the A port side.

Stations	
02	2 stations
:	:
20	20 stations

**Applicable solenoid valve**  
 SYJ314-□□□□  
 SYJ314M-□□□□  
 SYJ324-□□□□  
 SYJ324M-□□□□

**Applicable blanking plate assembly**  
 SYJ300-10-2A

Note) For more than 10 stations, supply air to both sides of P port and exhaust air from both sides of R port.

### Type 42

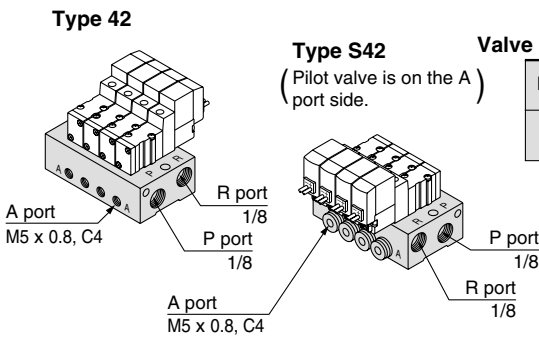

#### How to Order

SS3YJ3-□42-05-M5-□

Valve mounting direction	
Nil	Pilot valve is opposite the A port side.
S	Pilot valve is on the A port side.

Stations	
02	2 stations
:	:
20	20 stations

A port size	
M5	M5 x 0.8
C4	ø4 One-touch fitting
N3	ø5/32" One-touch fitting

**Applicable solenoid valve**  
 SYJ314-□□□□  
 SYJ314M-□□□□  
 SYJ324-□□□□  
 SYJ324M-□□□□

**Applicable blanking plate assembly**  
 SYJ300-10-2A

P, R port thread type	
Nil	Rc
F	G
N	NPT
T	NPTF

Note) For more than 8 stations, supply/exhaust air to/from both sides of P port and R port.

## Manifold for External Pilot Type

Pilot valve pressure is supplied separately from the main valve pressure through the use of a separate supply port. It can be used in the vacuum (up to -100 kPa) or low pressure line with 0.15 MPa or less.

### Type 20R

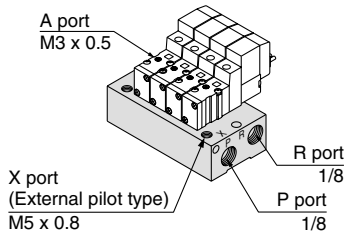

#### How to Order

SS3YJ3-20R-05-□

Stations	
02	2 stations
:	:
20	20 stations

P, R port thread type	
Nil	Rc
00F	G
00N	NPT
00T	NPTF

**Applicable solenoid valve**  
 SYJ312R-□□□□  
 SYJ322R-□□□□

**Applicable blanking plate assembly**  
 SYJ300-10-1A

Note) For more than 10 stations, supply/exhaust air to/from both sides of P port and R port.

### Type 42R

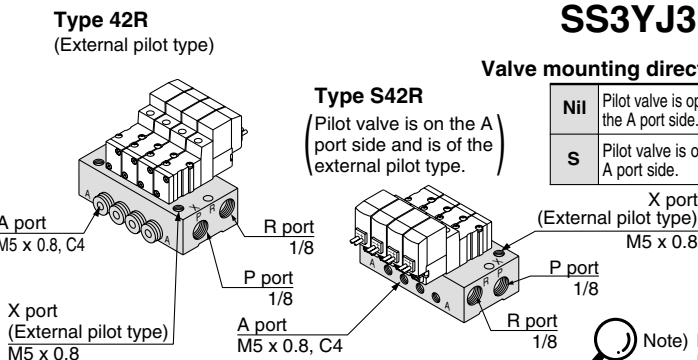

#### How to Order

SS3YJ3-□42R-05-M5-□

Valve mounting direction	
Nil	Pilot valve is opposite the A port side.
S	Pilot valve is on the A port side.

Stations	
02	2 stations
:	:
20	20 stations

A port size	
M5	M5 x 0.8
C4	ø4 One-touch fitting
N3	ø5/32" One-touch fitting

**Applicable solenoid valve**  
 SYJ314R-□□□□  
 SYJ324R-□□□□

**Applicable blanking plate assembly**  
 SYJ300-10-2A

P, R port thread type	
Nil	Rc
F	G
N	NPT
T	NPTF

Note) For more than 8 stations, supply/exhaust air to/from both sides of P port and R port.



# Series SYJ300

## Type 41 Manifold: Side Ported/SS3YJ3-41- Stations -M3



### Grommet (G)

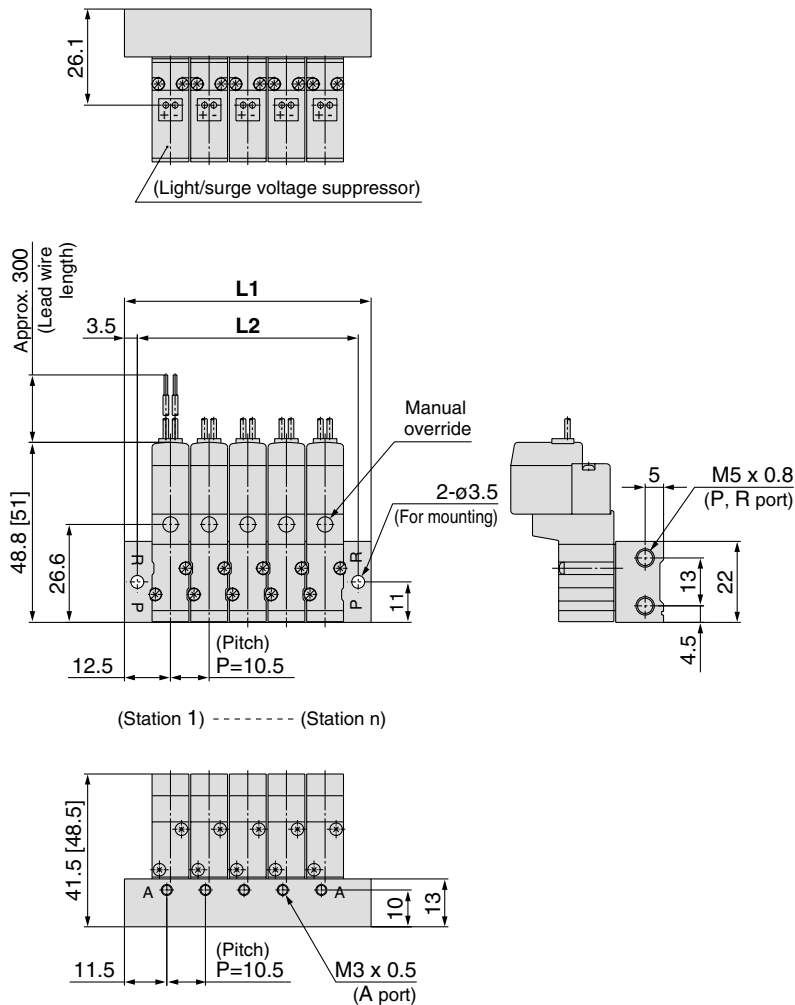

### Type 41 Manifold: Side Ported

(Pilot valve is on the A port side) /

### SS3YJ3-S41- Stations -M3

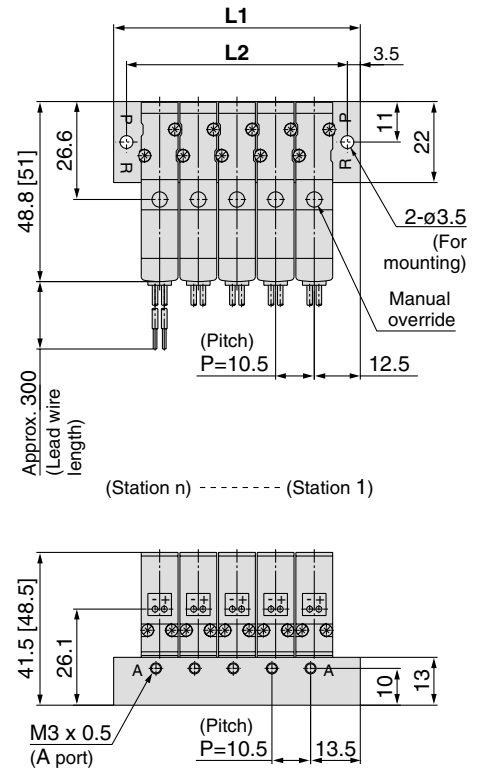

### L plug connector (L)

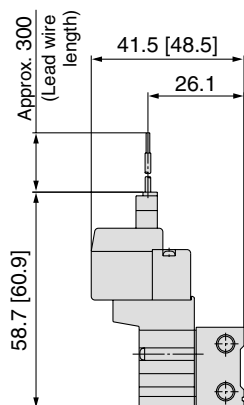

### M plug connector (M)

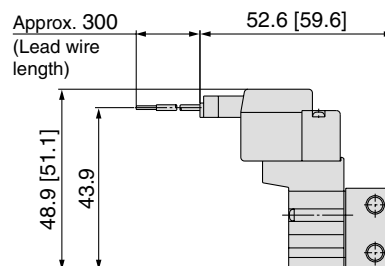

### M8 connector (WO)

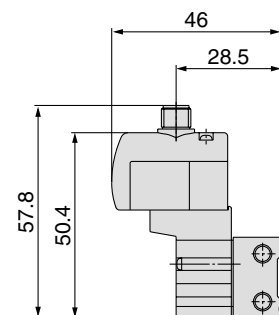

\* Refer to page 4-4-61 for dimensions with connector cable.

Station n	Station 2	3	4	5	6	7	8	9	10	11	12	13	14	15	16	17	18	19	Station 20
L1	35.5	46	56.5	67	77.5	88	98.5	109	119.5	130	140.5	151	161.5	172	182.5	193	203.5	214	224.5
L2	28.5	39	49.5	60	70.5	81	91.5	102	112.5	123	133.5	144	154.5	165	175.5	186	196.5	207	217.5

# 3 Port Pilot Operated Solenoid Valve Rubber Seal Series SYJ300

Type 42 Manifold: Side Ported/SS3YJ3-42- Stations -M5, C4 N3



**Grommet (G)**  
For M5

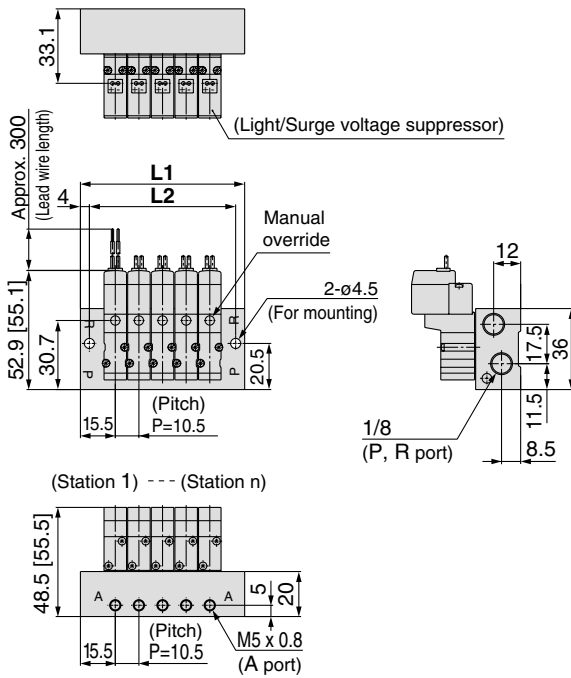

For C4 N3  (Built-in One-touch fitting)

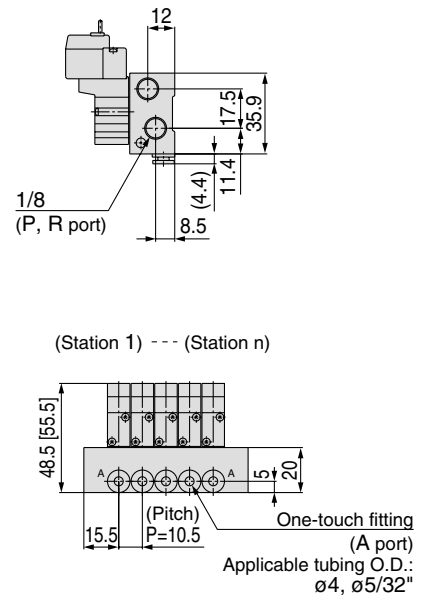

**L plug connector (L)**

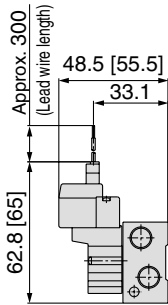

**M plug connector (M)**

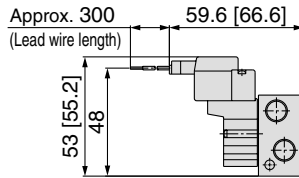

**M8 connector (WO)**

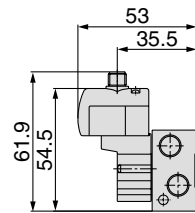

\* Refer to page 4-4-61 for dimensions with connector cable.

Type 42 Manifold: Side Ported (Pilot valve is on the A port side)/SS3YJ3-S42- Stations -M5, C4 N3

**Grommet (G)**  
For M5

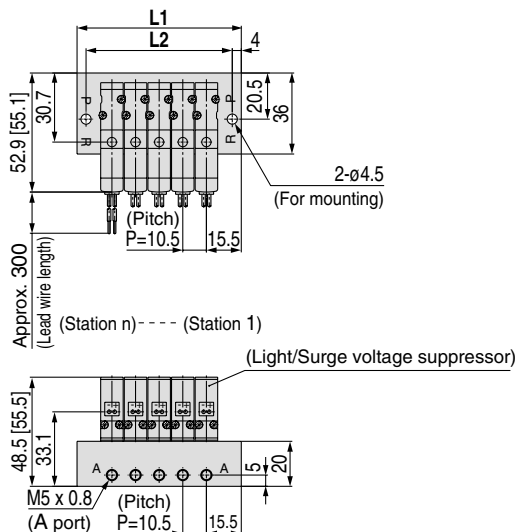

For C4 N3  (Built-in One-touch fitting)

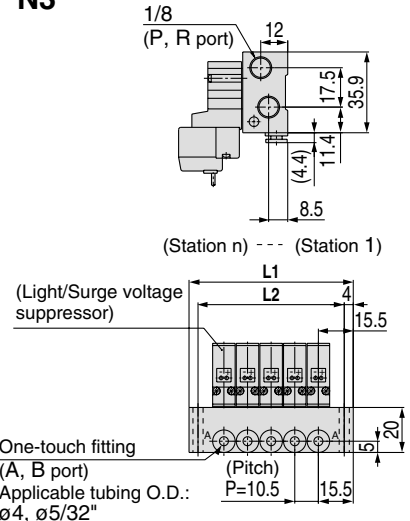

Station n	Station 2	3	4	5	6	7	8	9	10	11	12	13	14	15	16	17	18	19	Station 20
<b>L1</b>	41.5	52	62.5	73	83.5	94	104.5	115	125.5	136	146.5	157	167.5	178	188.5	199	209.5	220	230.5
<b>L2</b>	33.5	44	54.5	65	75.5	86	96.5	107	117.5	128	138.5	149	159.5	170	180.5	191	201.5	212	222.5

- V100
- SY
- SYJ**
- VK
- VZ
- VT
- VP
- VG
- VP
- S070
- VQ
- VKF
- VQZ
- VZ
- VS
- VFN

# Series SYJ300

Type 20R Manifold: Top Ported (External Pilot Type)/SS3YJ3-20R- **Stations -00** □

 \* [ ] for AC

## Grommet (G)

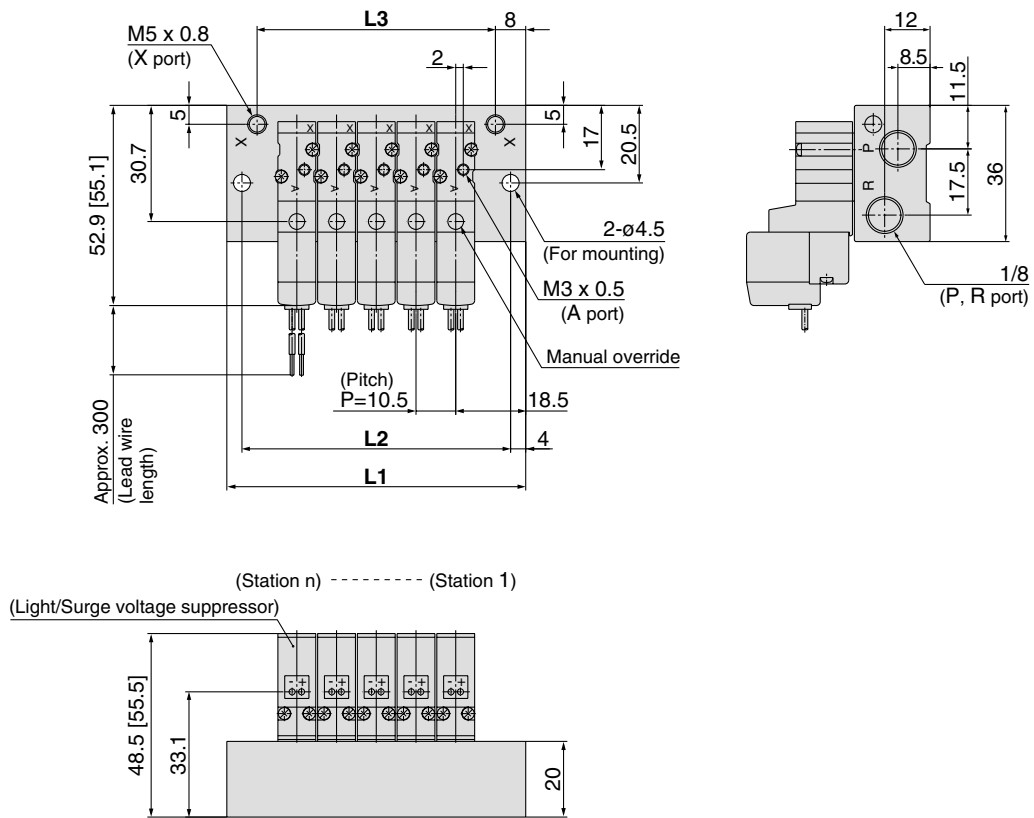

## L plug connector (L)

## M plug connector (M)

## M8 connector (WO)

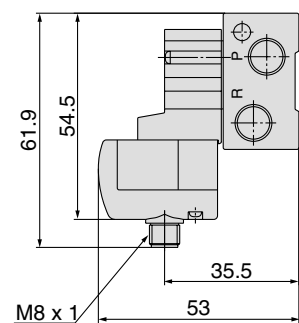
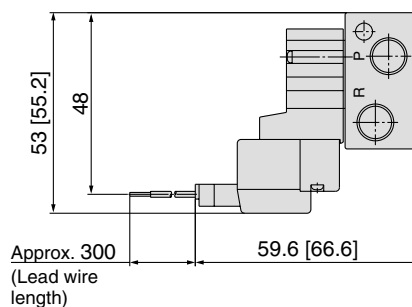
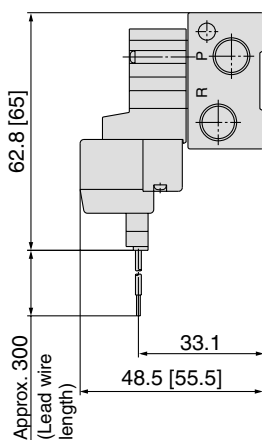

 \* Refer to page 4-4-61 for dimensions with connector cable.

Station n	Station 2	3	4	5	6	7	8	9	10	11	12	13	14	15	16	17	18	19	Station 20
<b>L1</b>	47.5	58	68.5	79	89.5	100	110.5	121	131.5	142	152.5	163	173.5	184	194.5	205	215.5	226	236.5
<b>L2</b>	39.5	50	60.5	71	81.5	92	102.5	113	123.5	134	144.5	155	165.5	176	186.5	197	207.5	218	228.5
<b>L3</b>	31.5	42	52.5	63	73.5	84	94.5	105	115.5	126	136.5	147	157.5	168	178.5	189	199.5	210	220.5



# 3 Port Pilot Operated Solenoid Valve Rubber Seal Series SYJ300

Type 42R Manifold: Side Ported (External Pilot Type)/SS3YJ3-42R- Stations -M5, C4  
N3 \* [ ] for AC

**Grommet (G)**  
For M5

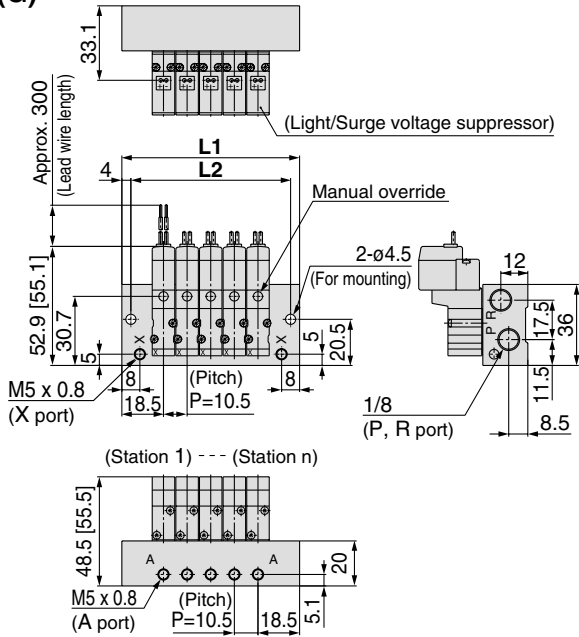

For C4  
N3 (Built-in One-touch fitting)

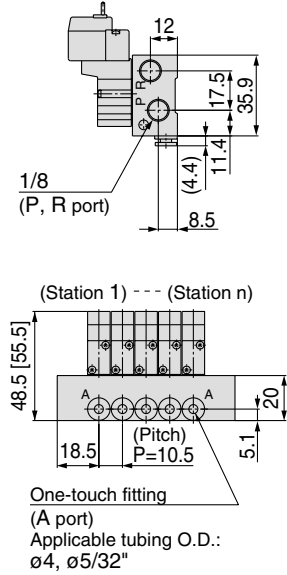

**L plug connector (L)**

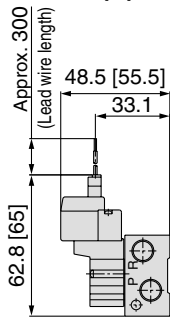

**M plug connector (M)**

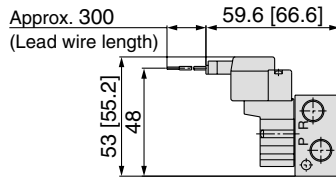

**M8 connector (WO)**

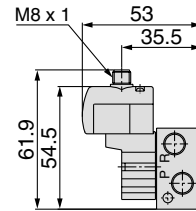

\* Refer to page 4-4-61 for dimensions with connector cable.

Type S42R Manifold: Side Ported (Pilot valve is on the A port side)/SS3YJ3-S42R- Stations -M5, C4  
N3

**Grommet (G)**  
For M5

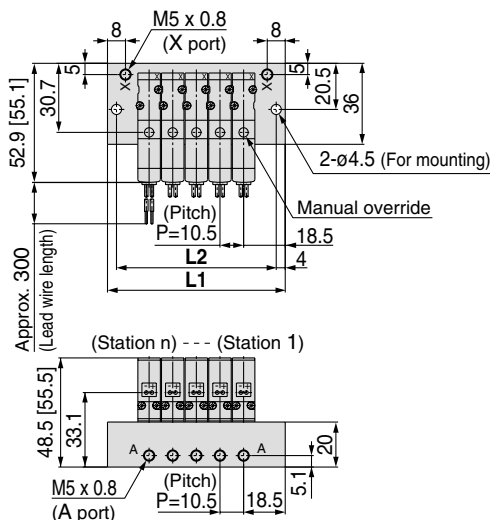

For C4  
N3 (Built-in One-touch fitting)

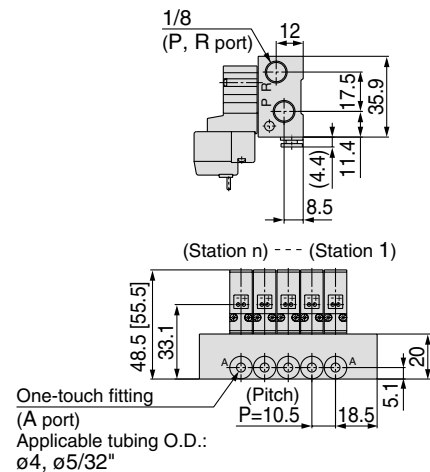

Station n	Station 2	3	4	5	6	7	8	9	10	11	12	13	14	15	16	17	18	19	Station 20
<b>L1</b>	47.5	58	68.5	79	89.5	100	110.5	121	131.5	142	152.5	163	173.5	184	194.5	205	215.5	226	236.5
<b>L2</b>	39.5	50	60.5	71	81.5	92	102.5	113	123.5	134	144.5	155	165.5	176	186.5	197	207.5	218	228.5

V100

SY

**SYJ**

VK

VZ

VT

VP

VG

VP

S070

VQ

VKF

VQZ

VZ

VS

VFN