

# Series VF5000

# Manifold Specifications

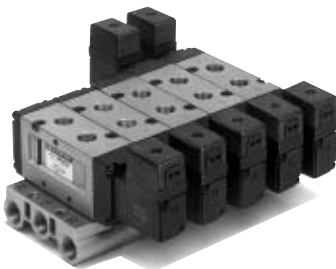

VV5F5-21



VV5F5-20

## Manifold Specifications

Manifold type	B mount (Single base type)
Exhaust port type	Common EXH
Max. number of stations*	10 (15 for 21 type w/side block)

\* For more than 5 stations for type 20 and 40 or more than 8 station for type 21, supply air from both sides of supply (P) port and exhaust air from both sides of exhaust (R) port.

Manifold base model	R (EXH) <sup>(1)</sup> port type	Piping/Port location			Port size Rc			Applicable <sup>(2)</sup> valves model
		P	R	A, B	P	R	A, B	
VV5F5-20	Common	Side Base	Side Base	Top Valve	3/8	3/8	1/4 3/8	VF5□20
VV5F5-21	Common	Side Side block	Side Side block	Top Valve	1/2	1/2	1/4 3/8	
VV5F5-40*	Common	Side Base	Side Base	Bottom Base	3/8	3/8	1/4	VF5□44

\* Its flow characteristics is 80% of that with sub-plate.

Note 1) P (SUP) port is all common.

Note 2) Model number for valve unit is that for application manifold.

## Option

Description	Part no.	Applicable manifold model
Individual EXH spacer assembly <sup>Note)</sup>	DXT156-20-1A	VV5F5-20/21
	DXT156-20-3A	VV5F5-40
Blanking plate assembly	DXT156-19-1A	VV5F5-20/21
	DXT156-19-2A	VV5F5-40

Note) Spacer is used when it is necessary to exhaust from certain valves individually.

## How to Order Manifold

Instruct by specifying the valves and blanking plate assembly to be mounted on the manifold along with the manifold base model no.

(Example) VV5F5-20-051..... 1 pc. (Manifold base)

\*VF5120-1G-03.....2 pcs. (Valve)

\*VF5220-1G-03.....2 pcs. (Valve)

\*DXT156-19-1A.....1 pc. (Blanking plate assembly)

The asterisk denotes the symbol for assembly. Prefix it to the part nos. of the solenoid valve, etc.

# 5 Port Pilot Operated Solenoid Valve Rubber Seal Series VF5000

## B Mount (Integrated type)

### Top ported/Common EXH type Type 20

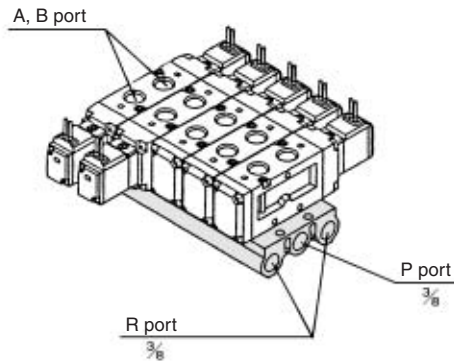

**VV5F5 - 20 - 05 1**

Stations	
02	2 stations
:	:
10	10 stations

**Applicable solenoid valve**  
VF5□20-□□□□- $\frac{02}{03}$ □  
**Applicable individual EXH spacer assembly**  
DXT156-20-1A  
**Applicable blanking plate assembly**  
DXT156-19-1A

### Top ported/Common EXH type Type 21

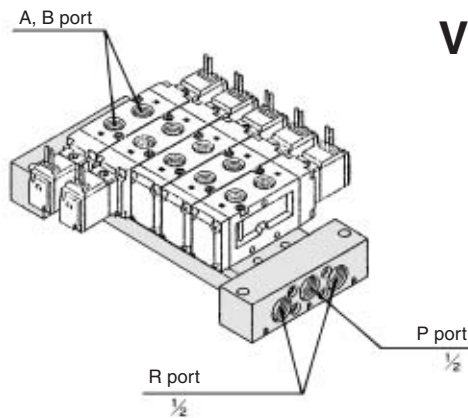

**VV5F5 - 21 - 05 1**

Stations	
02	2 stations
:	:
15	15 stations

**Applicable solenoid valve**  
VF5□20-□□□□- $\frac{02}{03}$ □  
**Applicable individual EXH spacer assembly**  
DXT156-20-1A  
**Applicable blanking plate assembly**  
DXT156-19-1A

### Bottom ported/Common EXH type Type 40

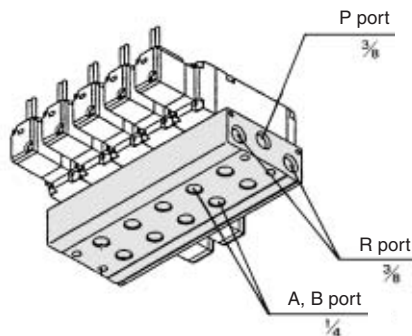

**VV5F5 - 40 - 05 2 - 02**

Stations	
02	2 stations
:	:
10	10 stations

**Applicable solenoid valve**  
VF5□44-□□□□  
**Applicable individual EXH spacer assembly**  
DXT156-20-3A  
**Applicable blanking plate assembly**  
DXT156-19-2A

VK

VZ

**VF**

VFR

VP4

VZS

VFS

VS4

VQ7

EVS

VFN

# Series VF5000

## Common EXH: VV5F5-20, VV5F5-21

### Common EXH: VV5F5-20-□□1

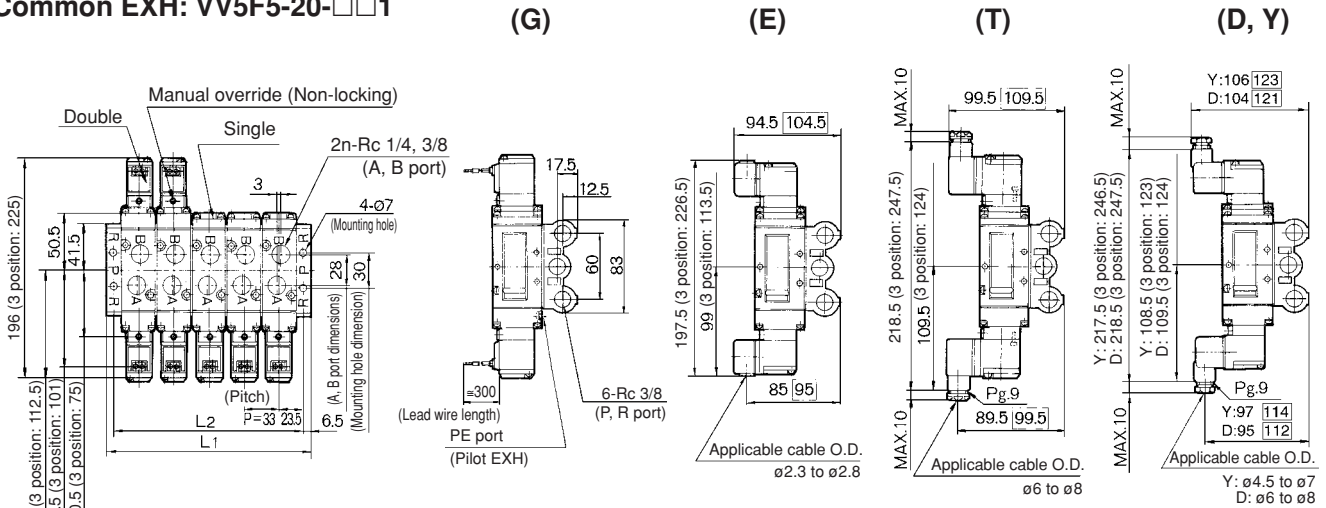

### Individual EXH spacer assembly

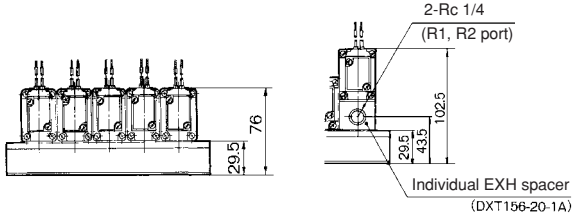

### L Dimension

L	n	n: Stations									
		2	3	4	5	6	7	8	9	10	
L <sub>1</sub>		93	126	159	192	225	258	291	324	357	
L <sub>2</sub>		80	113	146	179	212	245	278	311	344	



□ : With light/surge voltage suppressor

### Common EXH: VV5F5-21-□□1

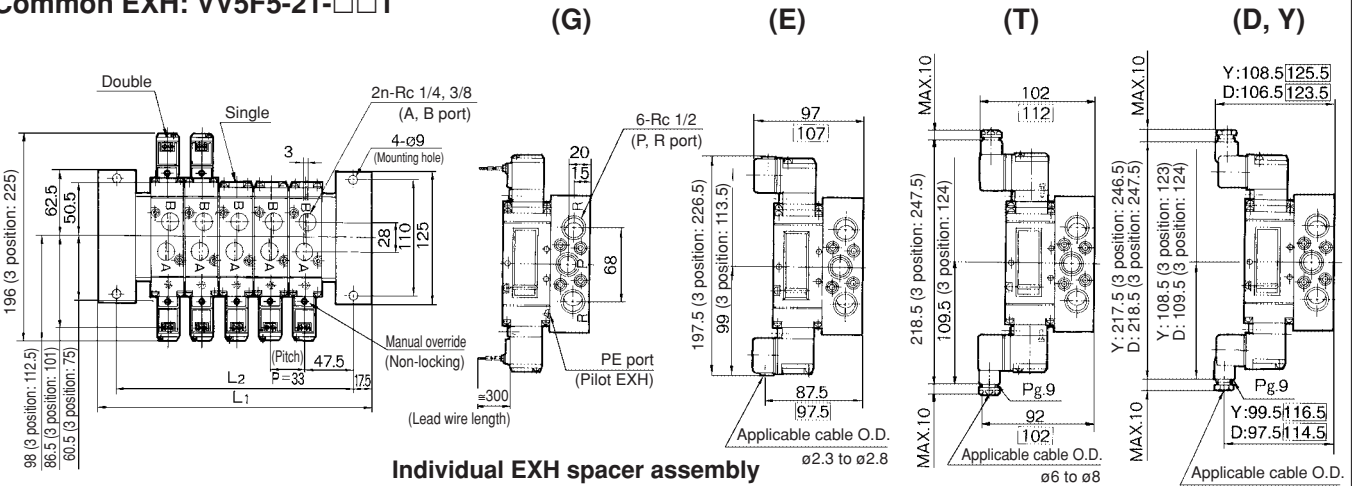

### Individual EXH spacer assembly

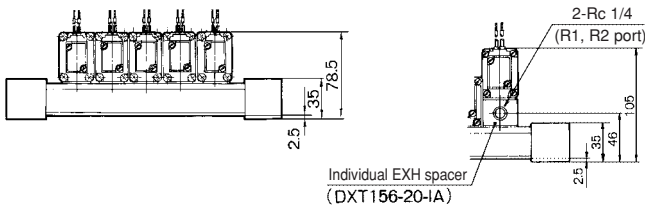

### L Dimension

L	n	n: Stations														
		2	3	4	5	6	7	8	9	10	11	12	13	14	15	
L <sub>1</sub>		163	196	229	262	295	328	361	394	427	460	493	526	559	592	
L <sub>2</sub>		128	161	194	227	260	293	326	359	392	425	458	491	524	557	



□ : With light/surge voltage suppressor

# 5 Port Pilot Operated Solenoid Valve Rubber Seal Series VF5000

Common EXH: VV5F5-40

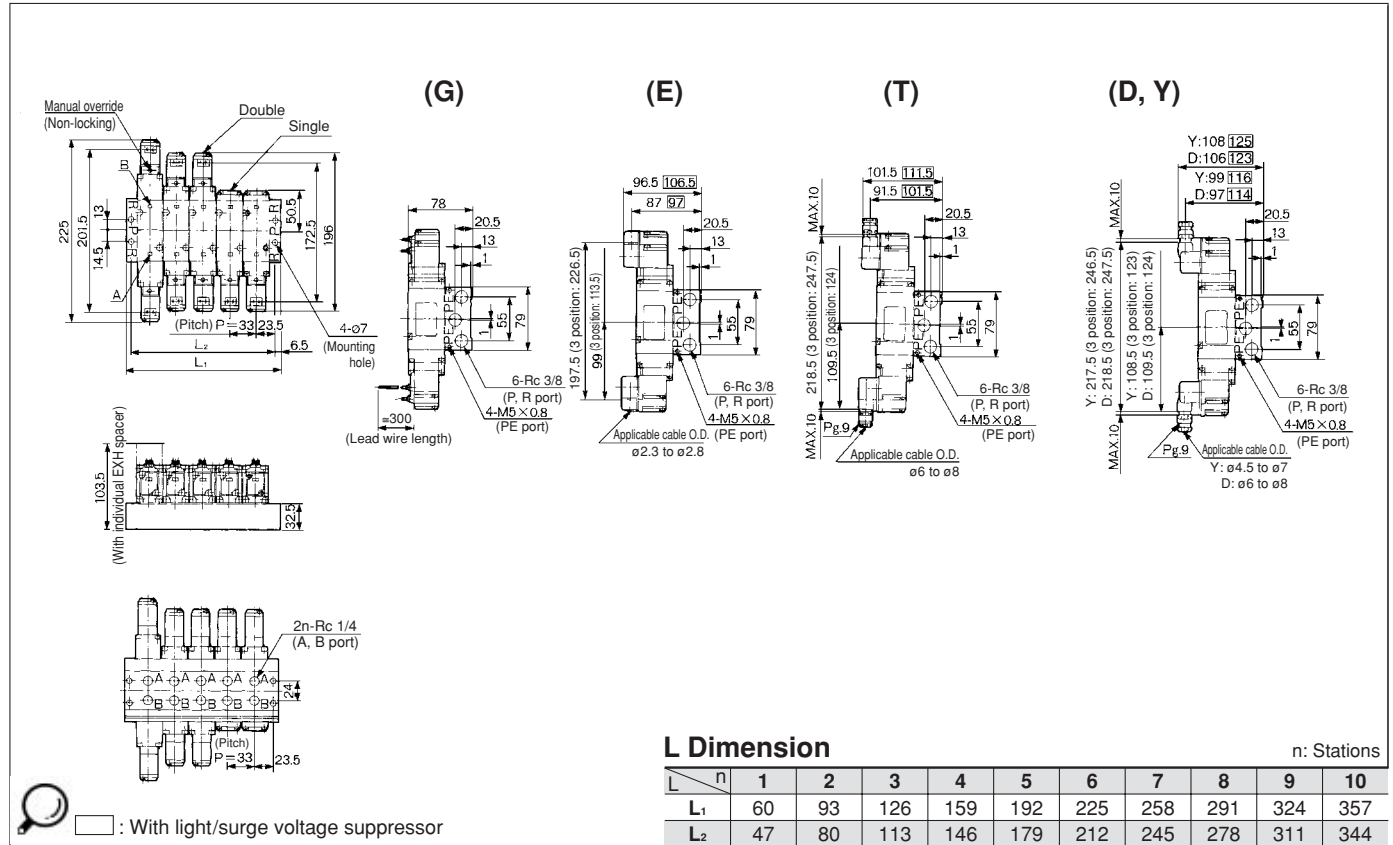

- VK
- VZ
- VF**
- VFR
- VP4
- VZS
- VFS
- VS4
- VQ7
- EVS
- VFN