

How to Order Manifold (VCA30/40)

VV2C A 3 02

For air ●

Series ●

3	Class 3
4	Class 4

● IN port direction

Nil	Side
A	Front

● Thread type

Nil	Rc
F	G
N	NPT
T	NPTF

● Stations ●

02	2 stations
⋮	⋮
10	10 stations



How to Order Manifold Assembly

Enter the mounting valve and option part numbers under the manifold base part number.

<Ordering Example>

VV2CA3-05 1 set Manifold part no.
* VCA35-5G-4-03 5 sets Valve part no.
(Stations 1 to 5)

"*" is the symbol for assembly. Add an "*" in front of the part numbers for solenoid valves, etc., to be mounted.

Enter together in order, counting from station 1 on the D side.

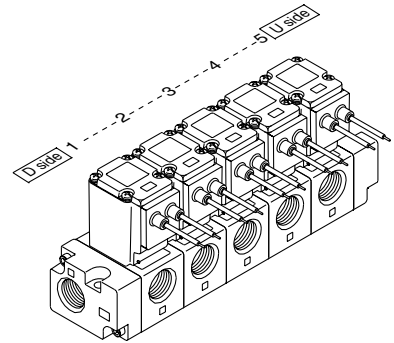

VC□

VDW

VQ

VX2

VX□

VX3

VXA

VN□

LVC

LVA

LVH

LVD

LVQ

LQ

LVN

TI/
TIL

PA

PAX

PB

How to Order Valves (VCA30/40)

VC A 3 5 1 G 4 03

For air ●

Series ●

3	Class 3
4	Class 4

● Valve type ●

5	N.C. for manifold
---	-------------------

● Fluid ●

Nil	General air
A	Dry air

● Voltage ●

1	100 VAC
2	200 VAC
3	110 VAC
4	220 VAC
5	24 VDC
6	12 VDC
36	230 VAC

* Please consult with SMC regarding other voltages.

● Thread type

Nil	Rc
F	G
N	NPT
T	NPTF

● Port size (OUT)

Symbol	Size	Class 3	Class 4
03	3/8 (10A)	○	—
04	1/2 (15A)	○	○
06	3/4 (20A)	—	○

● Orifice size

Symbol	Orifice size (mmø)	Class 3	Class 4
4	4	○	—
5	5	—	○
7	7	○	○
10	10	—	○

● Manual override

Nil	None
B	Slotted locking type (Tool required)

● Electrical entry

G	Grommet
C	Conduit
T	Conduit terminal
TL	Conduit terminal with indicator light
D	DIN terminal
DL	DIN terminal with indicator light
DO	DIN terminal (without connector)

* All types equipped with surge voltage suppressor.

Direct Operated 2 Port Solenoid Valve For Air Series VCA

Dimensions: VCA30/40 Manifold

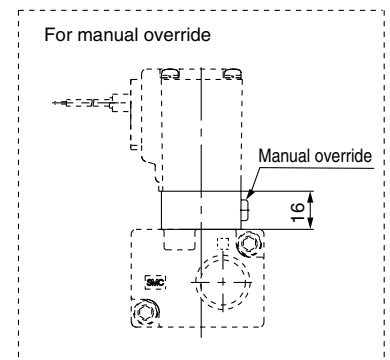
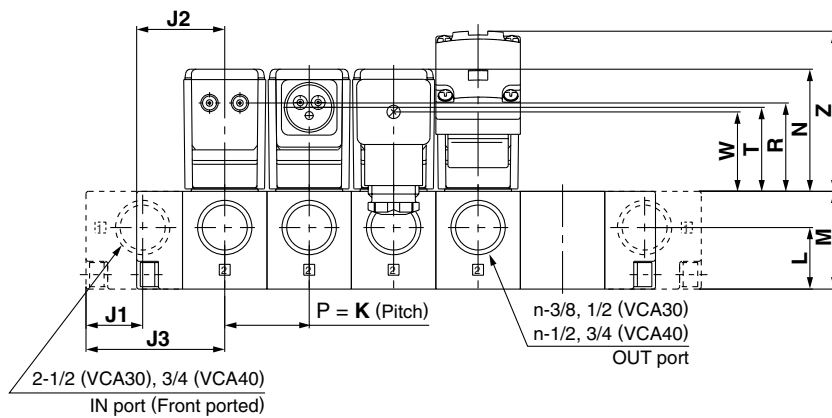
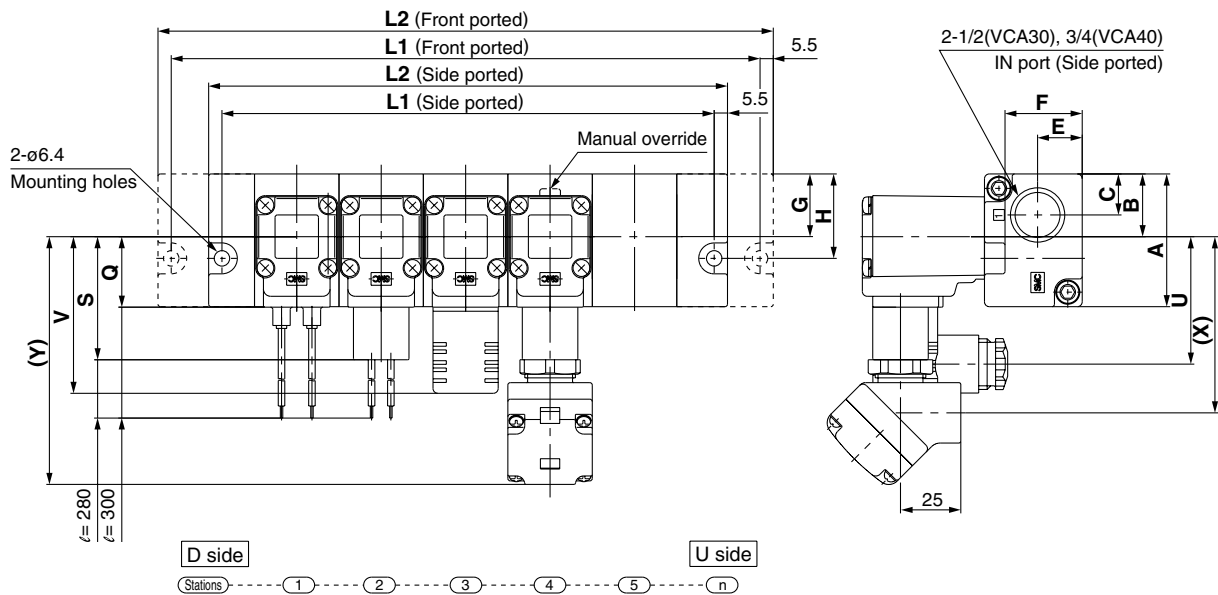

L Dimension

Model	IN port direction	Dimensions	n (stations)									
			2	3	4	5	6	7	8	9	10	
VV2CA3	Side ported	L1	103	138	173	208	243	278	313	348	383	
		L2	114	149	184	219	254	289	324	359	394	
	Front ported	L1	139	174	209	244	279	314	349	384	419	
		L2	150	185	220	255	290	325	360	395	430	
VV2CA4	Side ported	L1	117	158	199	240	281	322	363	404	445	
		L2	128	169	210	251	292	333	374	415	456	
	Front ported	L1	161	202	243	284	325	366	407	448	489	
		L2	172	213	254	295	336	377	418	459	500	

Formulas
 VV2CA3
 Side ported: L1 = n x 35 + 33, L2 = n x 35 + 44
 Front ported: L1 = n x 35 + 69, L2 = n x 35 + 80
 VV2CA4
 Side ported: L1 = n x 41 + 35, L2 = n x 41 + 46
 Front ported: L1 = n x 41 + 79, L2 = n x 41 + 90

Dimensions

Model	A	B	C	E	F	G	H	J1	J2	J3	K	L	M	N	Electrical entry									
															Grommet: G		Conduit: C		DIN terminal: D		Conduit terminal: T			
															Q	R	S	T	U	V	W	X	Y	Z
VV2CA3	55	26	17	19.5	33	26	35	23.5	39.5	57.5	35	26.5	41.5	50	30	36	50	32	54	66	30	71	101	65.5
VV2CA4	62	31	19	21	39.5	31	43	27	43.5	65.5	41	29	48	55	32	41	52	38	57	69	36	74	104	71

- VC□
- VDW
- VQ
- VX2
- VX□
- VX3
- VXA
- VN□
- LVC
- LVA
- LVH
- LVD
- LVQ
- LQ
- LVN
- TI/
TIL
- PA
- PAX
- PB

Series VCA

Manifold Exploded View

Series VCA20

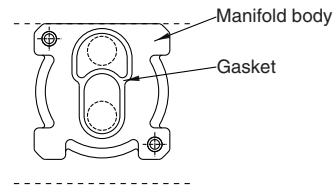
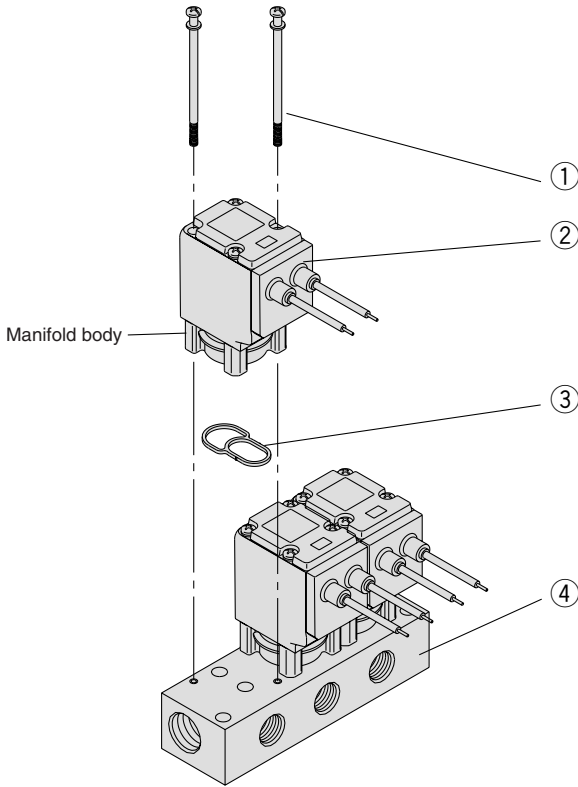

Manifold base A port side

Mounting orientation exists when mounting valves onto manifold base. Mount it as shown above.

No.	Part no.	Description	Material
①	M3 x 57	Cross-recessed head machine screw	Steel
②	VCA23□-□□□-□	Valve for manifold ⁽¹⁾	
③	VVCA20-3-1	Gasket	HNBR
④	VV2CA2-□□□-□	Manifold base	Aluminum

Note 1) Gasket ③ is included with manifold valve ②.

Series VCA30/40

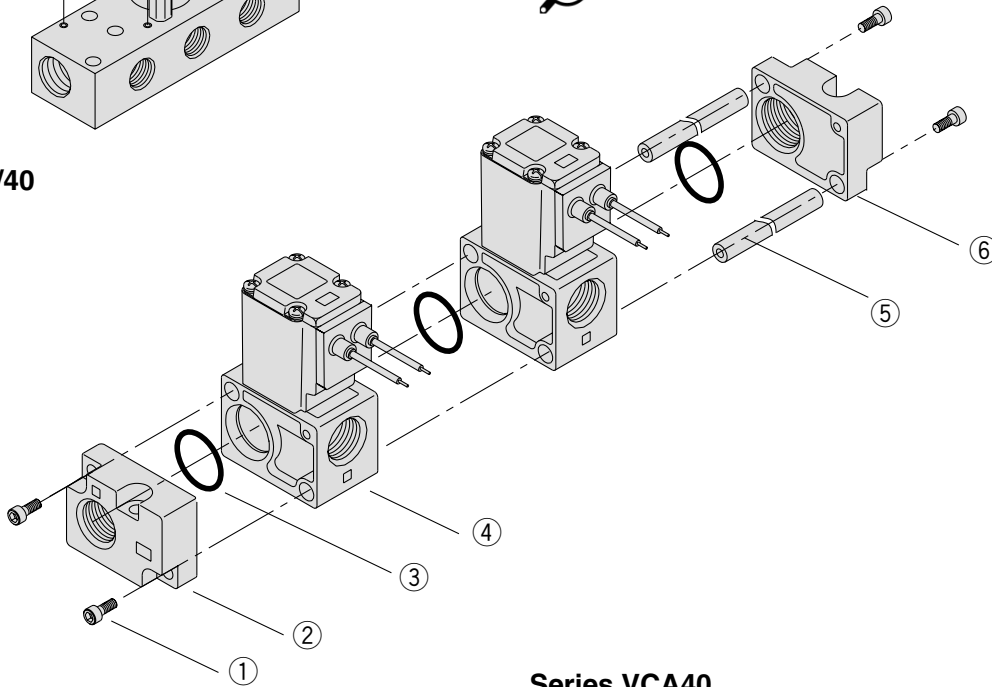

Series VCA30

No.	Part no.	Description	Material
①	AXT632-69-1	Mounting screw (side port)	Steel
	AXT632-69-2	Mounting screw (front port)	
②	VVCA30-3A-04-2	End plate assembly (D side, side port)	Aluminum
	VVCA30-3A-04-1	End plate assembly (D side, front port)	
③	OR-2200-200-H	O-ring (for VCA30)	HNBR
④	VCA35□-□□□-□□	Manifold valve ⁽²⁾	
⑤	VVCA30-6-n	Tie-rod	Steel
⑥	VVCA30-4A-04-2	End plate assembly (U side, side port)	Aluminum
	VVCA30-4A-04-1	End plate assembly (U side, front port)	

Note 2) O-ring ③ is included with manifold valve ④.

Series VCA40

No.	Part no.	Description	Material
①	AXT632-69-1	Mounting screw (side port)	Steel
	AXT632-69-2	Mounting screw (front port)	
②	VVCA40-3A-06-2	End plate assembly (D side, side port)	Aluminum
	VVCA40-3A-06-1	End plate assembly (D side, front port)	
③	OR-3200-200-H	O-ring (for VCA40)	HNBR
④	VCA45□-□□□-□□	Manifold valve ⁽²⁾	
⑤	VVCA40-6-n	Tie-rod	Steel
⑥	VVCA40-4A-06-2	End plate assembly (U side, side port)	Aluminum
	VVCA40-4A-06-1	End plate assembly (U side, front port)	

Note 2) O-ring ③ is included with manifold valve ④.

Manifold Option Parts

Blanking plate assembly (VCA20)

VVCA20 - 4A

This is used when a blanking plate is mounted on a manifold as preparation for a planned valve installation. (With gasket, 2 mounting screws)

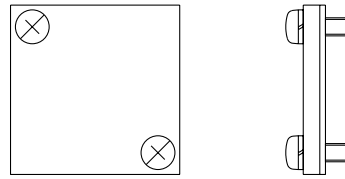

Blanking block assembly (VCA30, 40)

VVCA 3 0 - 2A - 00

3	Series VCA30
4	Series VCA40

This is used when a blanking plate is mounted on a manifold as preparation for a planned valve installation. (With O-ring)

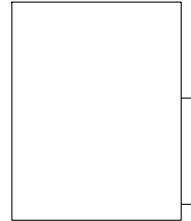

Tie-rod for additional stations (Set of 2 pcs for 1 station) (VCA30, 40)

VVCA 3 0 - 6 - 1A

3	Series VCA30
4	Series VCA40

Mounted on the tie-rod when adding one station.

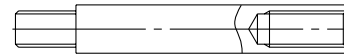

VC
VDW
VQ
VX2
VX
VX3
VXA
VN
LVC
LVA
LVH
LVD
LVQ
LQ
LVN
TI/ TIL
PA
PAX
PB