

DIN Rail Manifold

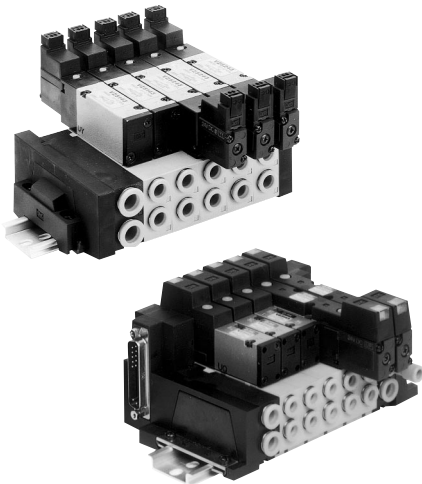

Specifications

Model		45 type	45F type
Manifold style		Stacking non plug-in	Stacking plug-in
P (SUP), R (EXH)		Common SUP and EXH	
Valve stations		2 to 20	
A, B port	Position	Base	
	Direction	Side	
Port size	P/R port	C8 (ø8 One-touch fitting)	
	A/B port	C4 (ø4 One-touch fitting) C6 (ø6 One-touch fitting)	
Valve effective area (mm ²) (Cv) ⁽¹⁾	VZ3□43	C4: 3.2 (0.18)	
		C6: 3.8 (0.21)	
Connector		—	MIL-C-24308 Applicable for D-sub connector JIS-X-5101
Internal wiring		—	COM ⁽²⁾

Note 1) Valve at manifold base mounted, 2 position single operating
 Note 2) It is available at +COM or -COM.

How to Order Manifold Base

To order valves and blank plate assembly and connector assembly mounted onto the manifold, list valves and blank plate assembly with manifold base.
 (Sample) VV5Z3-45FD-06-C6C1 pc. (Manifold base) VZ3243-5FZ3 pcs. (Valve)
 VZ3143-5FZ2 pcs. (Valve) VZ3000-69-1A1 pc. (Blank plate assembly)

- SY
- SYJ
- SX
- VK
- VZ
- VF
- VFR
- VP7
- VP4

DIN Rail Manifold

Common SUP/Common EXH

45 Type (Non plug-in)

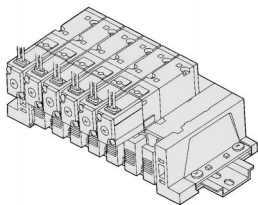

How to Order

VV5Z3 - 45 - 05 D - C6 C - []

Stations	
02	2 stations
⋮	⋮
20	20 stations

SUP/EXH block mounting position	
U	U side: 2 to 10stations
D	D side: 2 to 10stations
B	Both sides: 2 to 20stations
M*	Special specification

*For a special specification, use the manifold specification sheet or the like to provide instructions.

A, B port size	
C4	ø4 One-touch fitting
C6	ø6 One-touch fitting
M*	Mix

*For a special specification, use the manifold specification sheet or the like to provide

Applicable solenoid valve

VZ3□4□-□ $\begin{matrix} G \\ L \\ M \\ D \end{matrix}$ □ □
 VZ3□5□-□ $\begin{matrix} G \\ L \\ M \\ D \end{matrix}$ □ □

Applicable blank plate assembly

VZ3000-69-2A

DIN rail length

	Standard
—	Standard
3	For 3 stations Specify a rail that is longer than the standard length.
⋮	⋮
20	For 20

- VQ
- VQ4
- VQZ
- VQD
- VZS
- VFS
- VS
- VS7

45F Type (Plug-in)

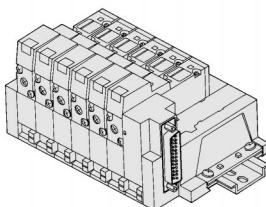

How to Order

VV5Z3 - 45F D - 05 [] - C6 C - []

Connector mount	
U	U side: 2 to 10stations
D	D side: 2 to 10stations
B	Both sides: 11 to 20stations

Stations	
02	2 stations
⋮	⋮
20	20 stations

SUP/EXH block mounting position	
—	2 to 10 stations: One side (Same as direction of connector mount) 11 to 20 stations: Both sides
B	2 to 10 stations: Both sides
M*	Special specification

*For a special specification, use the manifold specification

A, B port size	
C4	ø4 One-touch fitting
C6	ø6 One-touch fitting
M*	Mix

*For a mixed specification, use the manifold specification sheet or the like to provide instructions.

Applicable solenoid valve

VZ3□43-□ FZ □

Applicable blank plate assembly

VZ3000-69-1A

DIN rail length

	Standard
—	Standard
3	For 3 stations Specify a rail that is longer than the standard length.
⋮	⋮
20	For 20 stations

Option/DIN Rail Manifold

Blank Plate Assembly

VZ3000-69-2A

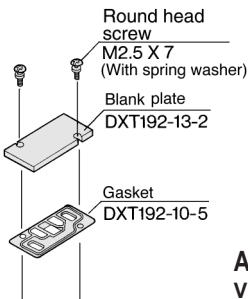

Applicable base
VV5Z3-45

Combinations of Solenoid Valve, Gasket and Manifold Base

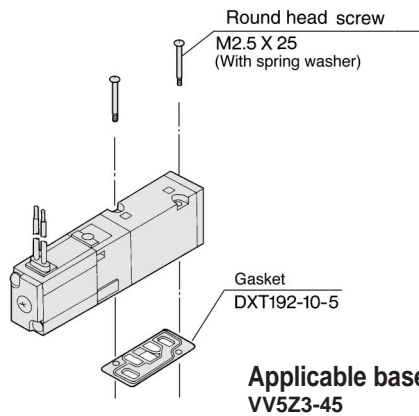

Applicable base
VV5Z3-45

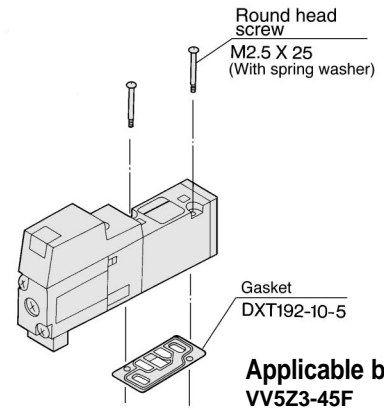

Applicable base
VV5Z3-45F

VZ3000-69-1A

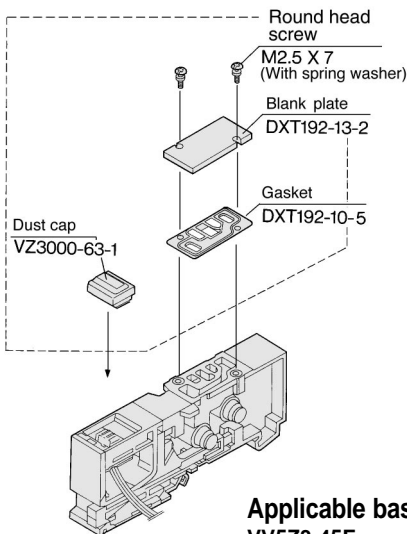

Applicable base
VV5Z3-45F

SUP Block Valve

By placing a SUP block valve in the pressure supply passage of the manifold base, two or more high or low pressures can be supplied by a single manifold.

VZ3000-79-1A



EXH Block Valve

By placing an EXH block valve in the exhaust passage of the manifold base, the exhaust air of the valve can be separated so as not to affect other valves.

VZ3000-79-1A



Applicable Plug Assembly (D-sub Connector Cable Assembly)

Cable length	Assembly No.	Component parts
1.5m	VVZS3000-21A-1	Applicable for plug MIL standard D-sub connector 25 pin Cable 25 core X 0.3mm ²
3m	VVZS3000-21A-2	
5m	VVZS3000-21A-3	
8m	VVZS3000-21A-4	

Refer to p.1.5-8 for detailed information.

SY

SYJ

SX

VK

VZ

VF

VFR

VP7

VP4

VQ

VQ4

VQZ

VQD

VZS

VFS

VS

VS7

Exploded View/DIN Rail Manifold

45F Type Manifold

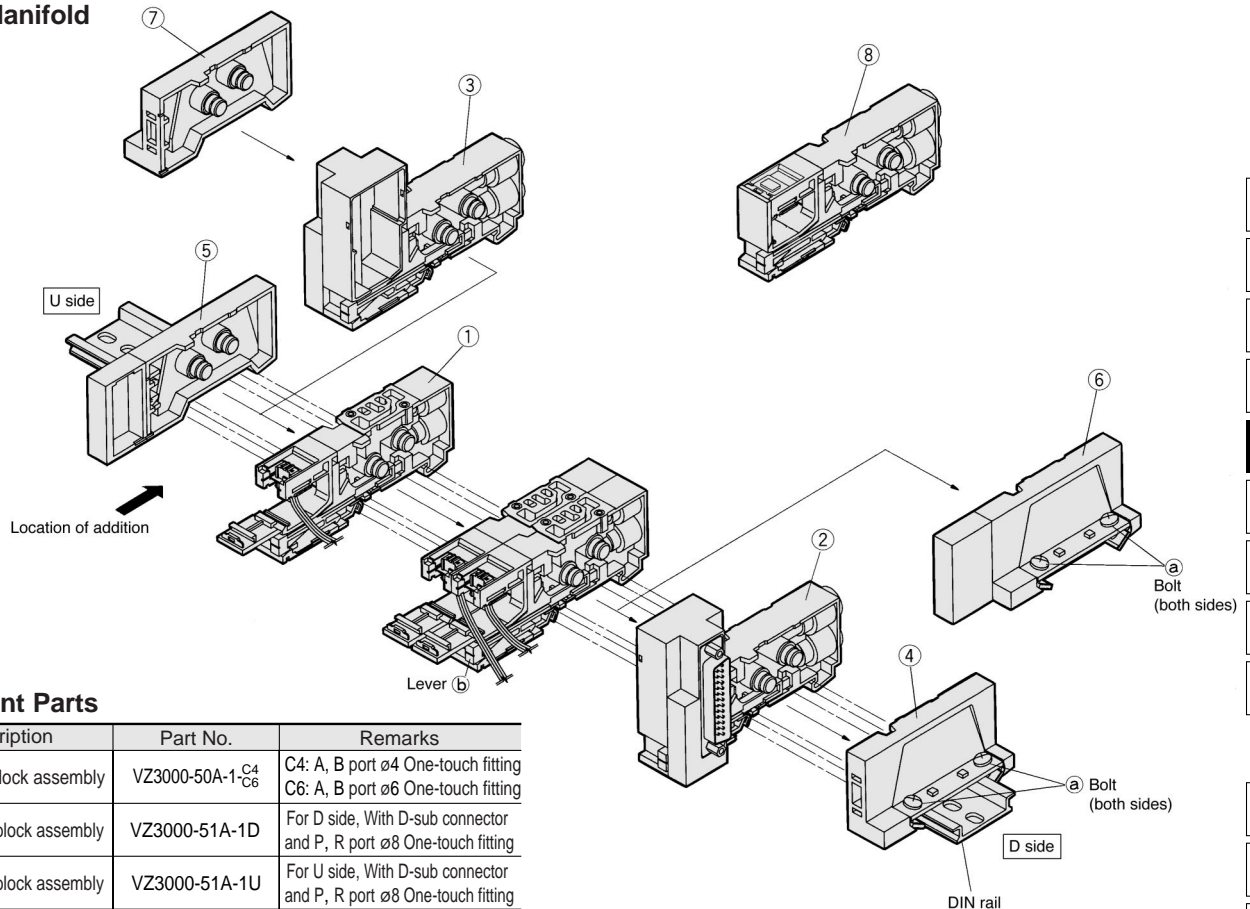

Replacement Parts

No.	Description	Part No.	Remarks
①	Manifold block assembly	VZ3000-50A-1-C ₄ C ₆	C4: A, B port $\phi 4$ One-touch fitting C6: A, B port $\phi 6$ One-touch fitting
②	SUP/EXH block assembly	VZ3000-51A-1D	For D side, With D-sub connector and P, R port $\phi 8$ One-touch fitting
③	SUP/EXH block assembly	VZ3000-51A-1U	For U side, With D-sub connector and P, R port $\phi 8$ One-touch fitting
④	End block assembly	VZ3000-52A-2D	For D side, set with ②
⑤	End block assembly	VZ3000-52A-1U	For U side
⑥	End block assembly	VZ3000-52A-1D	For D side
⑦	End block assembly	VZ3000-52A-2U	For U side, set with ③
⑧	SUP/EXH block assembly	VZ3000-51A-1M	Without D-sub connector For indicated location

SY

SYJ

SX

VK

VZ

VF

VFR

VP7

VP4

VQ

VQ4

VQZ

VQD

VZS

VFS

VS

VS7

How to Increase Manifold Base

To add a manifold block assembly, add it to the U side so that the terminal number of the D-sub connector and the valve link position will be in accordance with the circuit diagram.

- Loosen (both) bolts [a], which are securing the manifold onto the DIN rail, 1 to 2 turns. (To remove the manifold base from the DIN rail, loosen the bolts 4 to 5 turns.)
- Using a flat screwdriver, press lever [b] to disengage the link of the manifold block assembly on the U side or the D side from the supply/exhaust block assembly or from the end block assembly. (However, there are no levers between ⑤ and ①. They can be disconnected by merely pulling them apart.)
- Remove the housing cover from the D sub connector portion of the supply/exhaust block assembly. (Refer to Fig. 1.)
- Following the procedure shown in Fig. 2, mount the manifold block assembly to be added onto the DIN rail. As shown in Fig. 3, insert the pin of the lead wire assembly into the D sub connector, and attach the round crimped terminal to the screw that connects the wires.
- Press block ass'y and tighten bolt (a) to fix them to the DIN rail.

Note) • When there are 10 or fewer manifold block assemblies, and more are added to make a total of 11 or more, a supply/exhaust block assembly must also be added.

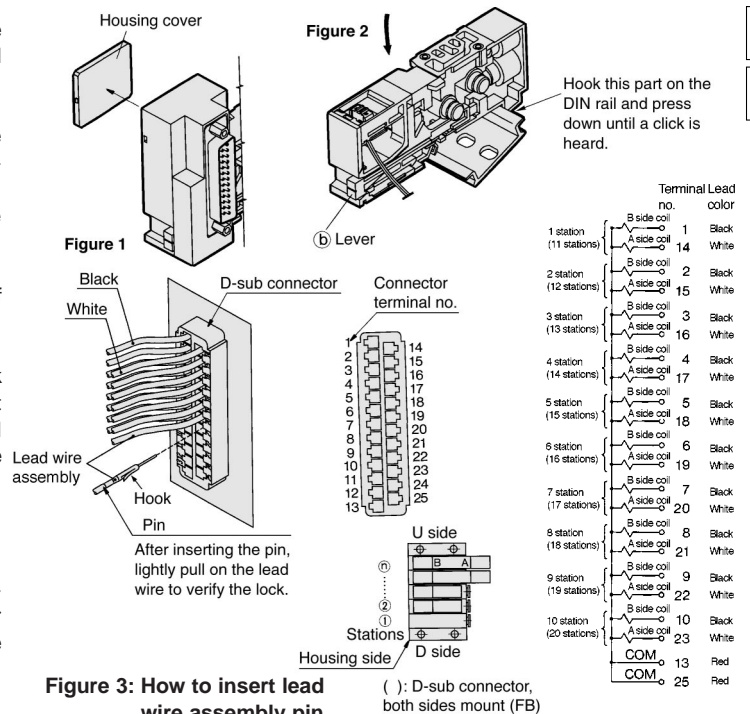
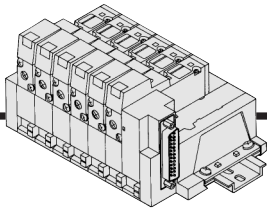

Figure 3: How to insert lead wire assembly

() : D-sub connector, both sides mount (FB)

VZ3000



45F Type DIN Rail Manifold (Plug-in): Side Ported

**VV5Z3-45FD-Station - C4C
C6C**

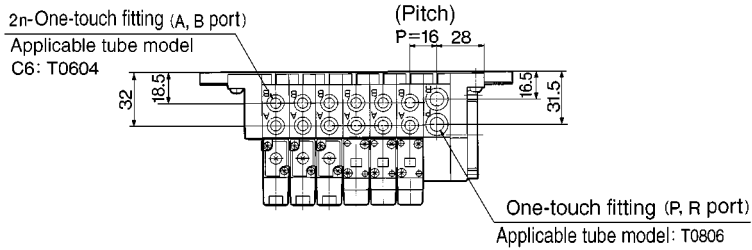

C4

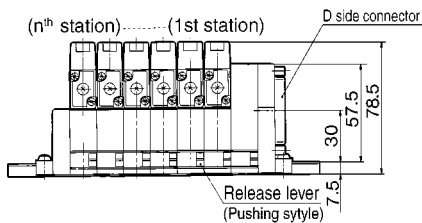
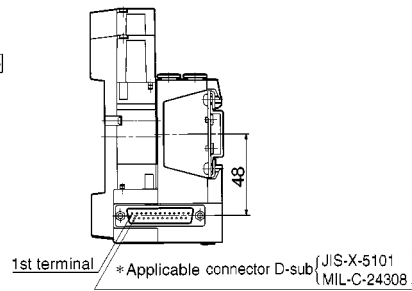
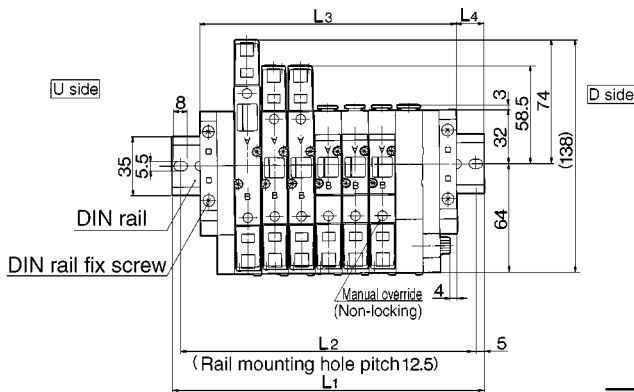
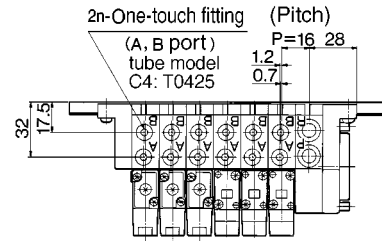

	(mm)									
Station	2	3	4	5	6	7	8	9	10	
L1	110.5	135.5	148	160.5	185.5	198	210.5	223	248	
L2	100	125	137.5	150	175	187.5	200	212.5	237.5	
L3	88	104	120	136	152	168	184	200	216	
L4	11.5	16	14	12.5	17	15	13.5	11.5	16	

**VV5Z3-45FU-Station B- C4C (2 to 10 stations)
C6C**

**VV5Z3-45FB-Station - C4C (11 to 20 stations)
C6C**

**VV5Z3-45FU-Station - C4C
C6C**

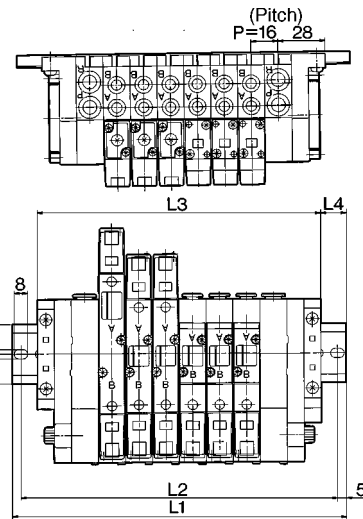
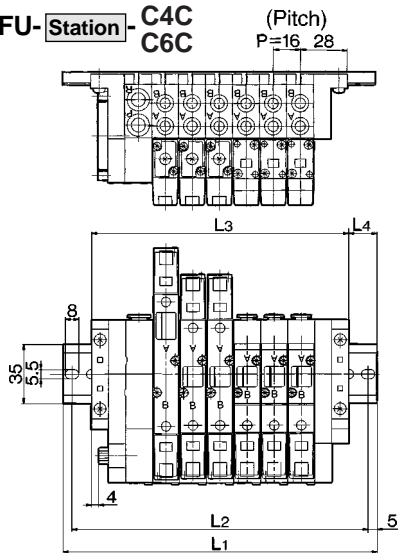

	(mm)									
Station	2	3	4	5	6	7	8	9	10	
L1	110.5	135.5	148	160.5	185.5	198	210.5	223	248	
L2	100	125	137.5	150	175	187.5	200	212.5	237.5	
L3	88	104	120	136	152	168	184	200	216	
L4	11.5	16	14	12.5	17	15	13.5	11.5	16	

	(mm)									
Station	2	3	4	5	6	7	8	9	10	
L1	135.5	148	160.5	185.5	198	210.5	223	248	260.5	
L2	125	137.5	150	175	187.5	200	212.5	237.5	250	
L3	104	120	136	152	168	184	200	216	232	
L4	16	14	12.5	17	15	13.5	11.5	16	14	

	(mm)										
Station	11	12	13	14	15	16	17	18	19	20	
L1	273	298	310.5	323	335.5	360.5	373	385.5	398	423	
L2	262.5	287.5	300	312.5	325	350	362.5	375	387.5	412.5	
L3	248	264	280	296	312	328	344	360	376	392	
L4	12.5	17	15.5	13.5	12	16.5	14.5	13	11	15.5	