

Diaphragm Type Pilot Operated 2 Port Solenoid Valve for High Pressure **VXH Series**

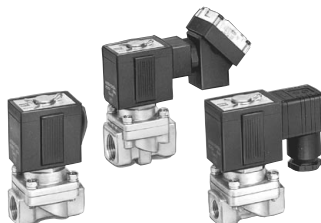

- Orifice diameter $\varnothing 10$
- Max. operating pressure: 2.0 MPa



Valve Specifications

| Port size | Orifice dia. (mm) | Min. operating pressure differential (MPa) | Max. operating pressure differential (MPa) | | | Flow rate characteristics | | | | | Max. system pressure (MPa) | Note) Weight (g) |
|-----------|-------------------|--|--|-----|-----|---------------------------|--------------|-----------------------------|------|-----|----------------------------|------------------|
| | | | Water | Air | Oil | Water, Oil, Steam | | Air | | | | |
| | | | | | | Kv | Cv converted | C[dm ³ /(s·bar)] | b | Cv | | |
| 1/4 | 10 | 0.05 | 2.0 | 2.0 | 1.5 | 1.6 | 1.9 | 8.5 | 0.35 | 2.0 | 2.0 | 550 |
| 3/8 | | | | | | 2.0 | 2.4 | 9.5 | 0.30 | 2.3 | | |
| 1/2 | | | | | | 2.0 | 2.4 | 9.5 | 0.30 | 2.3 | | |

Note) Weight of grommet type. Add 10 g for conduit type, 30 g for DIN terminal, 60 g for conduit terminal type respectively.
 • Refer to "Glossary of Terms" on page 309 for details of max. operating pressure differential and max. system pressure.

Solenoid Specifications

| Power source | Frequency (Hz) | Apparent power (VA) | | Power consumption (W) (Holding) | Temperature rise (°C) (Rated voltage) |
|--------------|----------------|---------------------|---------|---------------------------------|---------------------------------------|
| | | Inrush | Holding | | |
| AC | 50 | 53 | 18 | 7.5 | 60 |
| | 60 | 44 | 12 | 6 | 50 |

How to Order

Symbol

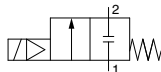

VXH2230 - 02 - 1 G - [] - [] - []

- 2 port valve for high pressure**
- Valve/Body**
0 Normally Closed/Single unit
- Port size**
02 Rc 1/4
03 Rc 3/8
04 Rc 1/2
- Rated voltage**
1 100 VAC 50/60 Hz
2 200 VAC 50/60 Hz
3 110 VAC 50/60 Hz
4 220 VAC 50/60 Hz
7 240 VAC 50/60 Hz
8 48 VAC 50/60 Hz
9 Other (Only AC)
- Electrical entry**
G Grommet
C Conduit
D DIN terminal
T Conduit terminal
* Refer to the table (1) given below for availability.
- CE-compliant**
Nil —
Q CE-compliant
* For DIN terminal only
- Bracket**
Nil None
B With bracket
- Electrical option**
Nil None
S With surge voltage suppressor
L With indicator light
Z With light/surge voltage suppressor
* Refer to the table (1) given below for availability.

Caution

Be sure to read this before handling the products.
 Refer to back page 50 for Safety Instructions and pages 17 to 19 for 2 Port Solenoid Valve for Fluid Control Precautions.

**Table (1)
Rated Voltage-
Electrical Entry-Electrical Option**

| Insulation type | Class B | | | | |
|-------------------|--------------------|---|---|---------|------|
| | Electrical entry | G | C | S, L, Z | D, T |
| Electrical option | S ^{Note)} | — | S | L | Z |
| AC | 1 (100 V) | ● | ● | ● | ● |
| | 2 (200 V) | ● | ● | ● | ● |
| | 3 (110 V) | ● | ● | ● | ● |
| | 4 (220 V) | ● | ● | ● | ● |
| | 7 (240 V) | ● | ● | ● | — |
| | 8 (48 V) | ● | ● | ● | — |

Note) Surge voltage suppressor is attached in the middle of lead wire.

Construction/Dimensions

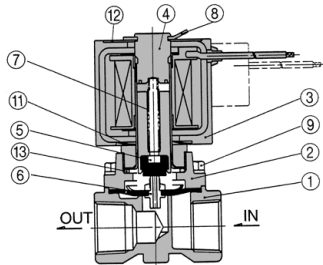

| No. | Description | Material | Note |
|-----|--------------------|----------------------|--------------------|
| 1 | Body | C37 | |
| 2 | Bonnet | C37 | |
| 3 | Coil assembly | Epoxy mold | Class B insulation |
| 4 | Core assembly | Stainless steel, Cu | |
| 5 | Armature assembly | Stainless steel, NBR | |
| 6 | Diaphragm assembly | Stainless steel, NBR | |
| 7 | Return spring | Stainless steel | |
| 8 | Retainer | Stainless steel | |
| 9 | Upset bolt | Stainless steel | |
| 10 | Bracket | SPC | Option |
| 11 | Wave washer | Stainless steel | |
| 12 | Name plate | AL | |
| 13 | O-ring | NBR | |
| 14 | Terminal assembly | — | |
| 15 | Seal | CR | |
| 16 | DIN terminal | — | |

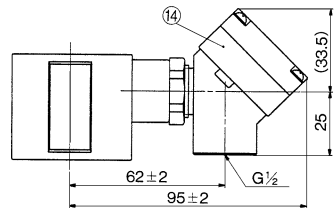
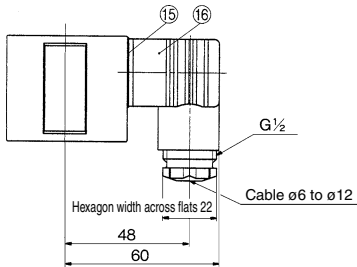

DIN terminal

Conduit terminal

