



**New XSA Series
Normally closed High Vacuum solenoid valve**

Improved features and related benefits

FEATURE: Power consumption is reduced up to 25%.

CUSTOMER BENEFIT: Energy cost savings.

FEATURE: More options available for AC voltage.

CUSTOMER BENEFIT: Easy ordering and product availability.

<i>Old XSA</i>	<i>New XSA</i>
100 V AC	100 V AC
	200 V AC
	110 V AV
	220 V AC
	240 V AC
	48 V AC
	24 V AC
	230 V AC

FEATURE: Increase temperature range (from 5 - 40°C to 5 – 60°C).



CUSTOMER BENEFIT: Stock reduction, since the same model can be used in more applications.

FEATURE: 6 mm orifice size is added to XSA size 2.

CUSTOMER BENEFIT: Space, weight and cost saving.

Technical details

Other specifications

			Old XSA	New XSA
Power consumption	DC	XSA1	6 W	4,5 W
		XSA2	8 W	7 W
		XSA3	11,5 W	10,5 W
	AC	XSA1	7 VA	7 VA
		XSA2	10 VA	9,5 VA
		XSA3	12 VA	12 VA
Weight		XSA1-*2S,V	0,3 Kg	0,28 Kg
		XSA2-*2S,V	0,5 Kg	0,41 Kg
		XSA3-32S,V	0,6 Kg	0,53 Kg
		XSA3-43S	0,6 Kg	0,55 Kg
		XSA3-43V	0,6 Kg	0,62 Kg
Electrical entry			Grommet	Grommet
			Conduit	Conduit *
			Terminal	Terminal *
			DIN connector	DIN connector *
				Faston terminal
Coil orientation			Rotatable	Non-rotatable
Image				
CE marking			Option (-Q)	Standard

 Different specifications

* Surge voltage suppressor is included as standard

Technical details

■ Dimensions

Face to face dimensions are maintained. Only valve height is changed.

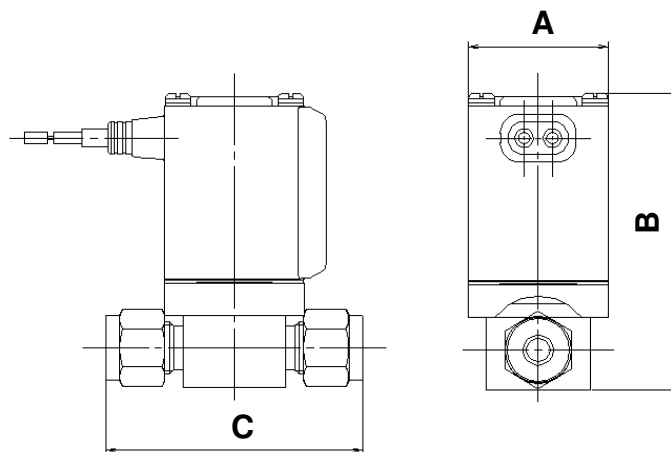

Different dimensions

		Old XSA	New XSA			Old XSA	New XSA
XSA1-*2S	A	30	30	XSA1-*2V	A	30	30
	B	64	63		B	64	63
	C	40	40		C	50	50
XSA2-*2S	A	35	35	XSA2-*2V	A	35	35
	B	75,5	73,5		B	75,5	73,5
	C	47,5	47,5		C	56	56
XSA3-32S	A	40	40	XSA3-32V	A	40	40
	B	82	78		B	82	78
	C	47,5	47,5		C	56	56
XSA3-43S	A	40	40	XSA3-43V	A	40	40
	B	82	78		B	82	82,5
	C	50	50		C	67	67