



SWITCHOVER DOCUMENT

PF2M7 Series

2-Colour Display Digital Flow Switch

Improved features and related benefits

Feature

- IO-Link compatibility

Customer Benefit

- Daily benefits that come from using IO-Link: Increased data availability, Product diagnosis, standard wiring, remote access, easy sensor replacement, tamper-free

Feature

- Low current consumption: 35 mA or less

Customer Benefit

- Cost savings



Feature

- Compact size with reduced weight

Customer Benefit

- Space-saving design
- Reduced machine/equipment size

Standard Specification

| | | |
|--------------------------|---|--|
| Model |  |  |
| Series | PFMB7201 | PF2M721 |
| Applicable fluid | Dry air, N ₂ , Ar, CO ₂ | Dry air, N ₂ , Ar, CO ₂ |
| Fluid temperature range | 0 to 50°C | 0 to 50°C |
| Rated flow range | 2 to 200 l/min | 2 to 200 l/min |
| Operating pressure range | 0 to 0.75 MPa | -0.1 to 0.75 MPa |
| Accuracy | +/-3% F.S. | +/-3% F.S./+/-1digit |
| Power Supply Voltage | 12 to 24 VDC +/- 10% | 12 to 24 VDC +/- 10% 18 to 30 VDC (IO-Link) |
| Consumption | 55 mA or less | 35 mA or less |
| Output type | Voltage output: 1 to 5 V Current output: 4 to 20 mA NPN/PNP External specification | Voltage output: 1 to 5 V (0 to 10 V can be selected) Current output: 4 to 20 mA NPN/PNP IO-Link |
| Delay time | - | 0 to 0.1s (0.01s increment, 0.1 to 1s (0.1s increment), 1 to 10s (1s increment), 20s, 30s, 40s, 50s, 60s |
| Display | 3 digit, 7 segment display Display colour: Red, green | LCD, red, green, 4 digits, 7 segment display (Reverse display) |
| Enclosure | IP40 | IP40 |
| Weight | 70 g | 48 g (straight type with one-touch fitting) |



Difference in specifications

Dimensions

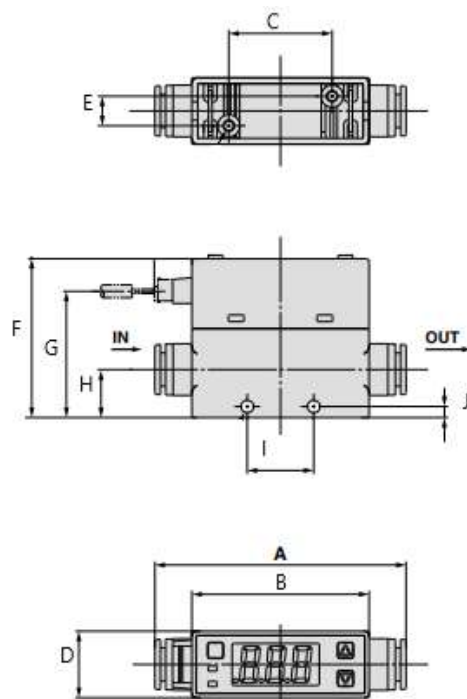

Actual PFMB7201

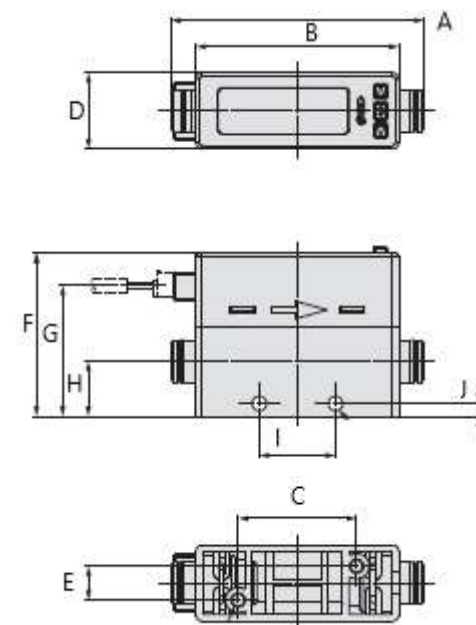
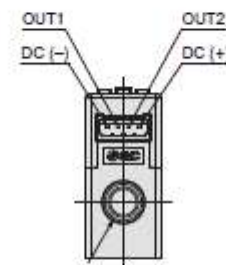
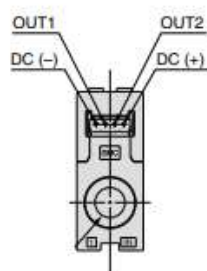

New PF2M721

| A | | B | | C | | D | | E | | F | | G | | H | |
|---------|-----|---------|-----|---------|-----|---------|-----|---------|-----|---------|------|---------|------|---------|-----|
| Current | New | Current | New | Current | New | Current | New | Current | New | Current | New | Current | New | Current | New |
| 68 | 68 | 48 | 48 | 28 | 28 | 18 | 18 | 8 | 8 | 44 | 39.9 | 34.2 | 30.9 | 13 | 13 |



Difference in specifications

Accessories

Brackets, panel mounts and lead wires

| | Current PFM | New PF2M |
|---|-------------|-----------|
| Bracket A (for use without flow adjustment valve) | ZS-33-M | ZS-33-M |
| Bracket B (for use with flow adjustment valve) | ZS-33-MS | ZS-33-MS |
| Panel mount adapter A (for use without flow adjustment valve) | ZS-33-J | ZS-33-2J |
| Panel mount adapter B (for use with flow adjustment valve) | ZS-33-JS | ZS-33-2JS |
| Lead wire with connector | ZS-33-D | ZS-33-D |
| Rubber cover for connector | ZS-33-F | ZS-33-F |