



## SWITCHOVER DOCUMENT

**PSE200A Series**  
3-Screen Display Multi-channel  
Digital Sensor Monitor

# Improved features and related benefits

## Feature

- Visualisation of settings
- 3-screen display. It can simultaneously display the current flow rate and another selectable value.

## Customer Benefit

- Item and set value are displayed together, making it easy to confirm the displayed item
- More information at a glance

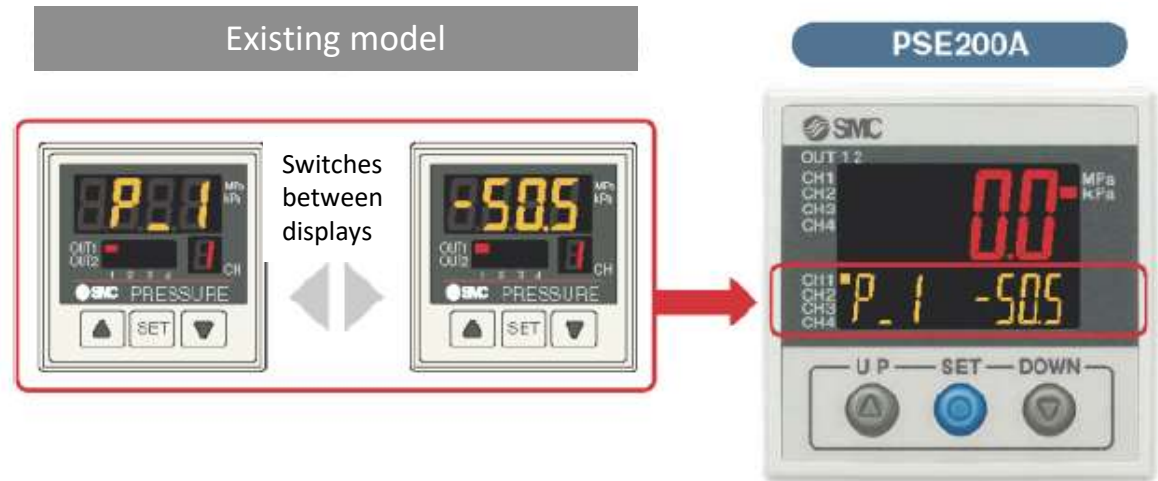
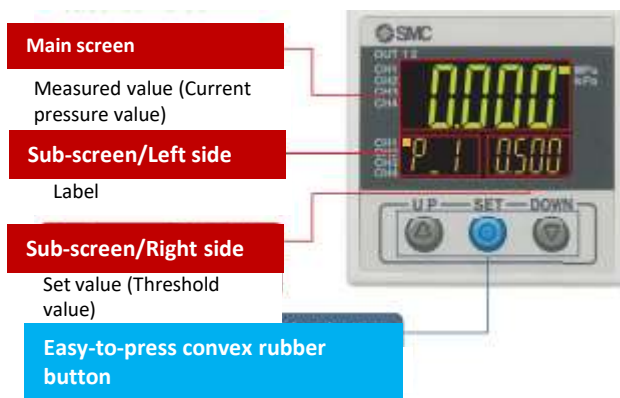

## Feature

- Simple 3-step setting.

## Customer Benefit

- User friendly, easy & quick setting.

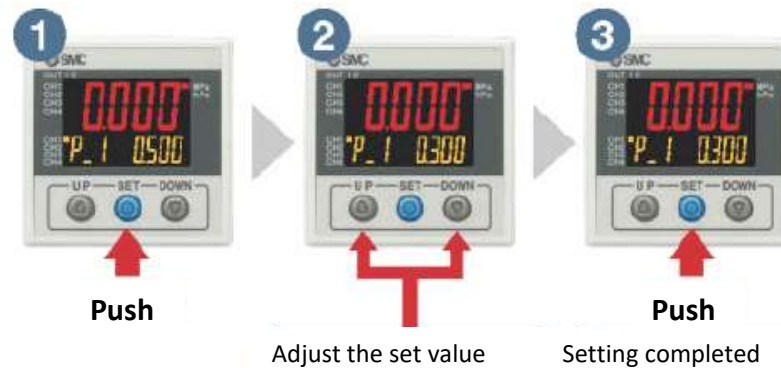

## Feature

- Possibility of changing the settings while checking the measured value.

## Customer Benefit

- Flexible configuration.

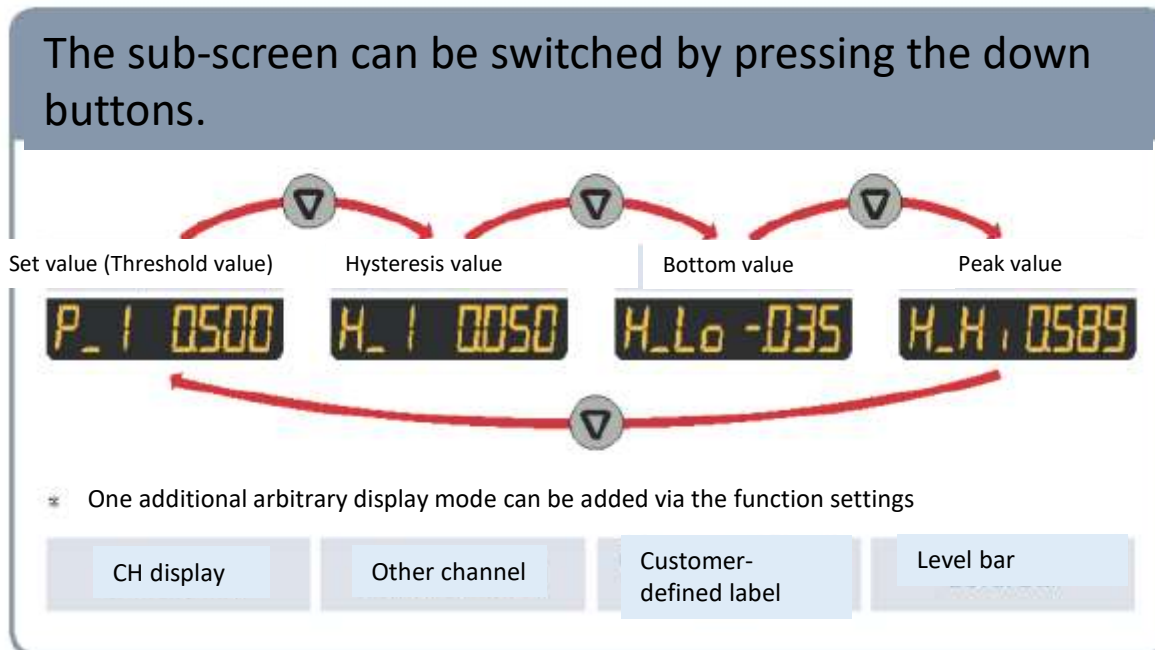

## Feature

- Differential pressure check mode as standard.

## Customer Benefit

- Smart FRL by remotely controlling filter clogging
- Preventive maintenance thanks to remote monitoring for elements replacement.

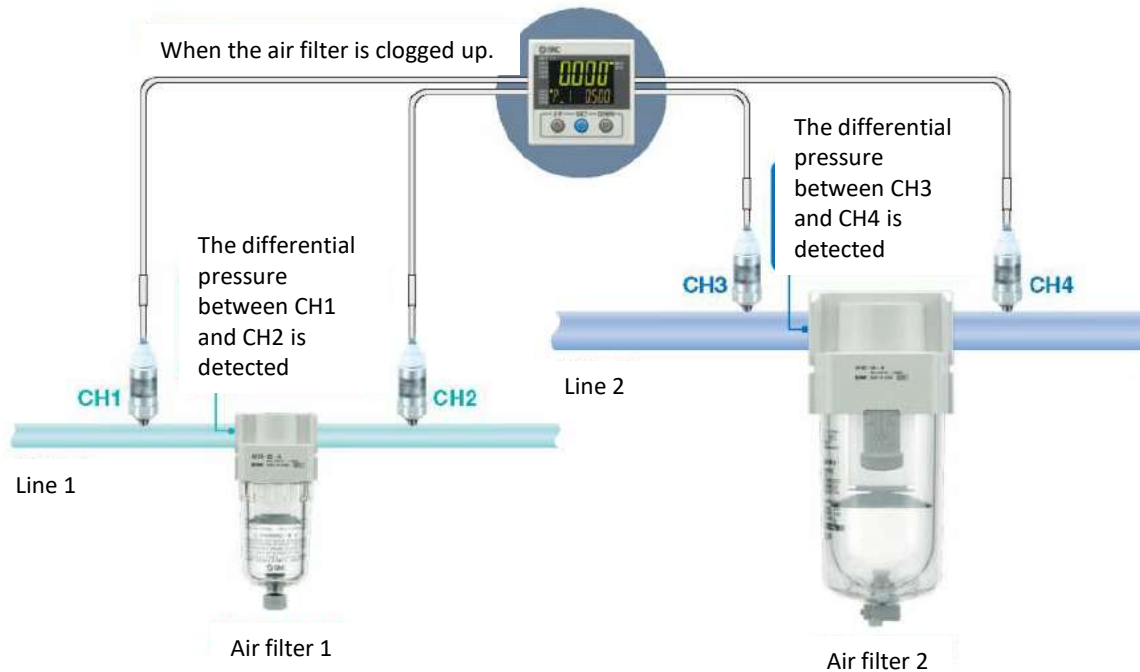

## Feature

- IO-Link compatibility.

## Customer Benefit

- Increased data availability, product diagnosis, standard wiring, remote access, easy sensor replacement, tamper-free
- Reduction of overall costs, increase of process efficiency and better machine availability.



## Feature

- Can be used as a hub between IO-Link master and sensors, converting analogue signals to digital signals.

## Customer Benefit

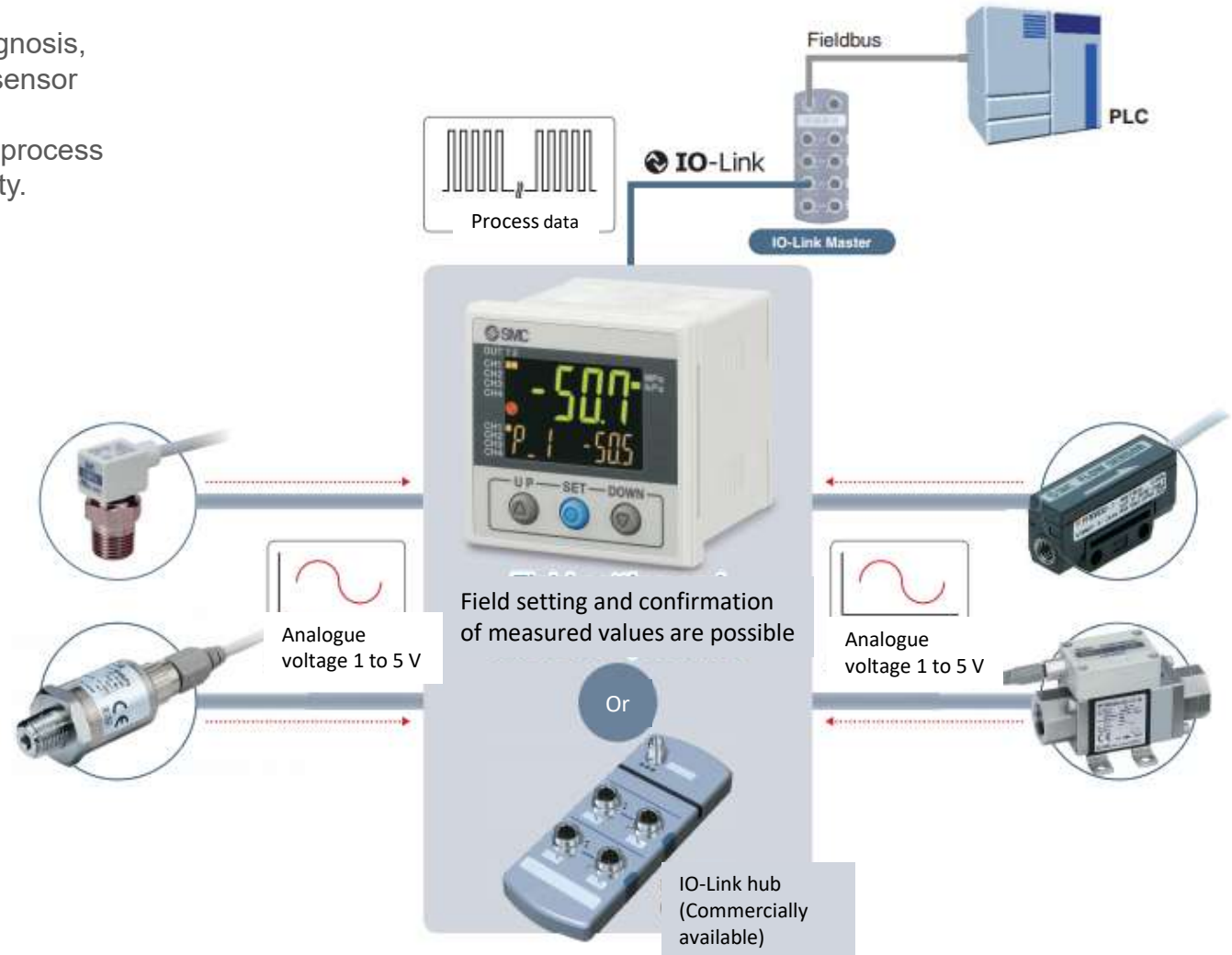
- Possibility of field setting and confirmation of measured values.



Series	Current PSE200	New PSE200A
Picture		
Power supply voltage	12 to 24 VDC $\pm$ 10 %, with 10 % ripple (p-p) or less	
Current consumption	55 mA or less	
Display accuracy	$\pm$ 0.5 % F.S. $\pm$ 1 digit (Ambient temperature of 25 °C $\pm$ 3 °C)	
Repeatability	$\pm$ 0.1 % F.S. $\pm$ 1 digit	
Temperature characteristics	$\pm$ 0.5 % F.S. (Reference: 25 °C)	
Output Specifications	NPN or PNP open collector output: 5 outputs	NPN or PNP open collector output: 5 outputs or IO-Link + NPN 4 outputs or NPN 5 outputs (SIO mode)
Delay time	5 ms or less (Response time selections with anti-chattering function: 20 ms, 160 ms, 640 ms)	5 ms or less, variable from 0 to 60 s/0.01 s increments
Hysteresis	Hysteresis: Variable from 0 Window comparator: Fixed (3 digits)	Variable from 0
Input type	Voltage input: 1 to 5 VDC (Input impedance: 800 k $\Omega$ )	Voltage input: 1 to 5 VDC (Input impedance: 1 M $\Omega$ )
Display	1-screen display (Main screen) + channel display, main screen: Orange, Channel display screen: Red	3-screen display (Main screen, sub-screen x 2), main screen: Red/Green, Sub-screen: Orange
Enclosure	Front side: IP65 (when panel-mounted), others: IP40	
Operating temperature range	Operating: 0 to 50 °C, stored: -10 to 60 °C (No condensation)	
Weight (Body)	60 g (Excludes power supply and output cable)	51 g (Excludes power supply and output cable)



Difference in specifications

## Dimensions

General dimensions

Old PSE200

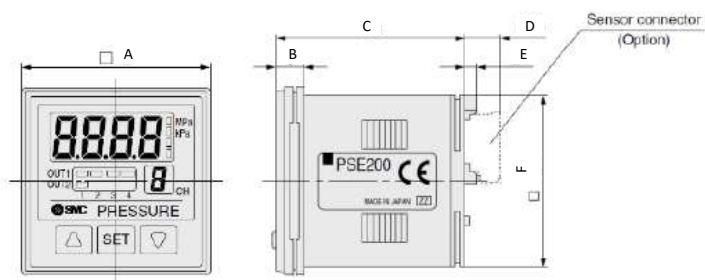

New PSE200A

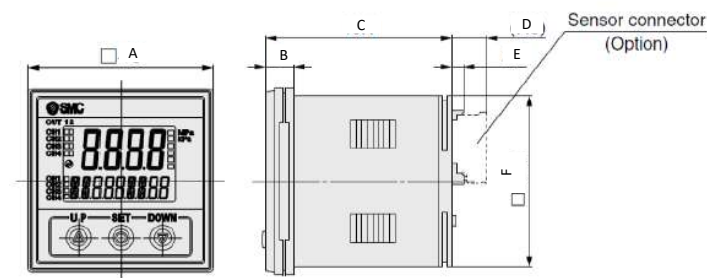

A		B		C		D		E		F	
Current	New	Current	New	Current	New	Current	New	Current	New	Current	New
40	40	6	6	40.1	40.1	7.5	7.5	2.5	2.5	36.8	36.8