



## SWITCHOVER DOCUMENT

### ZL112A Series Multistage ejector

## Improved features and related benefits

### Feature

- Lightweight body, reduced overall weight up to 180 g.
- Compact body, reduced overall width up to 33 mm.

### Customer Benefit

- Decreased load on moving parts of industrial robots. Lightweight machines.
- Downsized machines, slim multistage ejector design.



Current product

8 %  
width reduction  
(reduced by 3 mm)



60 %  
weight reduction  
(reduced by 270 g)



New product

## Feature

- Tools are not required for replacing the silencer and the air filter.

## Customer Benefit

- Reduced work hours for maintenance and inspection.

### Filter element

**STEP 1** Press the levers.

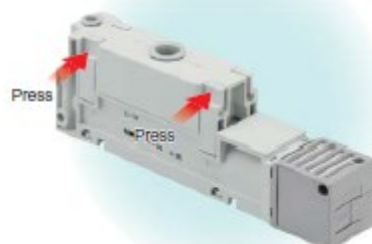

**STEP 2** Remove the suction cover.



**STEP 3** Replace the filter element.



### Sound absorbing material

**STEP 1** Press the PUSH button.



**STEP 2** Remove the silencer cover.

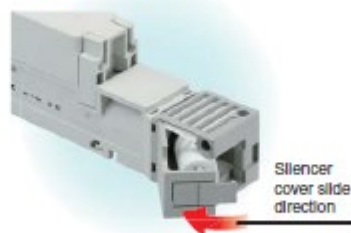

**STEP 3** Replace the sound absorbing material.

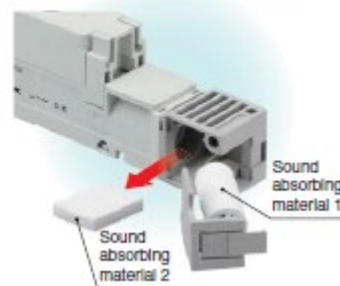

## Feature

- Reduced air consumption by reducing the supply pressure for peak vacuum pressure from 0.4 MPa (current value) to 0.33 MPa.
- Air consumption 57 l/min (current type 63 l/min).

## Customer Benefit

- Energy saving (approximately 10 %).

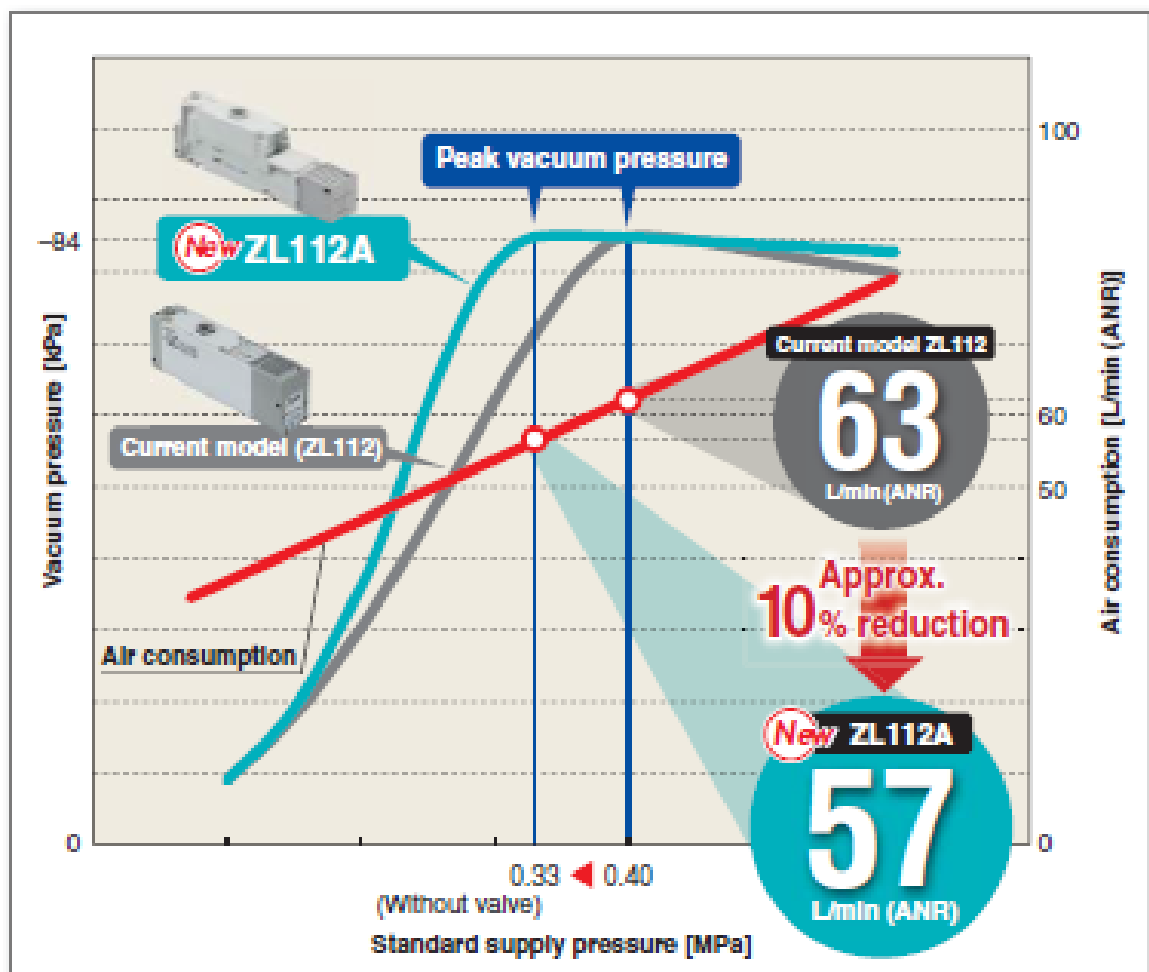

## Improved features and related benefits

### Feature

- More options for supply valve/release valve combination available:
  - Supply valve (N.C.), Release valve (N.C.)
  - Supply valve (N.C.)
  - Supply valve (N.O.), Release valve (N.C.)
  - Supply valve (N.O.)

### Customer Benefit

- Flexibility to use in many different applications.

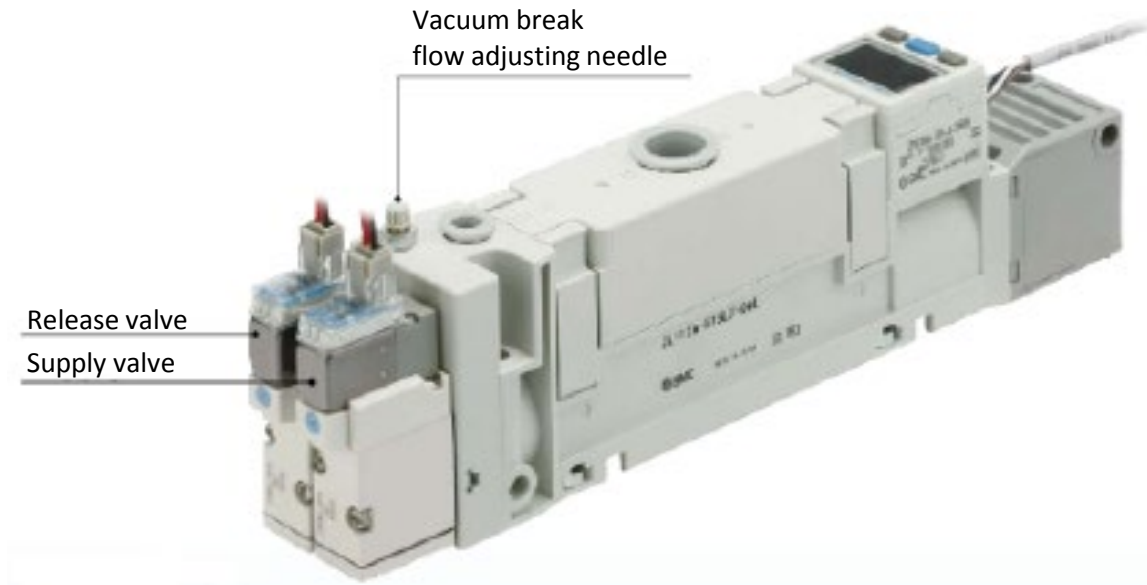

## Interchangeability

- Mounting is interchangeable with the current model (adapter assembly is required for bottom mounting).

Current product



New product



Mounting hole diameter is changed from  $\varnothing 5.4$  to  $\varnothing 5.3$



Mounting hole diameter is changed from  $\varnothing 5.4$  to  $\varnothing 5.3$

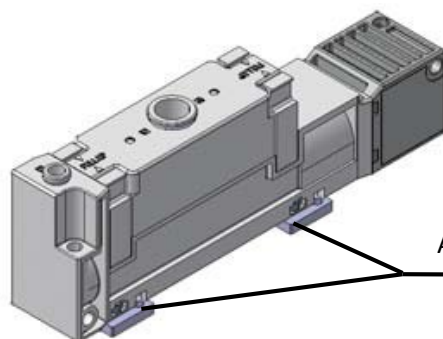

Adapter assembly for bottom porting

## Interchangeability

- Mounting dimensions are interchangeable

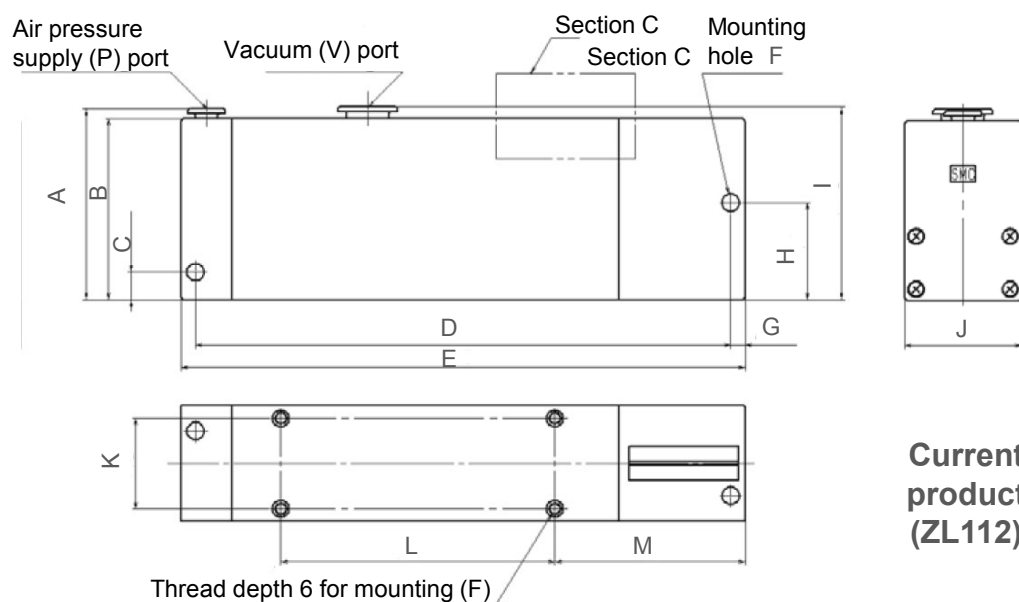

**Current product (ZL112)**

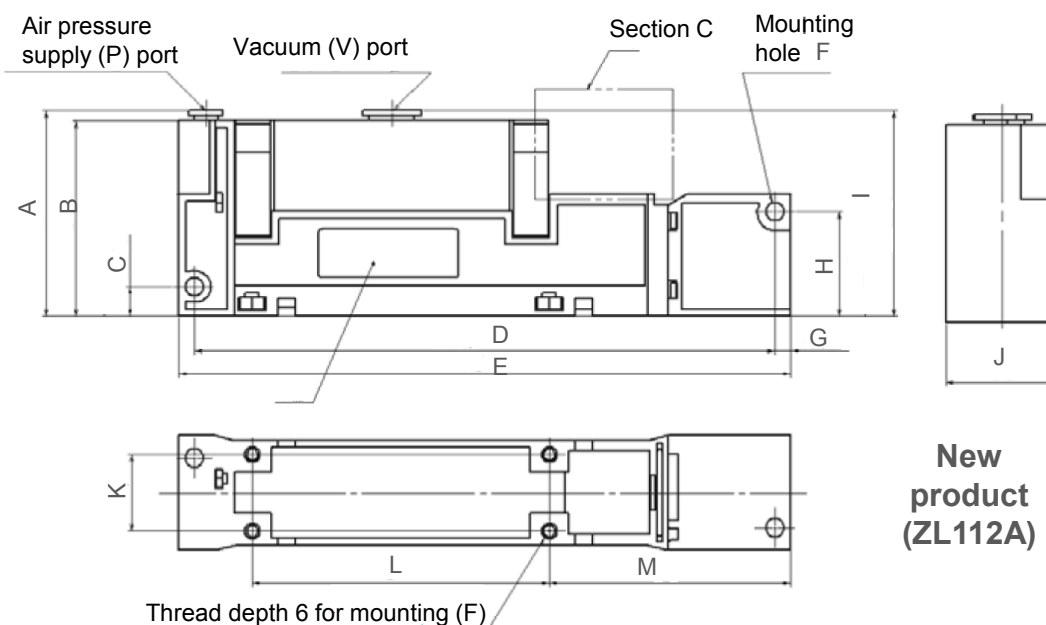

**New product (ZL112A)**

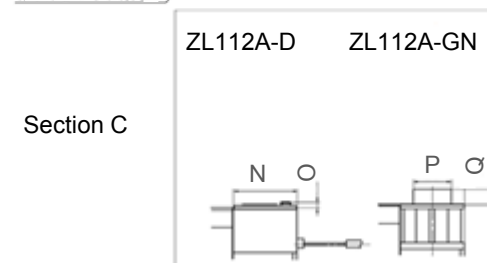
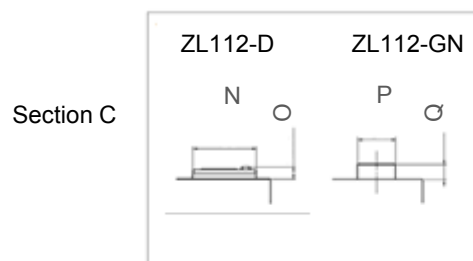

[mm]	A		B		C		D		E		F		G		H		I	
Model	OLD	NEW	OLD	NEW	OLD	NEW	OLD	NEW	OLD	NEW	OLD	NEW	OLD	NEW	OLD	NEW	OLD	NEW
ZL112A	59	59	56	56	8.5	8.5	166	166	175	175	2 x Ø5.4	2 x Ø5.3	4.5	4.5	30	30	59.5	58.9
[mm]	J		K		L		M		N		O		P		Q			
Model	OLD	NEW	OLD	NEW	OLD	NEW	OLD	NEW	OLD	NEW	OLD	NEW	OLD	NEW	OLD	NEW		
ZL112A	36	33	28	22	85	85	59	69	30	30	5.8	3	18	18	7	7		

Difference in specifications

## Interchangeability

- Mounting dimensions are interchangeable

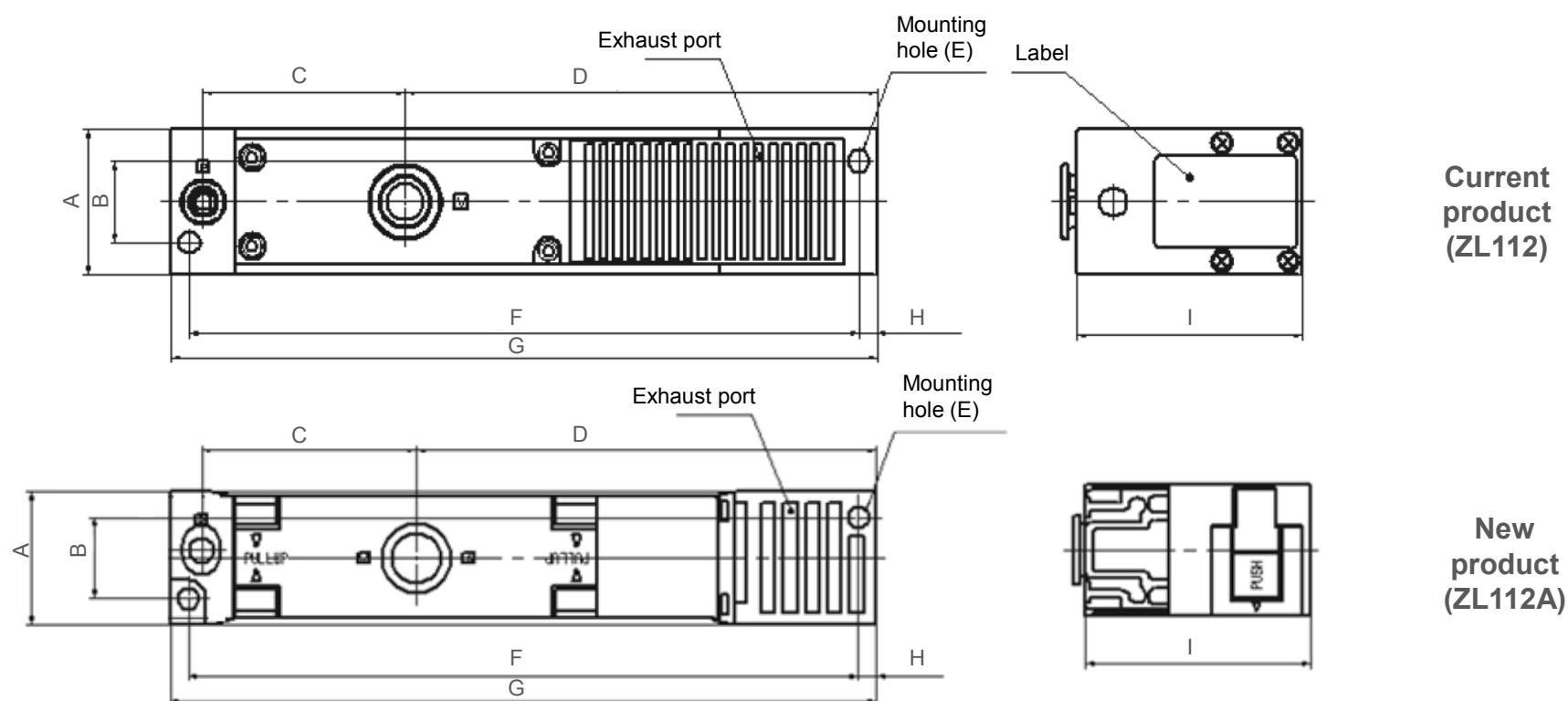

[mm]	A		B		C		D		E		F		G		H		I	
Model	OLD	NEW	OLD	NEW	OLD	NEW	OLD	NEW	OLD	NEW	OLD	NEW	OLD	NEW	OLD	NEW	OLD	NEW
ZL112A	36	33	20	20	50	53.2	117	114	2 x Ø5.4	2 x Ø5.3	166	166	175	175	4.5	4.5	56	56

Difference in specifications

## Interchangeability

- Mounting dimensions are interchangeable

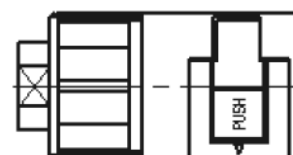
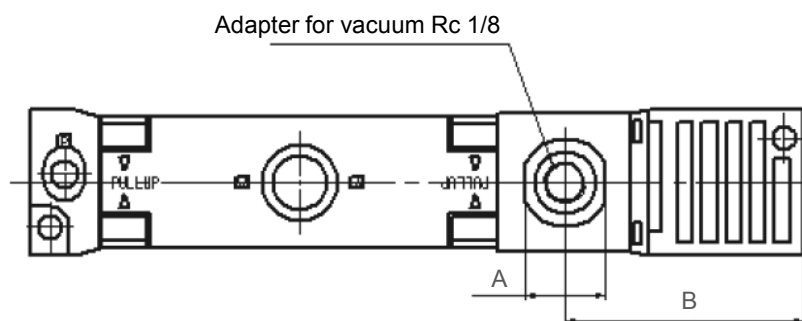

**Current  
product  
(ZL112-GN)**

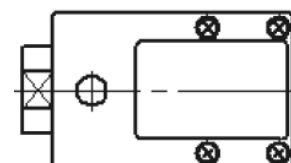
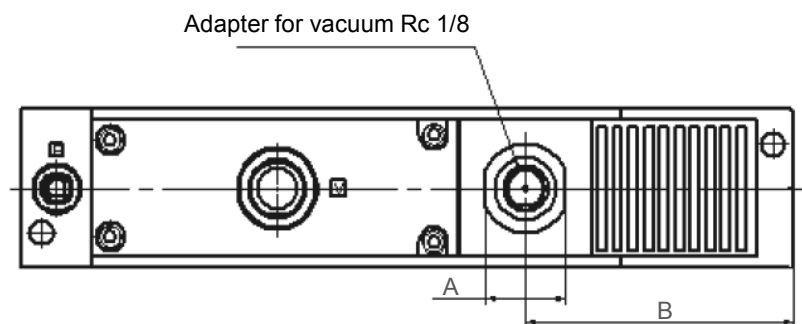

**New product  
(ZL112A-GN)**

[mm]	A		B	
Model	OLD	NEW	OLD	NEW
ZL112A	18	18	61	54

 Difference in specifications

## Interchangeability

- Mounting dimensions are interchangeable

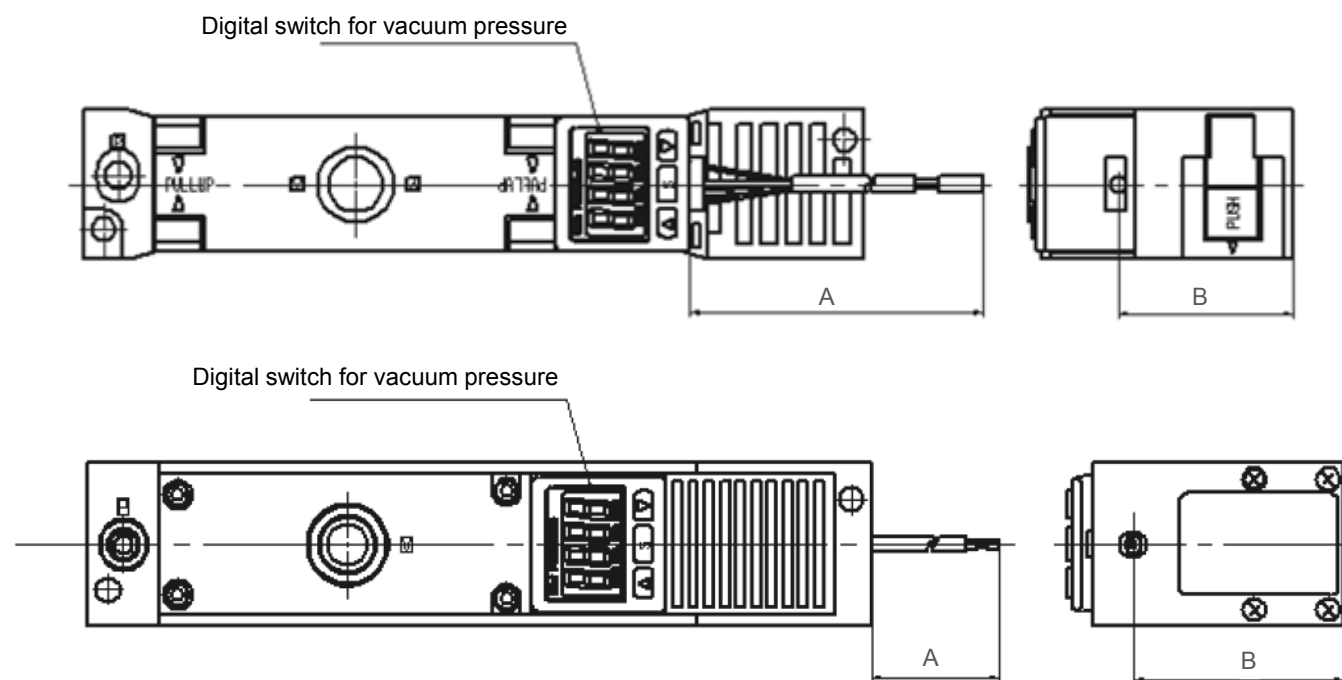

Current product  
(ZL112-D)

New product  
(ZL112A-D)

[mm]	A		B	
Model	OLD	NEW	OLD	NEW
ZL112A	1900	2000	47	39

 Difference in specifications

## Standard specifications

- Static neutralisation characteristics are the same as the existing product.

	ZL112	ZL112A
Fluid	Air	Air
Nozzle diameter	1.2 mm	1.2 mm
Standard supply pressure	0.4 MPa	Without valve: 0.33 MPa With valve: 0.35 MPa
Maximum vacuum pressure *	-84 kPa	-84 kPa
Air consumption *	63 l/min (ANR)	57 l/min (ANR)
Maximum suction flow rate *	100 l/min (ANR)	100 l/min (ANR)
Supply pressure range	0.2 to 0.5 MPa	0.2 to 0.5 MPa
Operating temperature range	5 to 50 °C	5 to 50 °C (No condensation)
Weight	450 g	180 g
Vibration resistance	30 m/s <sup>2</sup>	30 m/s <sup>2</sup> (Without pressure switch), 20 m/s <sup>2</sup> (With pressure switch)
Impact resistance	150 m/s <sup>2</sup>	150 m/s <sup>2</sup> (Without pressure switch), 100 m/s <sup>2</sup> (With pressure switch)

\* Values are at the standard supply pressure and based on SMC's measurement standards.  
They depend on atmospheric pressure (weather, altitude, etc.) and the measurement method.

 Difference in specifications